

# 25,200 SF

## Industrial Space For Lease



## Prologis Beacon At 97<sup>th</sup> 200

2000 NW 97<sup>th</sup> Avenue  
Doral, FL 33172 USA

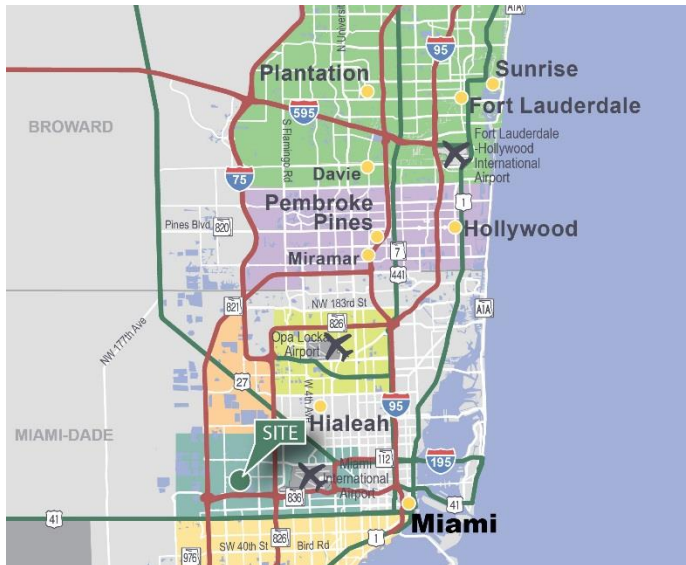

### LOCATION

- Located in the heart of Doral
- Master planned business park
- Immediate access to 836 (Dolphin expressway), 826 (Palmetto expressway), and Florida's Turnpike
- 3.5 miles to Miami International Airport
- 11 miles to Port of Miami

### FACILITY

- 25,200 total s.f. available
- 2,520 s.f. office
- 22,680 s.f. warehouse
- 24' clear height
- 7 dock high doors, 1 drive-in door
- 0' x 30' column spacing
- 210' building depth
- 1.38/1,000 s.f. parking ratio
- IU-C zoning
- [Click here to learn more](#)

### ADVANTAGES AND AMENITIES

- Class A business park
- Power: 3 phase, 277/480V; 3 ph 4 wire
- Fully fire sprinklered, Class 4 system
- High security location – fully fenced with 24 hour monitoring and controlled access
- Fast, cost-effective forklift and racking sourcing through Prologis Essentials

# 25,200 SF

## Industrial Space For Lease

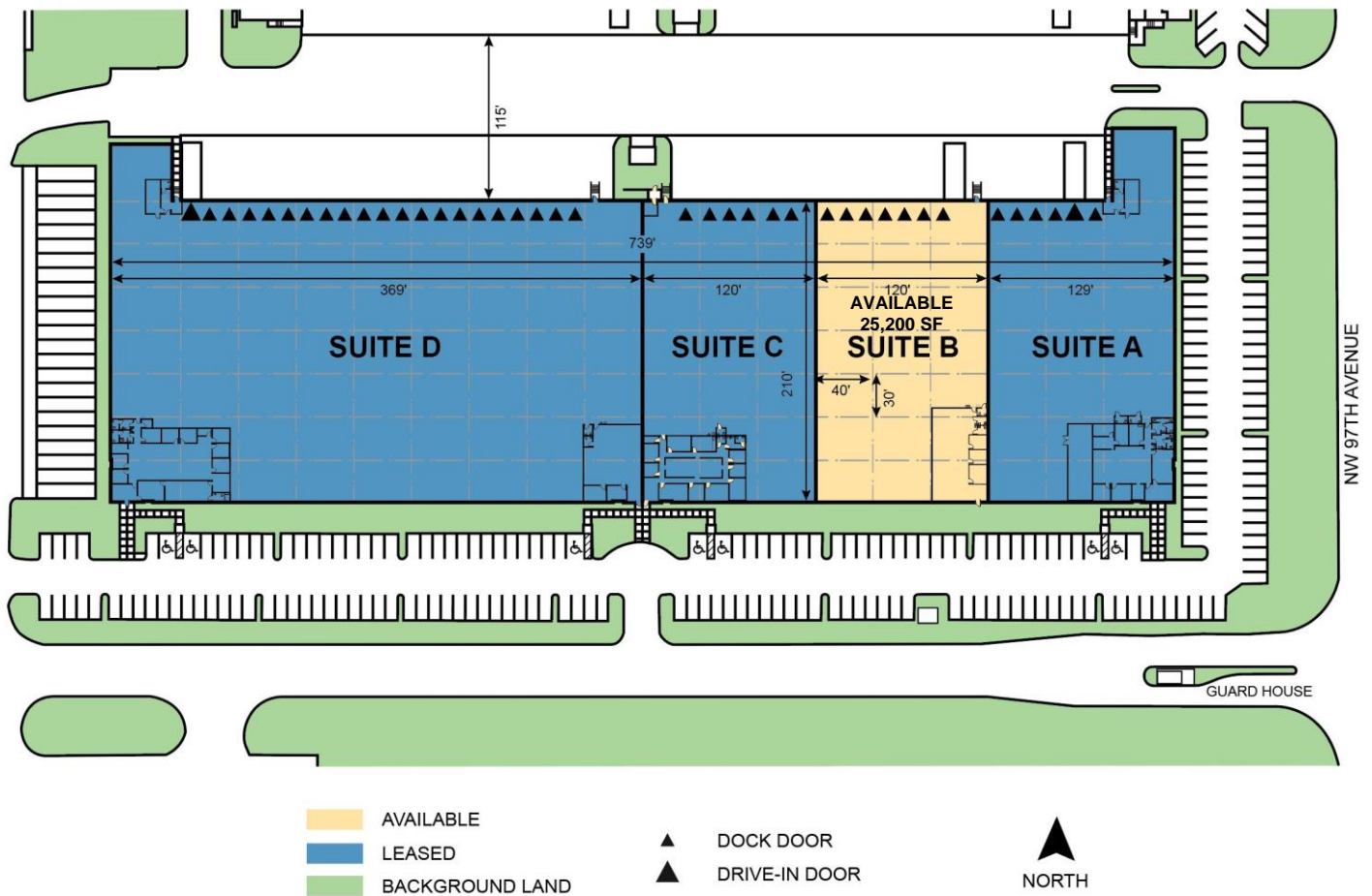

JLL

**Brian Smith**  
smith.brian@am.jll.com  
ph +1 305 960 8403  
cell +1 305 710 2291  
200 S. Biscayne Blvd.  
Suite 4300  
Miami, FL 33131 USA

JLL

**Audley Bosch**  
audley.bosch@am.jll.com  
ph +1 305 960 8404  
cell +1 305 742 8421  
200 S. Biscayne Blvd.  
Suite 4300  
Miami, FL 33131 USA

JLL

**Matt Maciag**  
matt.maciag@am.jll.com  
ph +1 305 960 8409  
cell +1 305 978 1530  
200 S. Biscayne Blvd.  
Suite 4300  
Miami, FL 33131 USA

Prologis

**Barbara Mantecon**  
bmantecon@prologis.com  
ph +1 954 316 1777  
8355 NW 12<sup>th</sup> Street  
Miami, FL 33126 USA