

# 72,722 SF

Industrial Space For Lease



## Prologis Northgate 21



10665 Sanden Drive, Suite 140  
Dallas, TX 75238 USA

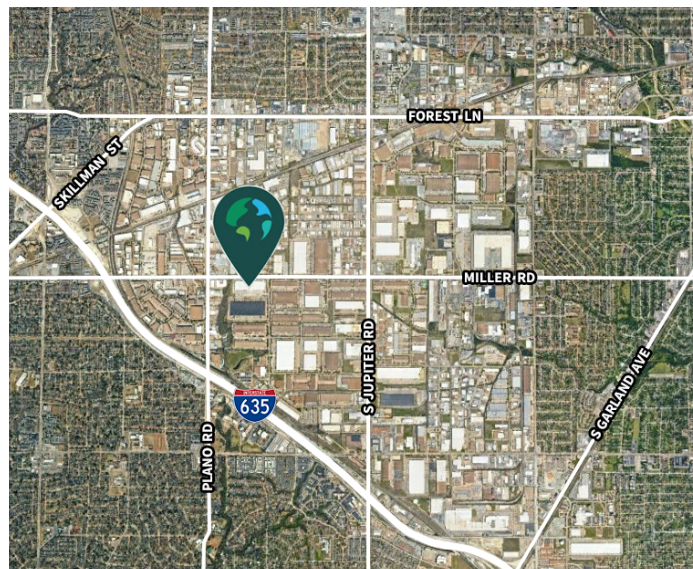

### LOCATION

- Located in the Northeast Dallas/Garland submarket
- Easy access to I-635 via Miller Road
- Miller Road frontage

### FACILITY

- 72,722 sf available
- 4,184 sf office
- 30' clear height
- 55' x 52' typical bay spacing
- 15 (9' x 10') overhead dock doors, 14 with levelers
- 2 (9' x 10') overhead dock doors with ramp
- ESFR sprinkler system

### ADVANTAGES AND AMENITIES

- Access to the [Prologis Essentials](#) platform, which includes:
  - [Operations Essentials](#)
  - [Energy + Sustainability Essentials](#)
  - [Mobility Essentials](#)
  - [Workforce Essentials](#)

**Prologis Essentials: your single-source service for efficient move-in and operations at [prologisessentials.com](https://prologisessentials.com)**

# 72,722 SF

Industrial Space For Lease



## Prologis Northgate 21

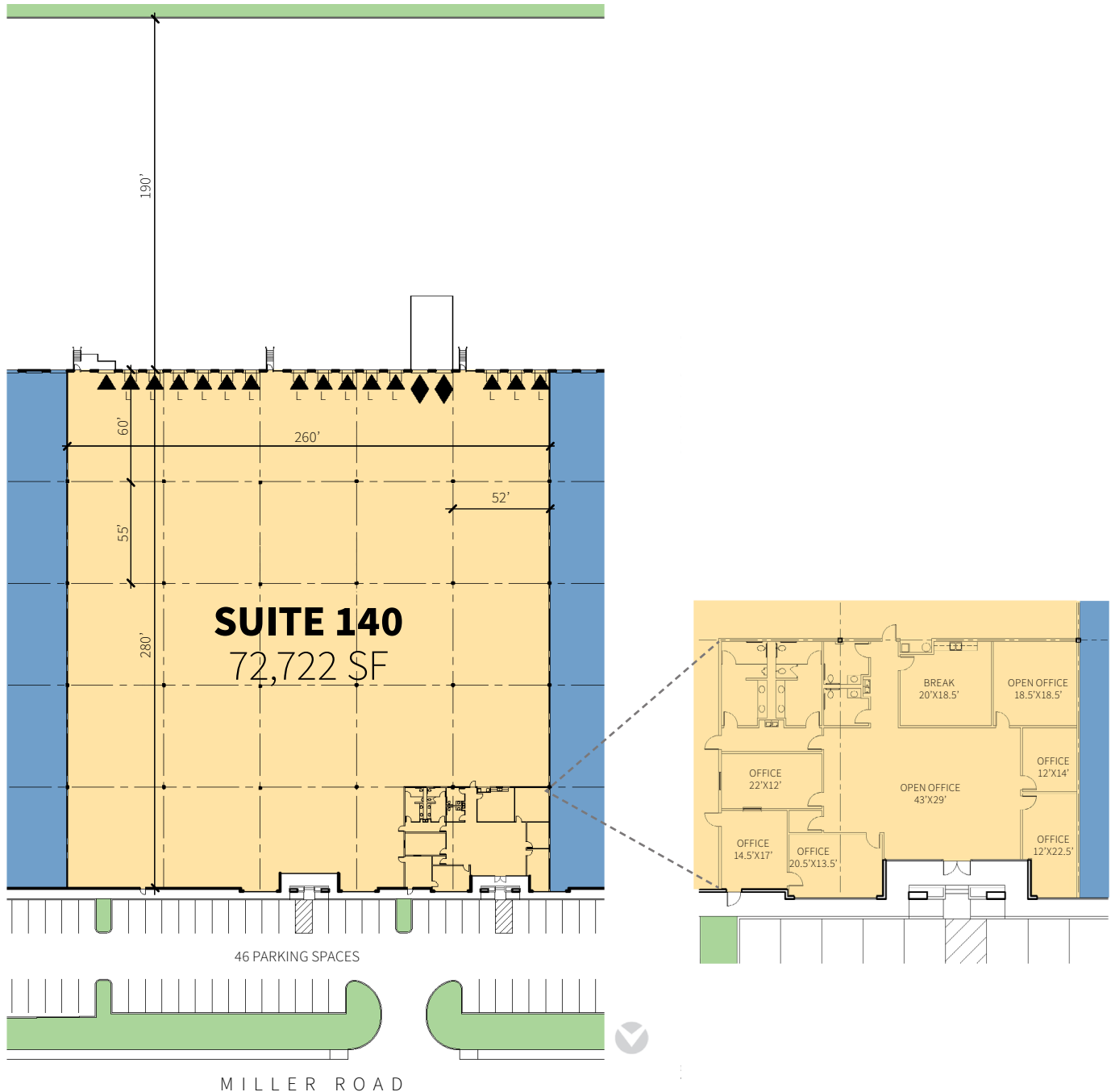

### NAI Robert Lynn

Stephen Cooper, SIOR  
scooper@nairl.com  
ph +1 214 256 7160  
cell +1 214 497 0730  
4851 LBJ Freeway  
10<sup>th</sup> Floor  
Dallas, TX 75244 USA

### Prologis

Kathleen Isola  
kisola@prologis.com  
ph +1 972 884 9202  
cell +1 214 709 1405  
2021 McKinney Avenue  
Suite 1050  
Dallas, TX 75201 USA