

# 16,445 SF

Industrial/Flex Space For Lease



## Prologis Park Chicago



9820 Foster Avenue  
Chicago, IL 60656 USA

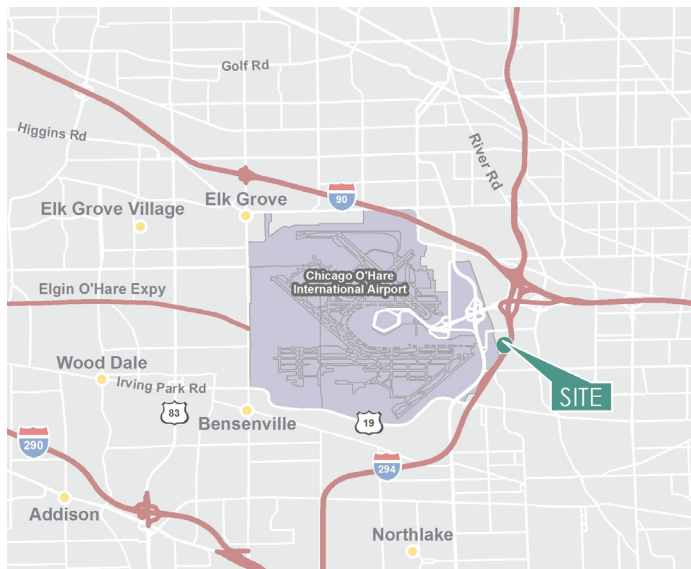

### LOCATION

- Conveniently located next to O'Hare International Airport.
- Next to new northbound 294 Balmoral exit & southbound entrance.
- Excellent access to I-294, I-90, I-290 and I-390.

### FACILITY

- 26,111 sf building
- 16,445 sf available
- 2,994 sf of office area
- 900 sf of mezzanine storage (not in footprint)
- 400 amp service
- 24 parking stalls
- 18' clear height
- 1 interior dock with leveler, 1 drive-in door
- 39 x 30 - typical bay

### ADVANTAGES AND AMENITIES

- Ample private office space, training rooms and an employee break room.
- Walking distance to Rosemont's Entertainment District.

**Your single-source service for efficient move-in and operations: [prologisessentials.com](http://prologisessentials.com)**

# 16,445 SF

Industrial/Flex Space For Lease



## Prologis Park Chicago

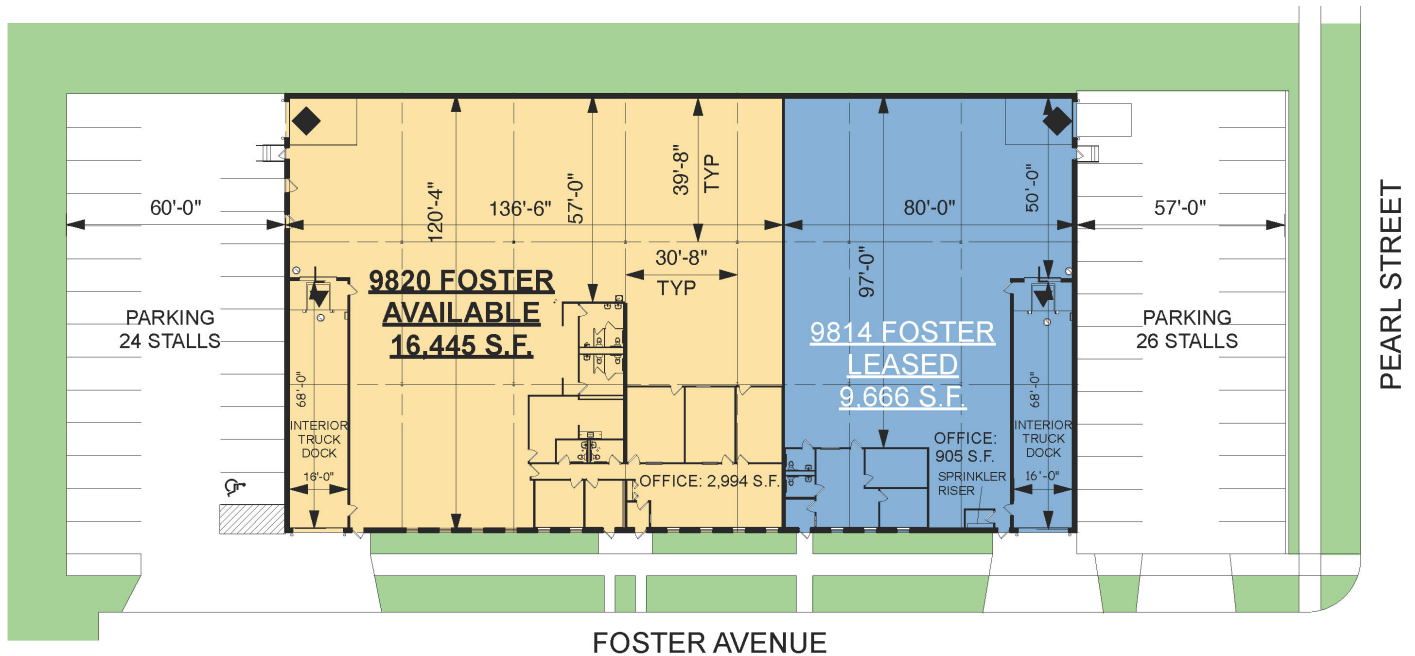

## NEWMARK

### Newmark

Tom Gath  
thomas.gath@nrmk.com  
ph +1 773 957 1415  
cell +1 847 942 9438  
8750 W. Bryn Mawr  
Suite 350  
Chicago, IL 60631 USA

### Prologis

Ana Rovito  
arovito@prologis.com  
ph +1 847 292 3850  
cell +1 312 420 4426  
6250 North River Road  
Suite 1100  
Rosemont, IL 60018 USA