

# 85,424 SF

Industrial Space For Lease



## Prologis Beacon Industrial Park 7



3200 NW 112<sup>th</sup> Avenue  
Doral, FL 33172 USA

### LOCATION

- Easy access to Miami International Airport and Port Miami
- Direct access to 836 (Dolphin Expressway), with easy access to 826 (Palmetto Expressway), and Florida's Turnpike

### FACILITY

- ±85,424 SF available; inclusive of ±12,155 SF of office
- Free standing building
- 24' Clear height
- 11 Dock doors; inclusive of 1 ramp
- Column spacing 42.5' X 30' / Building depth 208'-10"
- Front loading
- Private and secured truck court
- Available May 2023

### ADVANTAGES AND AMENITIES

- Beacon Industrial Park is a premier business park located within the Airport West / Doral submarket.
- Nearby amenities include numerous restaurants, hotels, banks and shopping centers.
- Prologis Clear Lease® – Know your lease expenses and capital cost with greater certainty before your sign.

**Your single-source service for efficient move-in and operations: [prologisessentials.com](https://www.prologisessentials.com)**

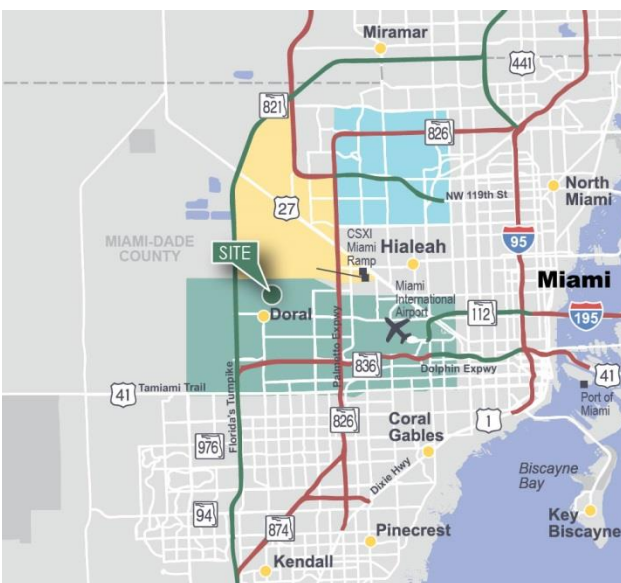

Scan the QR code for more info!

# 85,424 SF

Industrial Space For Lease



## Prologis Beacon Industrial Park 7

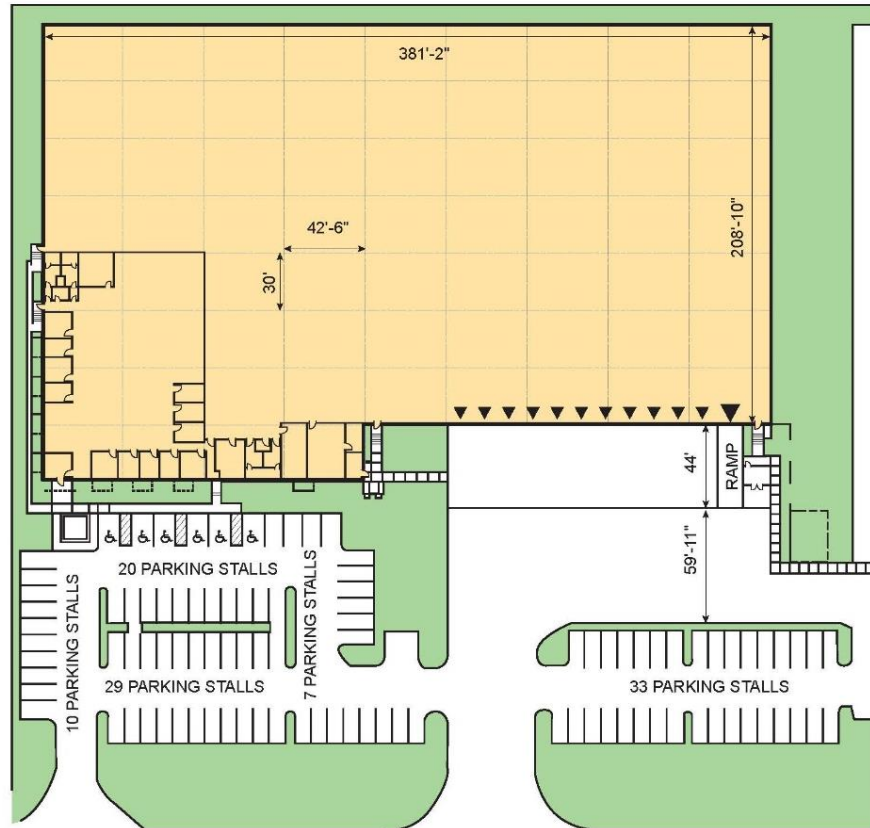

- AVAILABLE AREA
- LEASED AREA
- BACKGROUND LAND

- DOCK DOOR
- DRIVE-IN DOOR



### State Street Realty

George Pino, SIOR  
gpino@statestreetre.com  
ph +1 305 447 3390  
cell +1 786 402 7387  
8319 NW 12 Street  
Doral, FL 33126 USA

### State Street Realty

Brian Cabiellas, SIOR  
bcabiellas@statestreetre.com  
ph +1 305 447 3390  
cell +1 305 606 7109  
8319 NW 12 Street  
Doral, FL 33126 USA

### Prologis

Barbara Mantecon  
bmantecon@prologis.com  
ph +1 954 316 1777  
8355 NW 12 Street  
Doral, FL 33126 USA