

# 43,200 SF

Industrial Space For Lease



## Northwest Corporate Park - Kent 11



20608 87th Ave S  
Kent, WA 98031 USA

### LOCATION

- 50-yard line location
- Great access to Hwy 167, I-5, and I-405

### FACILITY

- 43,200 SF total
- 2,780 SF office
- 10 DH doors
- 1 GL door
- Rail served
- 22' clear height
- Available Q2 2022

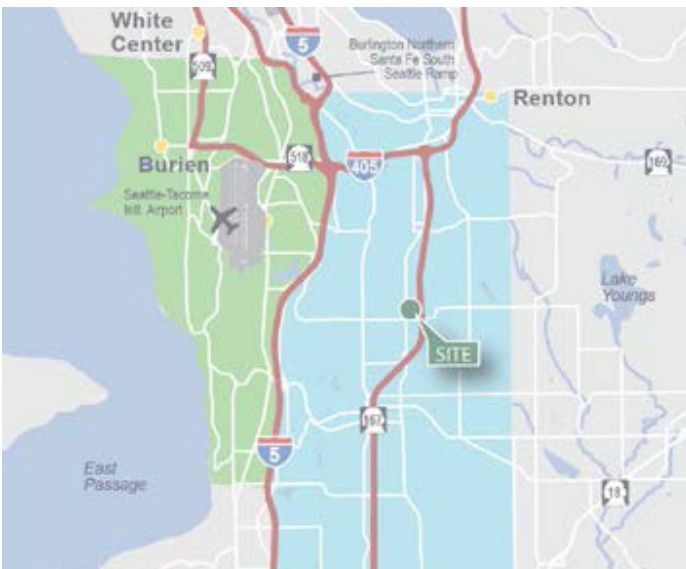

**Prologis Essentials: your single-source service for efficient move-in and operations at [prologisessentials.com](https://www.prologisessentials.com)**

[www.prologis.com](https://www.prologis.com)

# 43,200 SF

Industrial Space For Lease



## Northwest Corporate Park - Kent 11

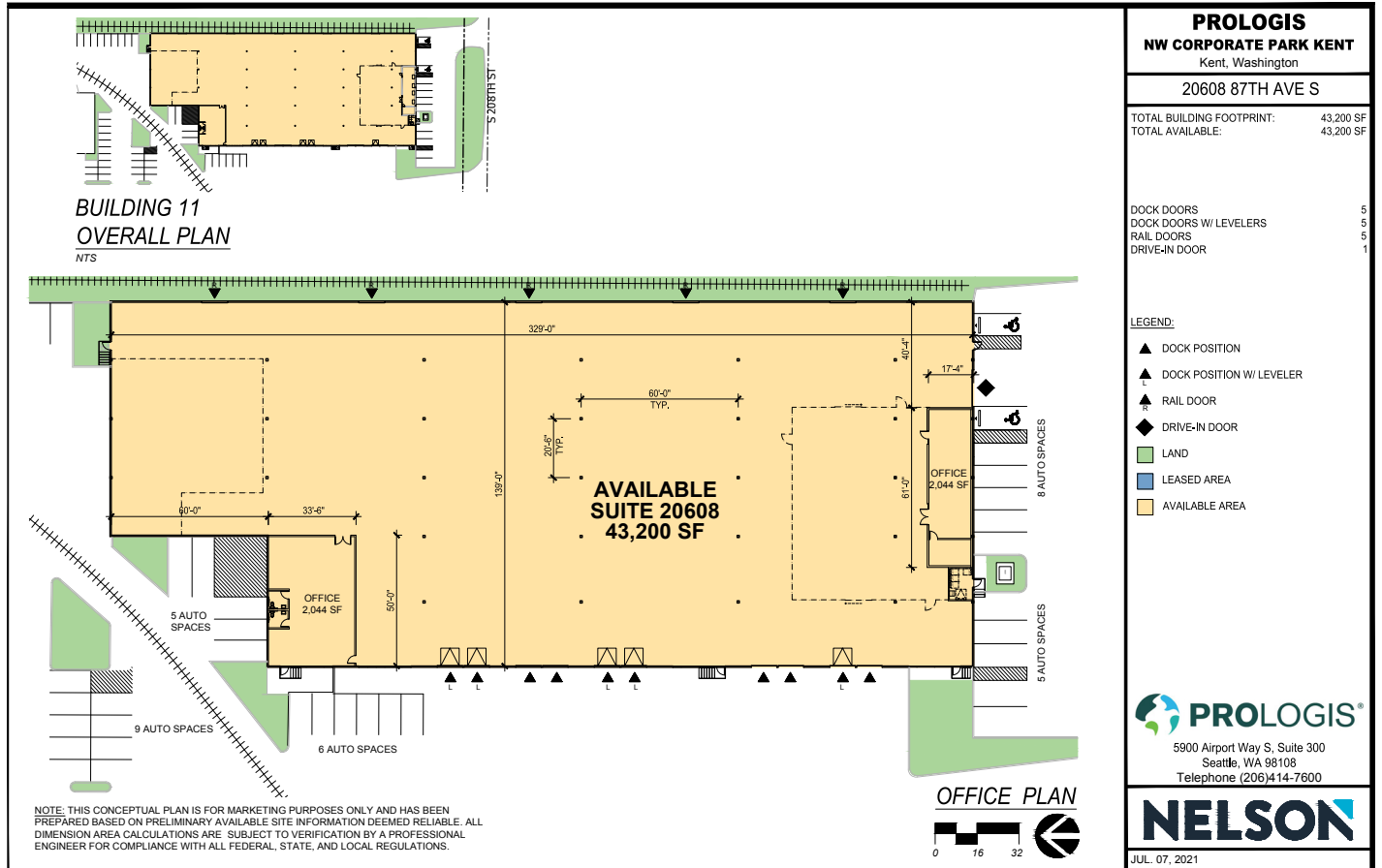

**KBC Advisors**

Matt Wood, SIOR  
matt.wood@kbcadvisors.com  
ph +1 206 741 1030  
cell +1 206 595 6814  
5628 Airport Way S  
Suite 238  
Seattle, WA 98108 USA

**KBC Advisors**

Hans Vieser  
hans.vieser@kbcadvisors.com  
ph +1 206 741 1030  
cell +1 425 765 7926  
5628 Airport Way S  
Suite 238  
Seattle, WA 98108 USA

**Prologis**

Kimberley Nemethy  
knemethy@prologis.com  
ph +1 206 414 7616  
cell +1 253 508 1737  
5900 Airport Way South  
Suite 300  
Seattle, WA 98108 USA

**Prologis Essentials: your single-source service for efficient move-in and operations at [prologisessentials.com](http://prologisessentials.com)**

No warranty or representation, expressed or implied, is made as to the accuracy of the information contained herein, and same is submitted subject to error and omissions.