

48,100 SF

Industrial Space For Lease



Prologis Great Southwest

3709 E. Randol Mill Road, Suite 200
Arlington, Texas 76011 USA

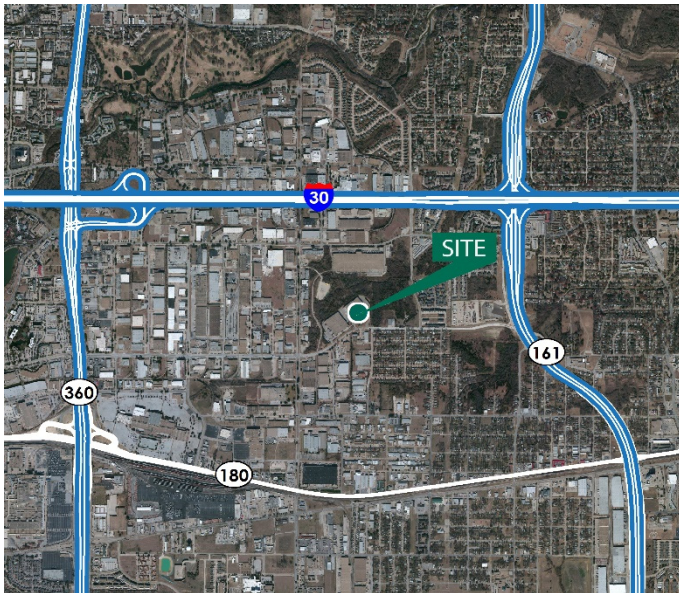

LOCATION

- Situated in the highly desirable Great Southwest industrial submarket
- Excellent access to major thoroughfares (I-30, SH-360, and TX-161)

FACILITY

- 48,100 sf available
- 4,660 sf office
- 28' clear height
- ESFR sprinkler system
- 10 (9' x 10') overhead dock doors, 8 with mechanical pit levelers
- 1 (12' x 14') concrete drive in ramp door
- 40' x 40' typical column spacing
- 200' shared truck court
- LED lighting (30 fc avg @ 30" aff)
- ___ amps of power

ADVANTAGES AND AMENITIES

- Triple freeport tax exemption status
- Front load configuration
- End cap space with 66 striped vehicle parking spaces

48,100 SF

Industrial Space For Lease

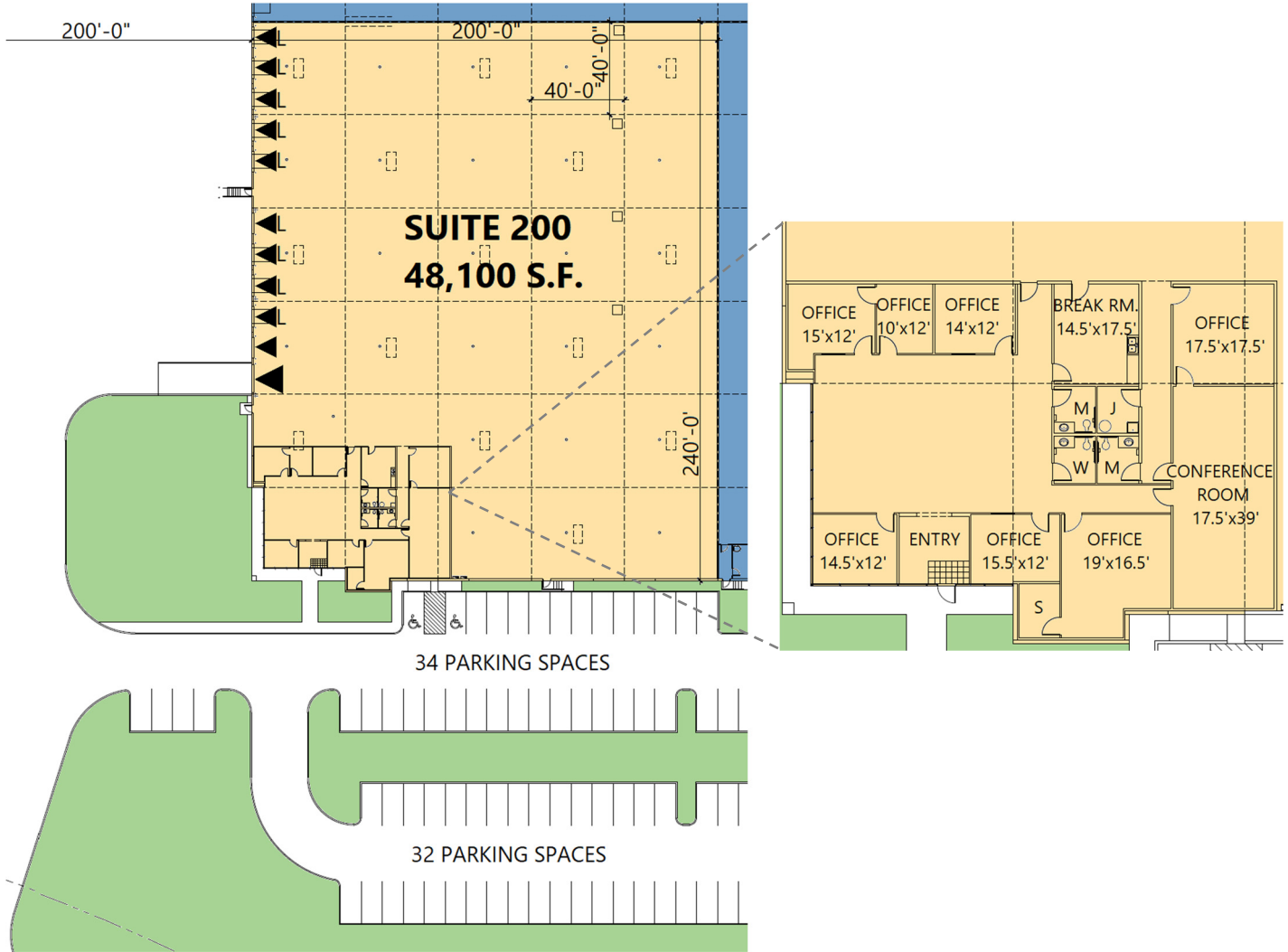

CBRE
Steve Kolydke
steve.kolydke@cbre.com
ph +1 817 987 4404
cell +1 214 850 4963
2100 McKinney Avenue
Suite 700
Dallas, TX 75201 USA

CBRE
Brian Gilchrist
brian.gilchrist@cbre.com
ph +1 214 979 6394
cell +1 817 907 1774
2100 McKinney Avenue
Suite 700
Dallas, TX 75201 USA

CBRE
Kacy Jones
kacy.jones@cbre.com
ph +1 214 979 6151
cell +1 214 923 0056
301 Commerce Street
Suite 3131
Fort Worth, TX 76102 USA

Prologis
Ryan McNaughton
rmcnaughton@prologis.com
ph +1 972 884 9218
cell +1 214 673 9489
2021 McKinney Avenue
Suite 1050
Dallas, TX 75201 USA