

11,353 SF

Industrial Space For Lease



Prologis Beacon Centre 14



2250 NW 84th Avenue
Doral, FL 33126 USA

LOCATION

- Easy access to Miami International Airport and Port Miami
- Direct access to 836 (Dolphin Expressway), with easy access to 826 (Palmetto Expressway), and Florida's Turnpike



FACILITY

- ±11,353 SF available; inclusive of ±5,310 SF of office
- 24' Clear height
- 2 Dock door; inclusive of 1 ramp
- Column spacing 40' X 40'
- Front loading / Shared truck court
- Available January 2023
- [Click here to learn more](#)

ADVANTAGES AND AMENITIES

- Beacon Centre is a 205 acre secured master-planned business park located in the heart of the Airport West /Doral submarket.
- Prologis Clear Lease® – Know your lease expenses and capital cost with greater certainty before your sign.
- Nearby amenities include numerous restaurants, hotels, banks and shopping centers.
- Fast cost-effective forklift and racking sourcing through Prologis Essentials.

Prologis Essentials: your single-source service for efficient move-in and operations at [prologisessentials.com](https://www.prologisessentials.com)

11,353 SF

Industrial Space For Lease



Prologis Beacon Centre 14

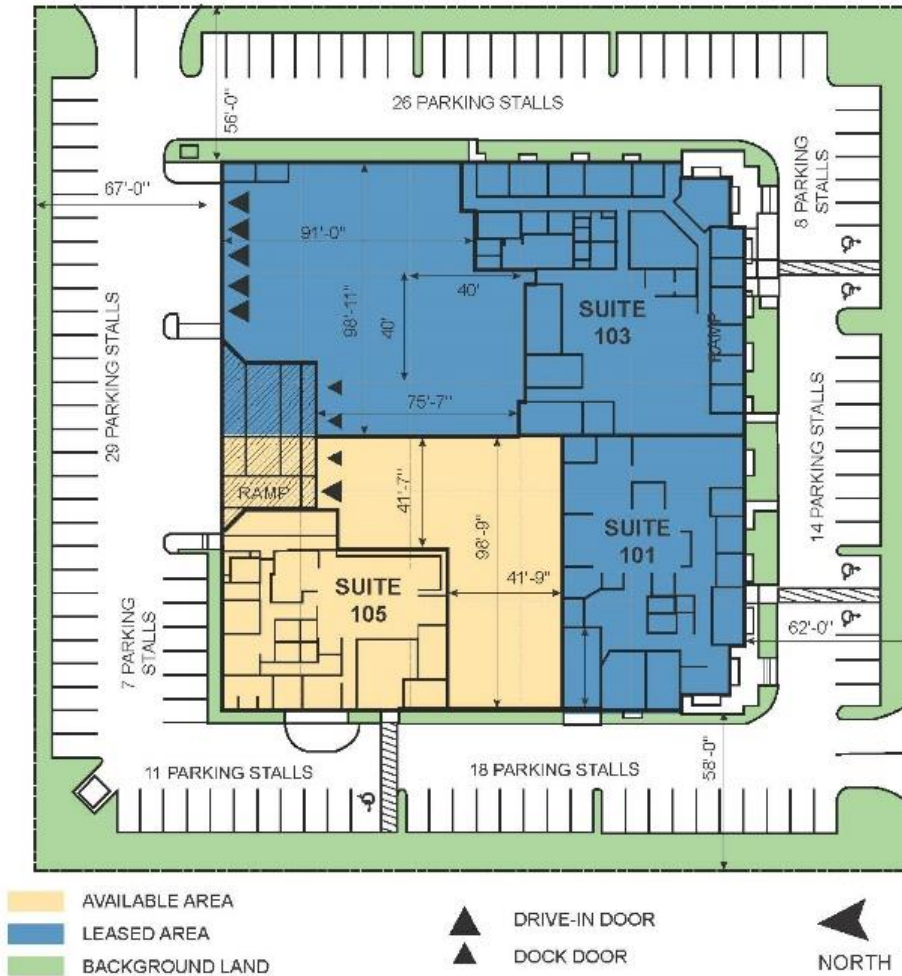

State Street Realty

George Pino, SIOR
gpino@statestreetre.com
ph +1 305 447 3390
cell +1 786 402 7387
8319 NW 12 Street
Doral, FL 33126 USA

State Street Realty

Brian Cabiellas, SIOR Member Associate
bcabiellas@statestreetre.com
ph +1 305 447 3390
cell +1 305 606 7109
8319 NW 12 Street
Doral, FL 33126 USA

Prologis

Adriana Duque
aduque@prologis.com
ph +1 305 392 4272
8355 NW 12 Street
Doral, FL 33126 USA

Prologis Essentials: your single-source service for efficient move-in and operations at prologisessentials.com

No warranty or representation, expressed or implied, is made as to the accuracy of the information contained herein, and same is submitted subject to error and omissions.