

# 67,339 SF

Industrial Space For Lease



## Prologis Crossroads



601 Gills Drive  
Orlando, FL 32824 USA

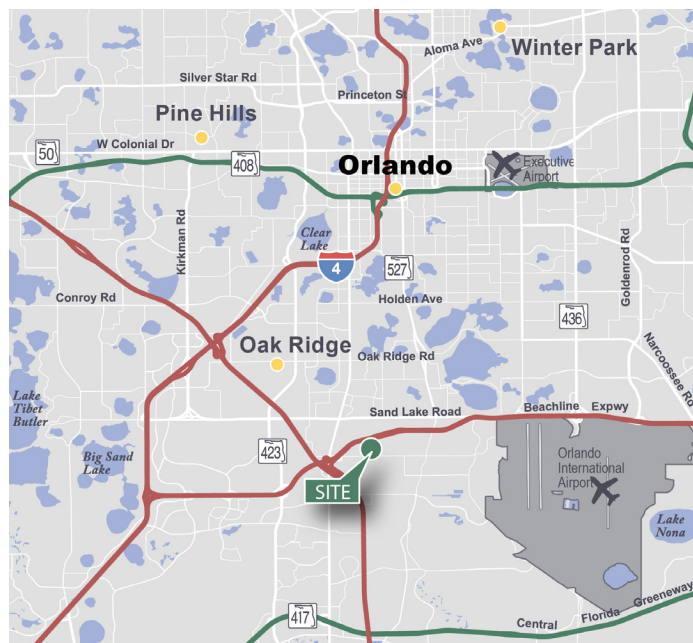

### LOCATION

- Just south of the Beachline Expressway (SR 528) and immediately adjacent to Orlando International Airport
- Excellent access to Florida's Turnpike, Sand Lake Road, Orange Avenue and Orange Blossom Trail (US 441)

### FACILITY

- 187,513 SF building
- Cross dock
- 30' clear height
- 354' building depth
- 40' x 50' column spacing (typical)
- 137' & 138' truck courts
- .75 / 1,000 SF parking
- ESFR sprinkler system
- Secured, outside storage available

### SUITE 100

- 67,339 SF available
- 1,025 SF of office
- 14 dock doors
- Two oversized drive-in doors

**Your single-source service for efficient move-in and operations: [prologisessentials.com](http://prologisessentials.com)**

# 67,339 SF

Industrial Space For Lease



## Prologis Crossroads

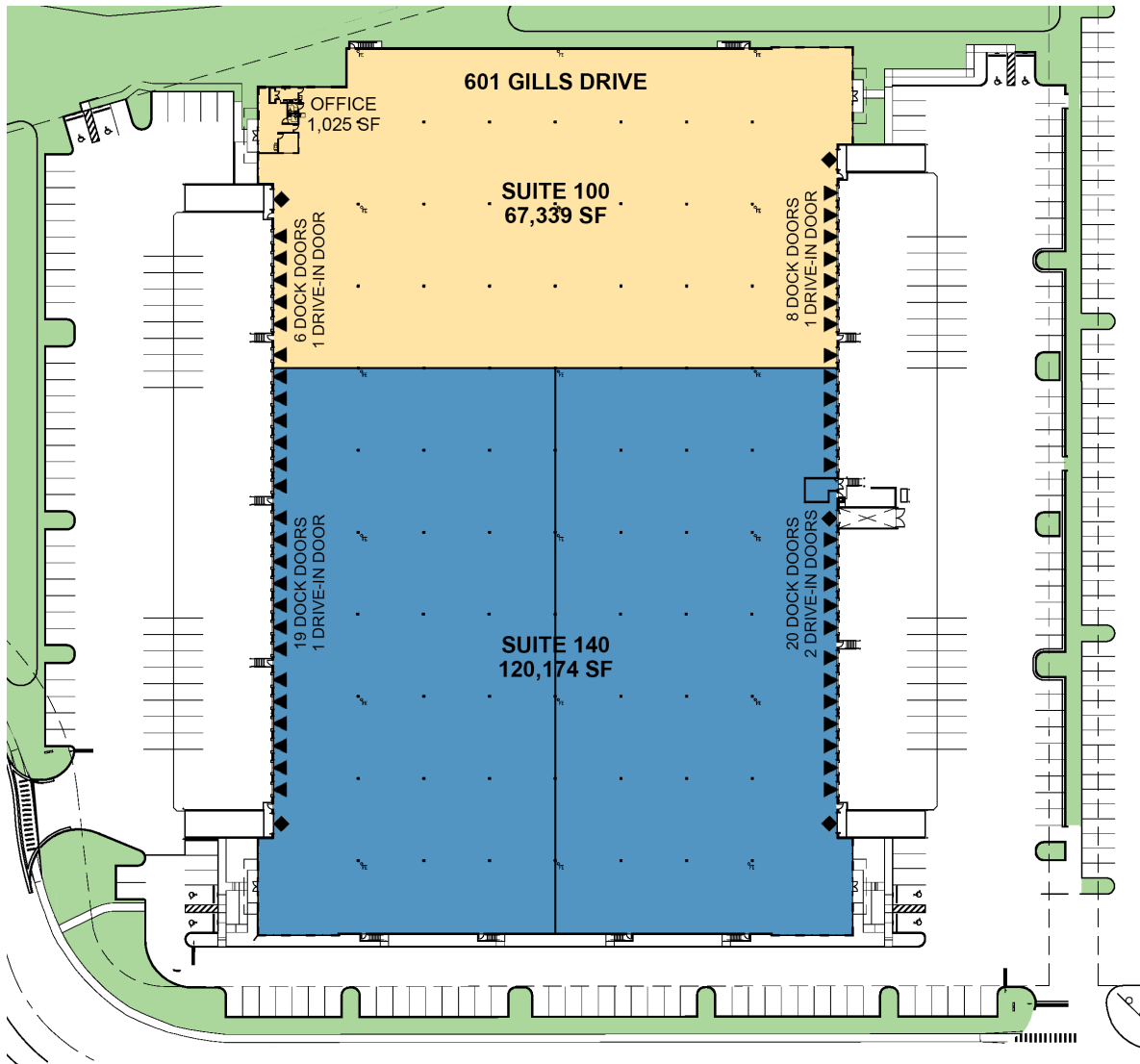

### LEGEND

- AVAILABLE
- LEASED
- DOCK DOOR
- DRIVE-IN DOOR



COMMERCIAL REAL ESTATE SERVICES

#### Lee & Associates

Tim Perry, SIOR, CCIM  
tperry@lee-associates.com  
+1 321.281.8515 phone  
1017 E. South Street  
Orlando, FL 32801 USA

#### Lee & Associates

William "Bo" Bradford, SIOR, CCIM  
bbradford@lee-associates.com  
+1 321.281.8502 phone  
1017 E. South Street  
Orlando, FL 32801 USA