

# 63,600 SF

## Industrial Space For Lease



## Prologis Park Trans-Pacific

2105 Frank Albert Rd, Building 10  
Fife, WA 98424 USA

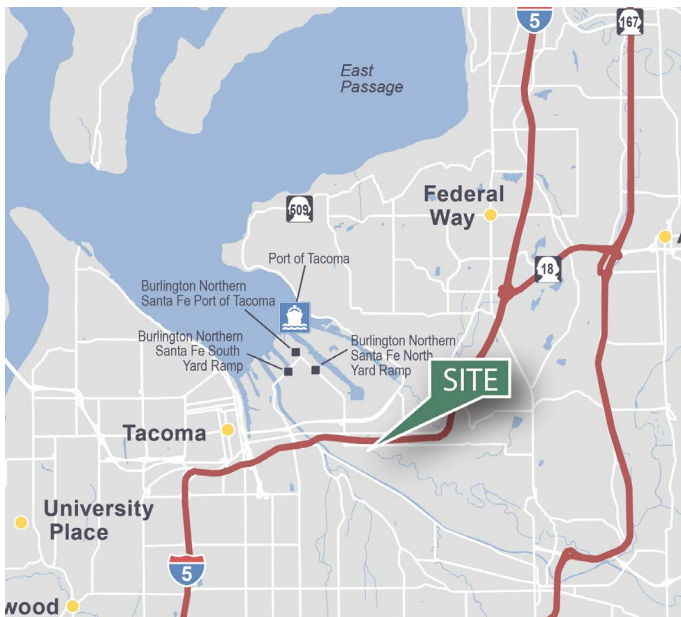

### LOCATION

- Immediate access to Interstate 5
- No City of Fife B&O taxes
- Good central location to South King and Pierce Counties

### FACILITY

- Total building size: 278,264 SF
- Available space size: 63,600 SF
- Office space: 5,370 SF
- Dock high doors: 19 (3 with levelers)
- Drive-in doors: 2

# 63,600 SF

## Industrial Space For Lease

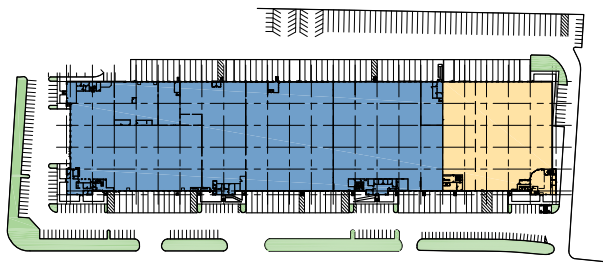

**BLDG 10**  
**OVERALL PLAN**  
NTS



**LEGEND:**

- ▲ DOCK POSITION
- ▲ DOCK POSITION W/ LEVELER
- ◆ DRIVE-IN DOOR
- LAND
- LEASED AREA
- AVAILABLE AREA

NOTE: THIS CONCEPTUAL PLAN IS FOR MARKETING PURPOSES ONLY AND HAS BEEN PREPARED BASED ON PRELIMINARY AVAILABLE SITE INFORMATION DEEMED RELIABLE. ALL DIMENSION AREA CALCULATIONS ARE SUBJECT TO VERIFICATION BY A PROFESSIONAL ENGINEER FOR COMPLIANCE WITH ALL FEDERAL, STATE, AND LOCAL REGULATIONS.

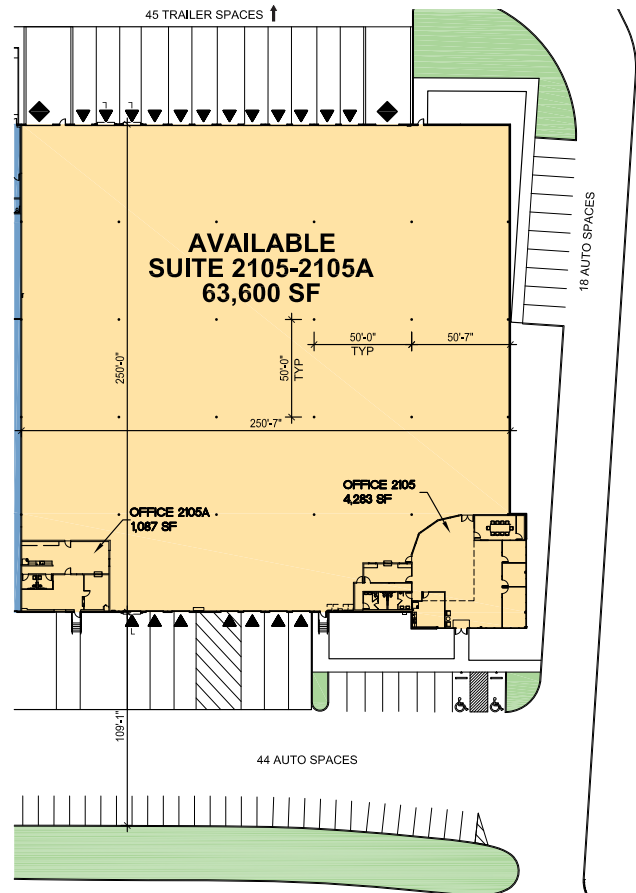

**OFFICE FLOORPLAN**

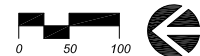

**Monte Decker, CCIM**  
monte.decker@cbre.com  
ph +1 253 596 0041  
fax +1 253 596 0059  
1201 Pacific Avenue  
Suite 1502  
Tacoma, WA 98402 USA

**Chris Cowles**  
chris.cowles@cbre.com  
ph +1 253 596 0048  
fax +1 253 596 0059  
1201 Pacific Avenue  
Suite 1502  
Tacoma, WA 98402 USA

**Mark Roddy**  
mroddy@prologis.com  
ph +1 206 414 7617  
fax +1 206 414 7601  
12720 Gateway Drive  
Suite 110  
Tukwila, WA 98168 USA

No warranty or representation, expressed or implied, is made as to the accuracy of the information contained herein, and same is submitted subject to error and omissions.

[www.prologis.com](http://www.prologis.com) [www.cbre.us](http://www.cbre.us)

© 2018 CBRE, Inc. All rights reserved. This information has been obtained from sources believed reliable, but has not been verified for accuracy or completeness. You should conduct a careful, independent investigation of the property and verify all information. Any reliance on this information is solely at your own risk. CBRE and the CBRE logo are service marks of CBRE, Inc. All other marks displayed on this document are the property of their respective owners. Photos herein are the property of their respective owners. Use of these images without the express written consent of the owner is prohibited. RB 03.06.19