

48,768 SF

Industrial Space For Lease



Prologis Olympic 2



4600 Olympic Boulevard
Erlanger, KY 41018 USA

LOCATION

- Northern Kentucky submarket
- 4 miles from Cincinnati/Northern Kentucky International Airport
- Immediate access to I-275 and I-71/I-75

FACILITY

- 109,241 SF building
- 5,370 SF of office space
- 23' clear height
- (8) dock doors, equipped with pit levelers and restraints
- 40' x 40' column spacing
- 2.2 parking ratio per 1,000 SF
- 1,600 amp/480 volt 3-phase electric service
- Ideal for light manufacturing/warehousing
- LED lighting throughout warehouse and office

ADVANTAGES AND AMENITIES

- Locally developed, owned and managed
- Dedicated [Prologis Customer Experience Team](#)



Scan the QR code for more info!

Your single-source service for efficient move-in and operations: [prologisessentials.com](https://www.prologisessentials.com).

48,768 SF

Industrial Space For Lease



Prologis Olympic 2

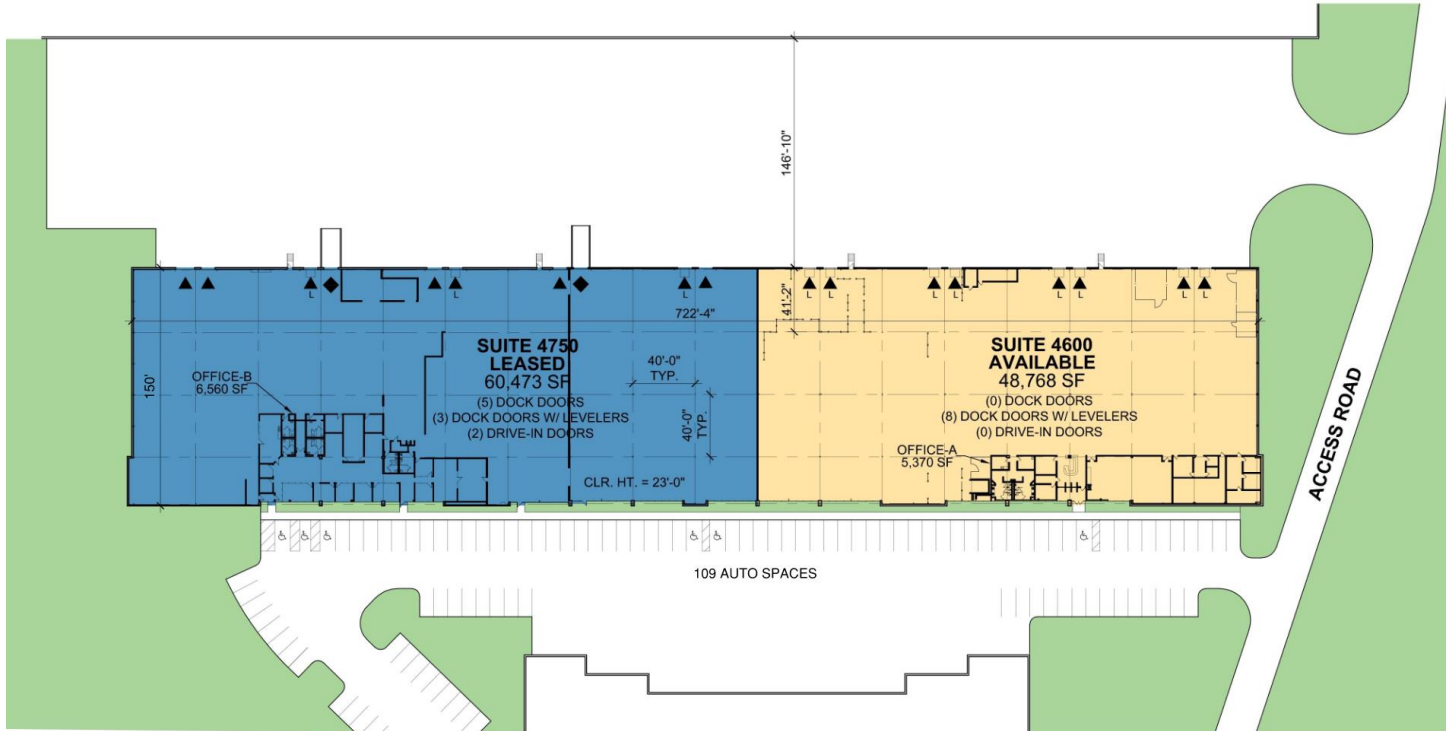

Colliers

Andrew Jacob
andrew.jacob@colliers.com
ph +1 513 562 2254
cell +1 859 547 6947
425 Walnut Street, Suite 1200
Cincinnati, OH 45202 USA

Colliers

Erin Casey, SIOR
erin.casey@colliers.com
ph +1 513 562 2225
cell +1 513 312 7468
425 Walnut Street, Suite 1200
Cincinnati, OH 45202 USA

Colliers

John Gartner, SIOR
john.gartner@colliers.com
ph +1 513 562 2207
cell +1 513 460 3321
425 Walnut Street, Suite 1200
Cincinnati, OH 45202 USA

Prologis

Dan Colletto
dcolletto@prologis.com
ph +1 513 346 6317
cell +1 513 400 2395
8760 Global Way
West Chester, OH 45069 USA