

# ±21,401 SF

Industrial Space For Lease



## Prologis Cheyenne Distribution Center 1



2875 North Lamb Boulevard, Suites 5 & 6  
Las Vegas, NV 89115 USA

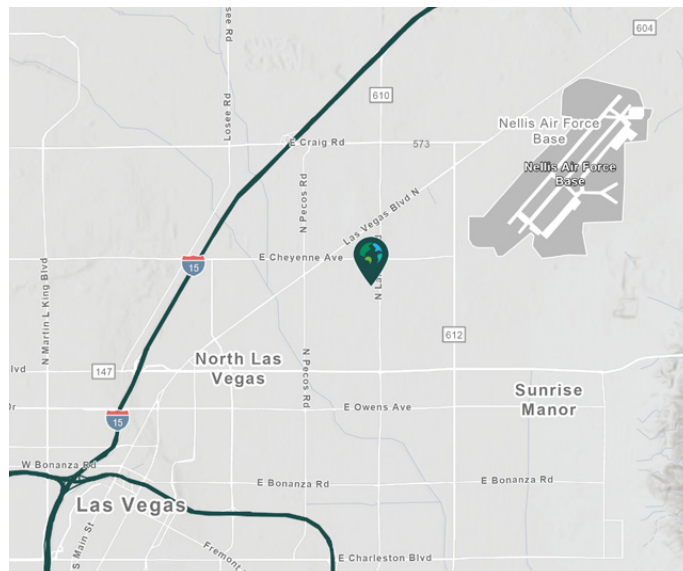

### LOCATION

- Desirable North Las Vegas location at the intersection of North Lamb Boulevard and East Cheyenne Avenue
- Quick access to I-15 freeway
- Zoned: Designed Manufacturing (M-D)
- Professionally owned and managed by Prologis

### FACILITY

- ±171,017 Total SF
- ±21,401 SF Available
- 2,092 SF Office
- (4) Dock High Doors
- (2) Grade Level Doors
- (1) Edge of Dock Leveler
- (1) Pit Leveler
- 21' Clear Height
- Sprinkler calc. (0.295gpm/2,000SF)
- 3-Phase Power, 277/480 volt, 200 amps
- Parking Ratio: 2/1,000 SF
- Natural gas line
- Separate water and sewer meter

### ADVANTAGES AND AMENITIES

- Functional Design, Turn-key Unit
- Full-span Trusses - No Columns



Scan the QR code for more info!

**Your single-source service for efficient move-in and operations:**  
[prologisessentials.com](http://prologisessentials.com)

[www.prologis.com](http://www.prologis.com) [www.cbre.us](http://www.cbre.us)

# ±21,401 SF

## Industrial Space For Lease



# Prologis Cheyenne Distribution Center 1

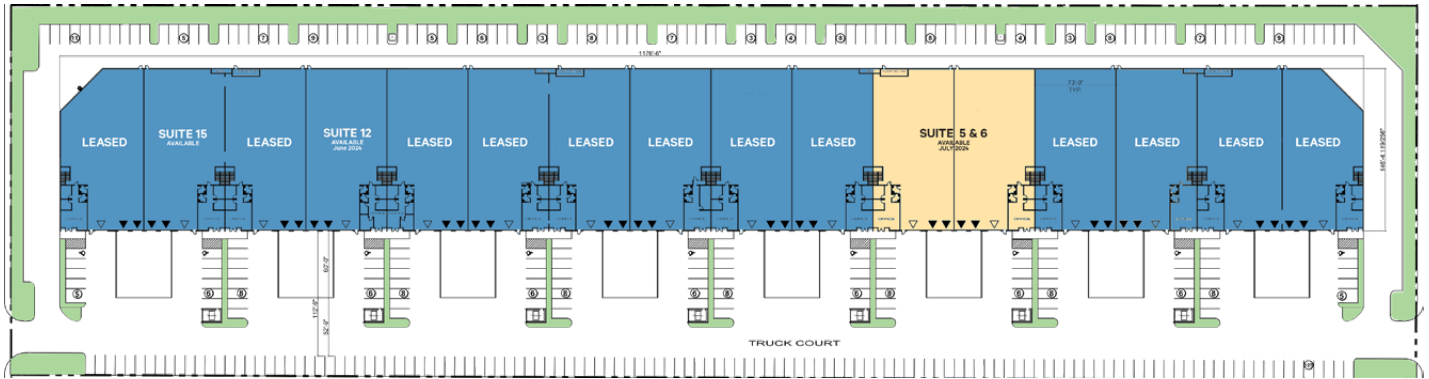

△ DOCK DOORS = 32    ⊕ AUTO PARKING SPACES = 370  
△ GRADE DOORS = 16    ⊕ TRAILER PARKING SPACES = 0

### SUITES 5 & 6

- ±171,017 Total SF
- ±21,401 SF Available
- 2,092 SF Office
- (4) Dock High Doors
- (2) Grade Level Doors
- (1) Edge of Dock Leveler
- (1) Pit Leveler
- 21' Clear Height
- Sprinkler calc. (0.295gpm/2,000SF)
- 3-Phase Power, 277/480 volt, 200 amps
- Parking Ratio: 2/1,000 SF
- Natural gas line
- Separate water and sewer meter
- Available July 2024

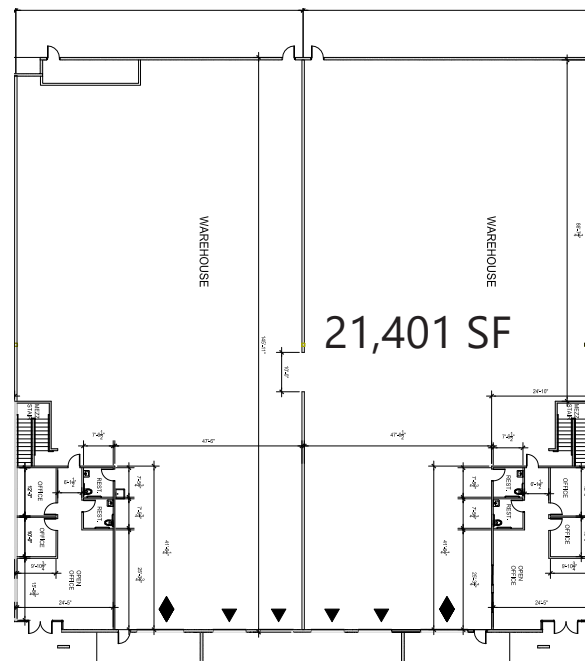

▲ DOCK DOORS = 4  
◆ GRADE DOORS = 2

\*floor plan not to scale



**CBRE**  
Sean Zaher, SIOR  
Senior Vice President  
sean.zaher@cbre.com  
1 702 369 4863  
NV LIC. #S.0175473  
8548 Rozita Lee Ave. Suite 200  
Las Vegas, NV 89113 USA

**CBRE**  
Kelsey Higgins  
Associate  
kelsey.higgins@cbre.com  
1 702 369 4812  
NV LIC. #S.0192524  
8548 Rozita Lee Ave. Suite 200  
Las Vegas, NV 89113 USA

**Prologis**  
Renee Carroll  
Senior Leasing Manager  
rcarroll@prologis.com  
1 702 891 9503  
3883 Howard Hughes Pkwy. Suite 850  
Las Vegas, NV 89169

**Prologis**  
Lisa Brady  
Vice President - Market Officer  
lbrady@prologis.com  
1 702 891 9141  
NV LIC. #B.1002217  
3883 Howard Hughes Pkwy. Suite 850  
Las Vegas, NV 89169