

# 58,134 – 148,000 SF

Industrial Space For Lease



## Prologis Hartsfield East



4350 International Parkway  
Atlanta, GA 30354 USA

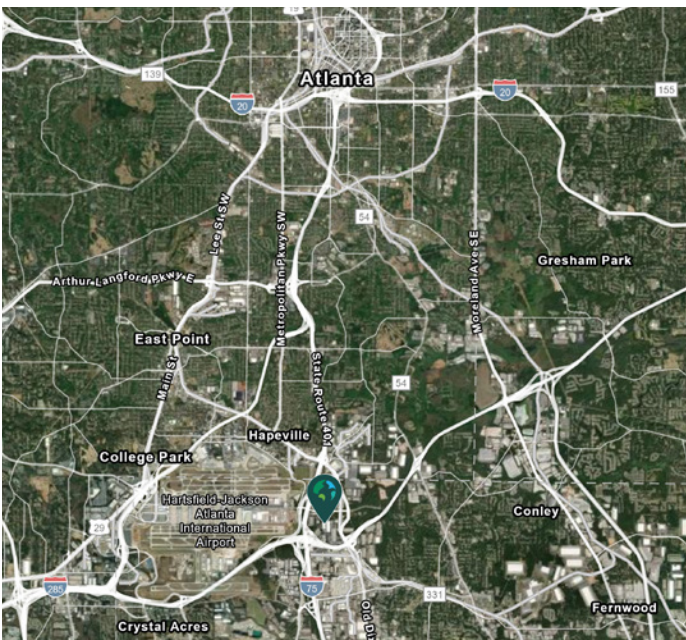

### LOCATION

- Immediate access to Hartsfield-Jackson Atlanta International Airport
- <1 mile from I-75
- ±1.9 miles from I-285
- ±9.8 miles from I-85
- Clayton County Tier 1 Tax Incentives

### FACILITY

- 148,000 SF available (partially climate controlled)
  - 14,344 SF office
- 28' minimum clear height
- Thirty-three (33) dock doors
  - Twenty-five (25) with pit levelers
  - Six (6) with edge of dock levelers
- Three (3) drive-in doors
- 141 auto parking spaces
- 20 trailer parking spaces
- 240' building depth
- 50' x 40' column spacing
- Power: 277/480V, 400A
- ESFR Sprinkler System
- Eight (8) 30-amp charger disconnects

### ADVANTAGES AND AMENITIES

- Prologis Clear Lease® – Know your lease expenses and capital costs with greater certainty before you sign



Scan the QR code for more info!

**Your single-source service for efficient move-in and operations: [prologisessentials.com](https://www.prologisessentials.com)**

# 58,134 SF

Industrial Space For Lease



## Prologis Hartsfield East

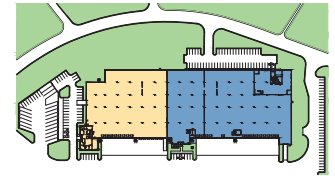
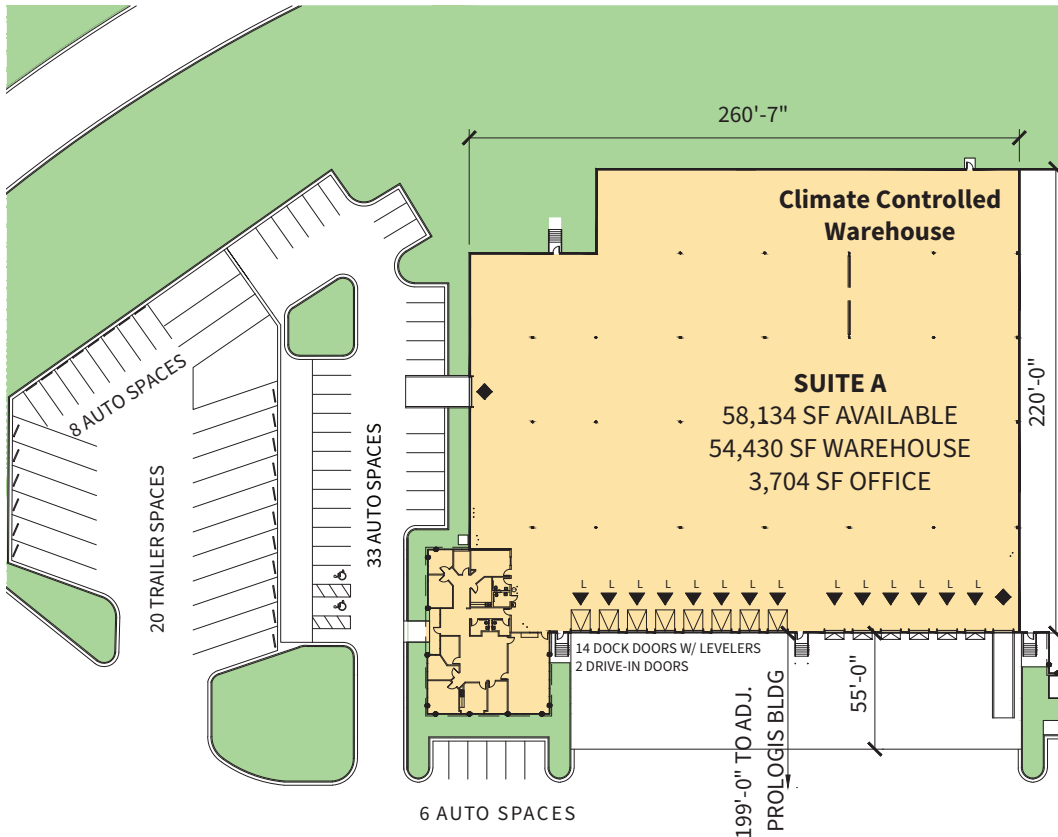

KEY PLAN

LEGEND:

- ▲ DOCK DOOR
- ▲ DOCK DOOR W/LEVELER
- ◆ DRIVE-IN DOOR
- ▲ ON-GRADE DOOR
- ▬ EDGE OF DOCK LEVELER
- ▽ PIT LEVELER
- LAND
- LEASED AREA
- VACANT AREA



**Seefried Industrial**  
**Joseph Kriss**

josephk@seefriedproperties.com  
ph +1 404 233 0204  
cell +1 678 362 4641  
3333 Riverwood Parkway SE  
Suite 200  
Atlanta, GA 30339 USA

**Seefried Industrial**  
**Tripp Ausband**

tausband@seefriedproperties.com  
ph +1 404 233 0204  
cell +1 770 825 3391  
3333 Riverwood Parkway SE  
Suite 200  
Atlanta, GA 30339 USA

**Prologis**  
**Cassie Hanavich**

chanavich@prologis.com  
ph +1 404 760 7256  
cell +1 404 449 5356  
3350 Peachtree Rd  
Suite 850  
Atlanta, Georgia 30326 USA

# 62,400 SF

Industrial Space For Lease



## Prologis Hartsfield East

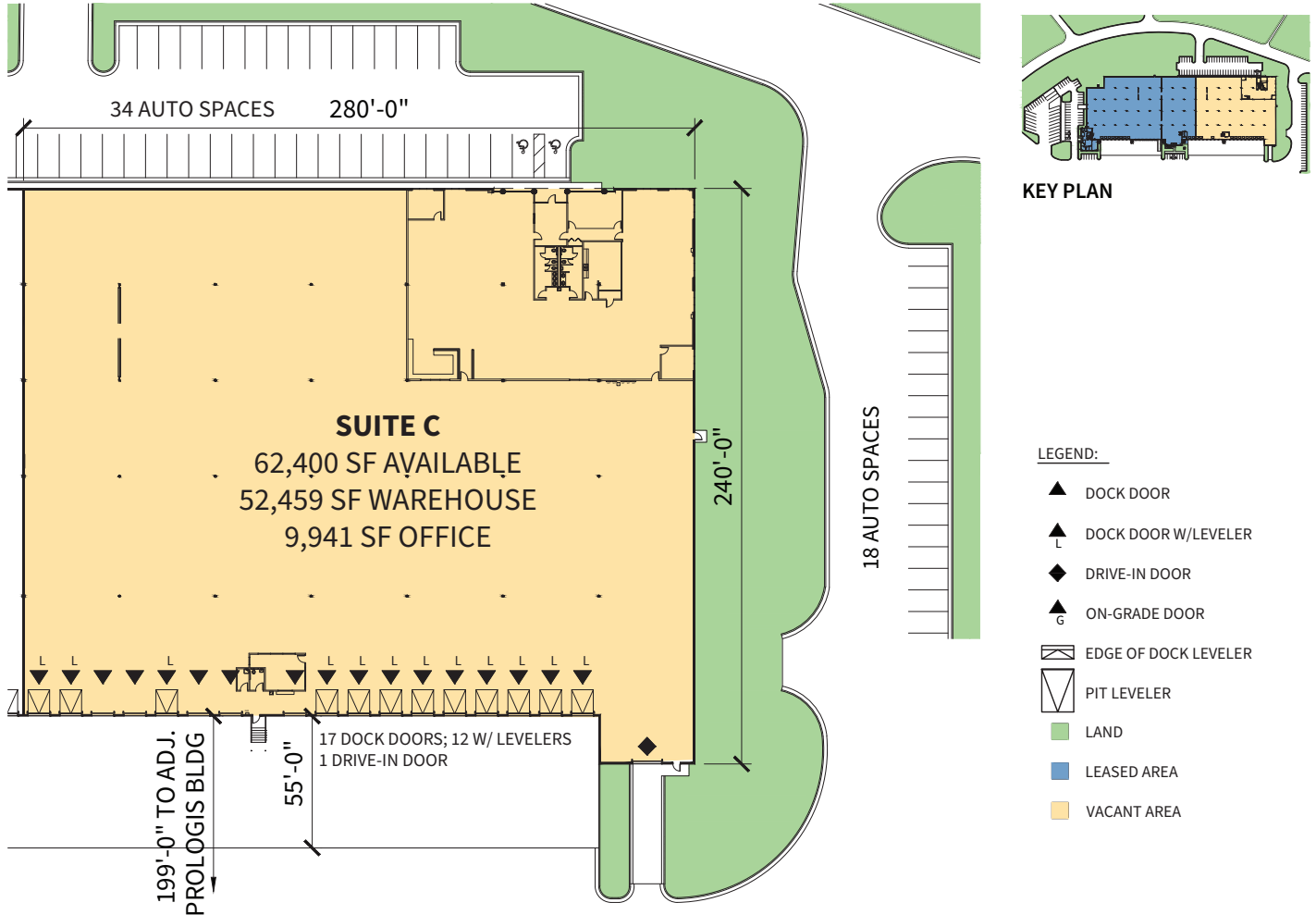

### Seefried Industrial

**Joseph Kriss**

josephk@seefriedproperties.com  
ph +1 404 233 0204  
cell +1 678 362 4641  
3333 Riverwood Parkway SE  
Suite 200  
Atlanta, GA 30339 USA

### Seefried Industrial

**Tripp Ausband**

tausband@seefriedproperties.com  
ph +1 404 233 0204  
cell +1 770 825 3391  
3333 Riverwood Parkway SE  
Suite 200  
Atlanta, GA 30339 USA

### Prologis

**Cassie Hanavich**

chanavich@prologis.com  
ph +1 404 760 7256  
cell +1 404 449 5356  
3350 Peachtree Rd  
Suite 850  
Atlanta, Georgia 30326 USA

# 85,600 SF

## Industrial Space For Lease



# Prologis Hartsfield East

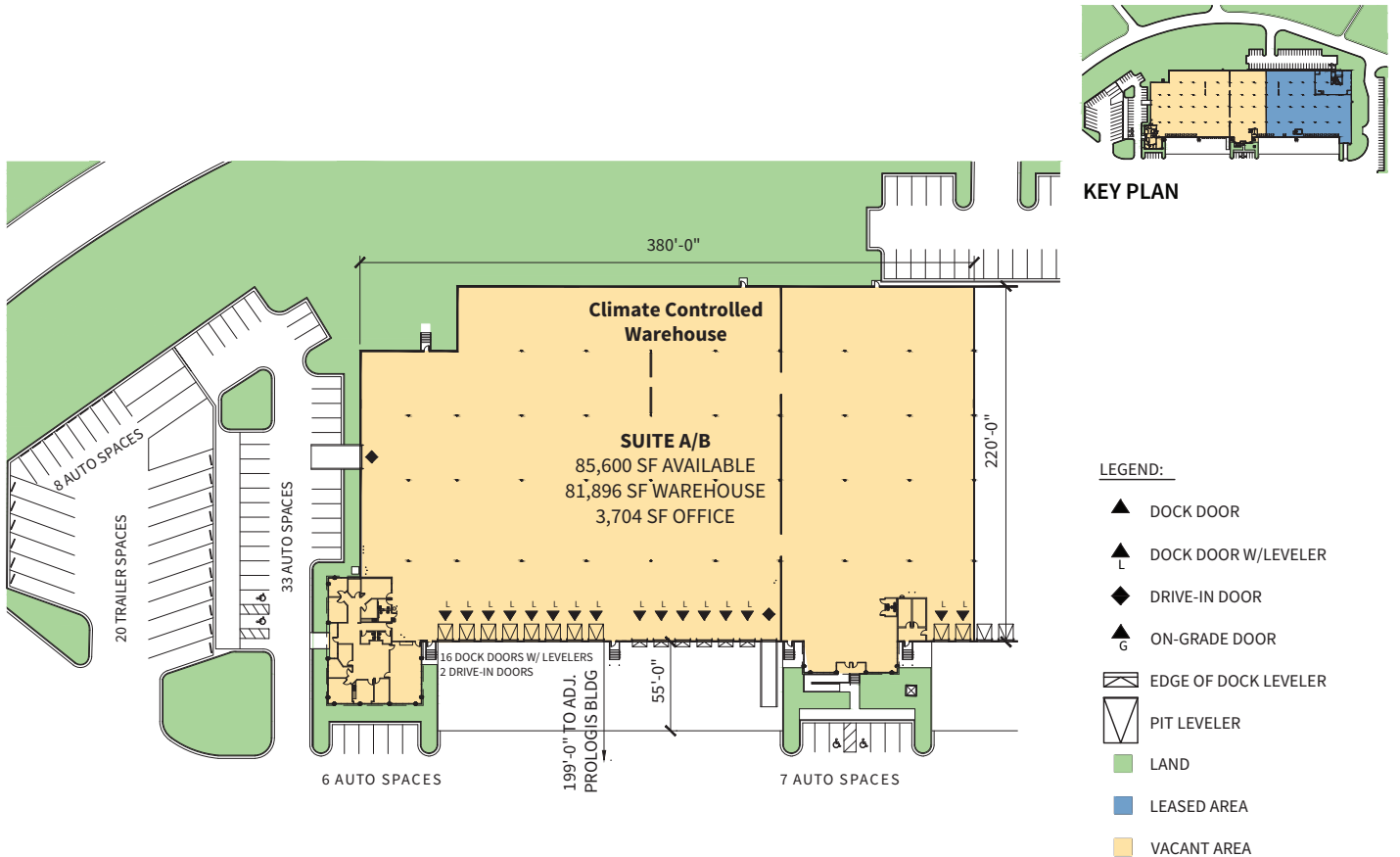

### Seefried Industrial Joseph Kriss

josephk@seefriedproperties.com  
ph +1 404 233 0204  
cell +1 678 362 4641  
3333 Riverwood Parkway SE  
Suite 200  
Atlanta, GA 30339 USA

### Seefried Industrial Tripp Ausband

tausband@seefriedproperties.com  
ph +1 404 233 0204  
cell +1 770 825 3391  
3333 Riverwood Parkway SE  
Suite 200  
Atlanta, GA 30339 USA

### Prologis Cassie Hanavich

chanavich@prologis.com  
ph +1 404 760 7256  
cell +1 404 449 5356  
3350 Peachtree Rd  
Suite 850  
Atlanta, Georgia 30326 USA

# 89,866 SF

## Industrial Space For Lease



# Prologis Hartsfield East

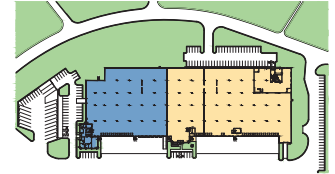
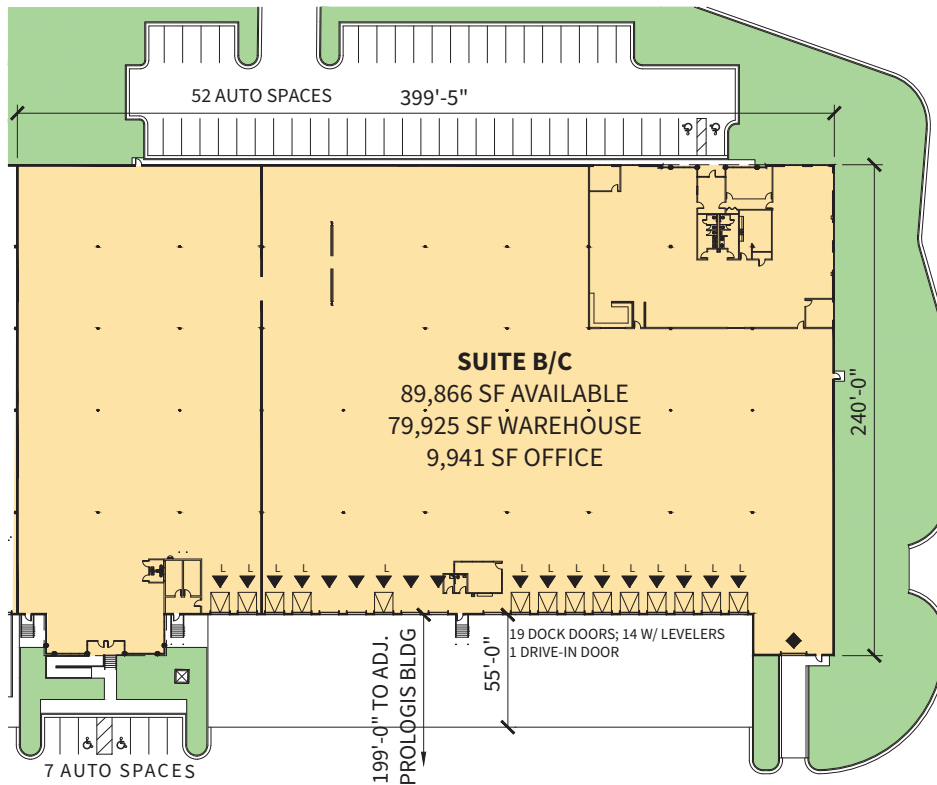

KEY PLAN

LEGEND:

- ▲ DOCK DOOR
- ▲ L DOCK DOOR W/LEVELER
- ◆ DRIVE-IN DOOR
- ▲ G ON-GRADE DOOR
- ▨ EDGE OF DOCK LEVELER
- ▨ PIT LEVELER
- LAND
- LEASED AREA
- VACANT AREA



**Seefried Industrial**  
**Joseph Kriss**

josephk@seefriedproperties.com  
ph +1 404 233 0204  
cell +1 678 362 4641  
3333 Riverwood Parkway SE  
Suite 200  
Atlanta, GA 30339 USA

**Seefried Industrial**  
**Tripp Ausband**

tausband@seefriedproperties.com  
ph +1 404 233 0204  
cell +1 770 825 3391  
3333 Riverwood Parkway SE  
Suite 200  
Atlanta, GA 30339 USA

**Prologis**  
**Cassie Hanavich**

chanavich@prologis.com  
ph +1 404 760 7256  
cell +1 404 449 5356  
3350 Peachtree Rd  
Suite 850  
Atlanta, Georgia 30326 USA



# 148,000 SF

Industrial Space For Lease



## Prologis Hartsfield East

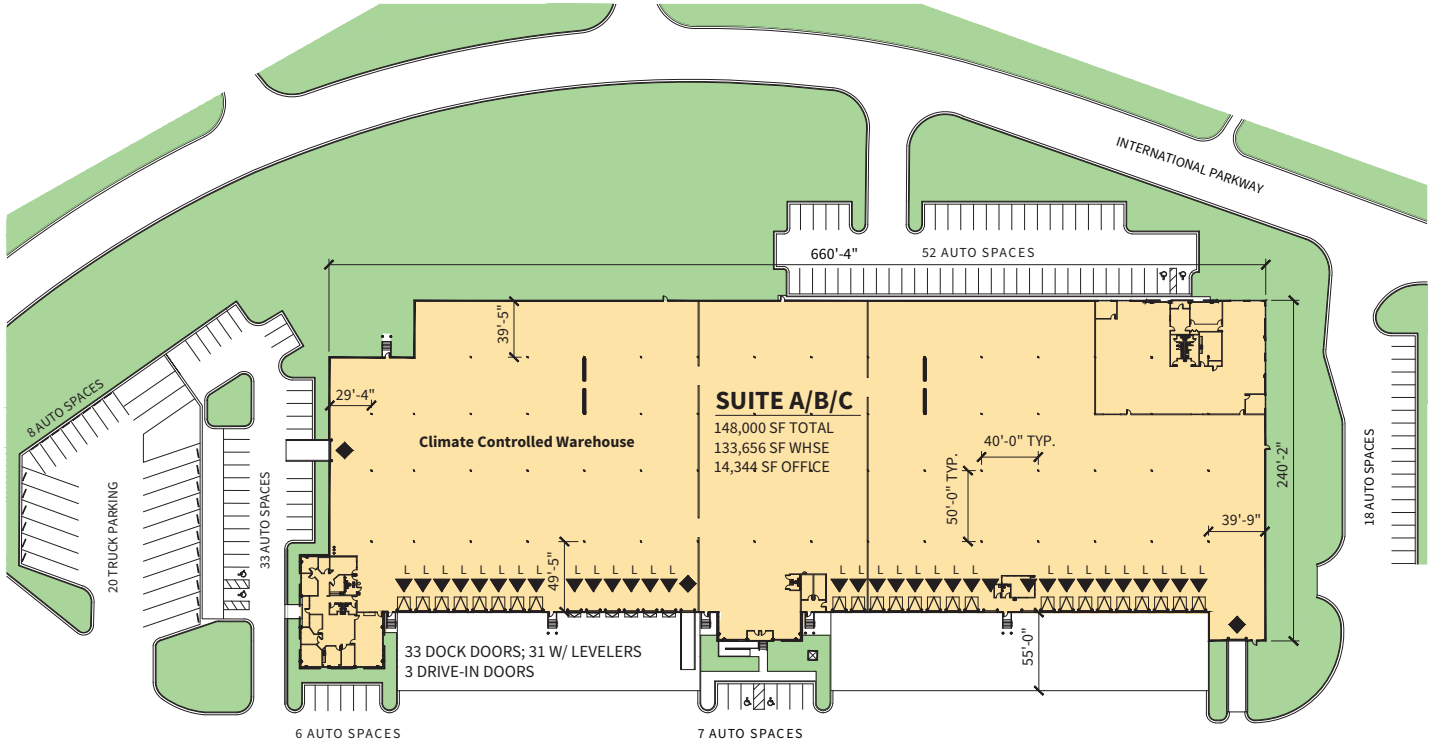

**LEGEND:**

- ▲ DOCK DOOR
- ▲ ON-GRADE DOOR
- LAND
- ▲ DOCK DOOR W/LEVELER
- ▨ EDGE OF DOCK LEVELER
- LEASED AREA
- ◆ DRIVE-IN DOOR
- ▩ PIT LEVELER
- VACANT AREA



**Seefried Industrial**  
**Joseph Kriss**  
josephk@seefriedproperties.com  
ph +1 404 233 0204  
cell +1 678 362 4641  
3333 Riverwood Parkway SE  
Suite 200  
Atlanta, GA 30339 USA

**Seefried Industrial**  
**Tripp Ausband**  
tausband@seefriedproperties.com  
ph +1 404 233 0204  
cell +1 770 825 3391  
3333 Riverwood Parkway SE  
Suite 200  
Atlanta, GA 30339 USA

**Prologis**  
**Cassie Hanavich**  
chanavich@prologis.com  
ph +1 404 760 7256  
cell +1 404 449 5356  
3350 Peachtree Rd  
Suite 850  
Atlanta, Georgia 30326 USA