

22,663 SF

Industrial Space For Lease



Prologis Great Southwest 33



1097 Avenue R
Grand Prairie, TX 75050 USA

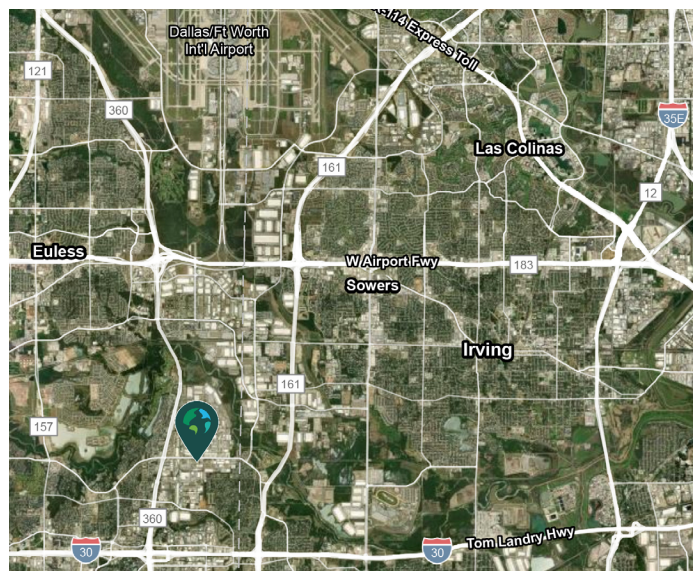

LOCATION

- In the heart of the North Great Southwest industrial submarket with easy access to SH 360, I-30, and TX-161

FACILITY

- 22,663 sf available
- 1,936 sf office
- 22' clear height
- 30' x 43'9" typical bay spacing
- 3 (10'x10') overhead dock doors with levelers
- Fully sprinklered
- Security fence and gates

ADVANTAGES AND AMENITIES

- Access to the [Prologis Essentials](#) platform, which includes:
 - [Operations Essentials](#)
 - [Energy + Sustainability Essentials](#)
 - [Mobility Essentials](#)
 - [Workforce Essentials](#)

Prologis Essentials: your single-source service for efficient move-in and operations at prologisessentials.com

22,663 SF

Industrial Space For Lease



Prologis Great Southwest 33



Prologis Essentials: your single-source service for efficient move-in and operations at [prologisessentials.com](https://www.prologisessentials.com)

22,663 SF

Industrial Space For Lease



Prologis Great Southwest 33

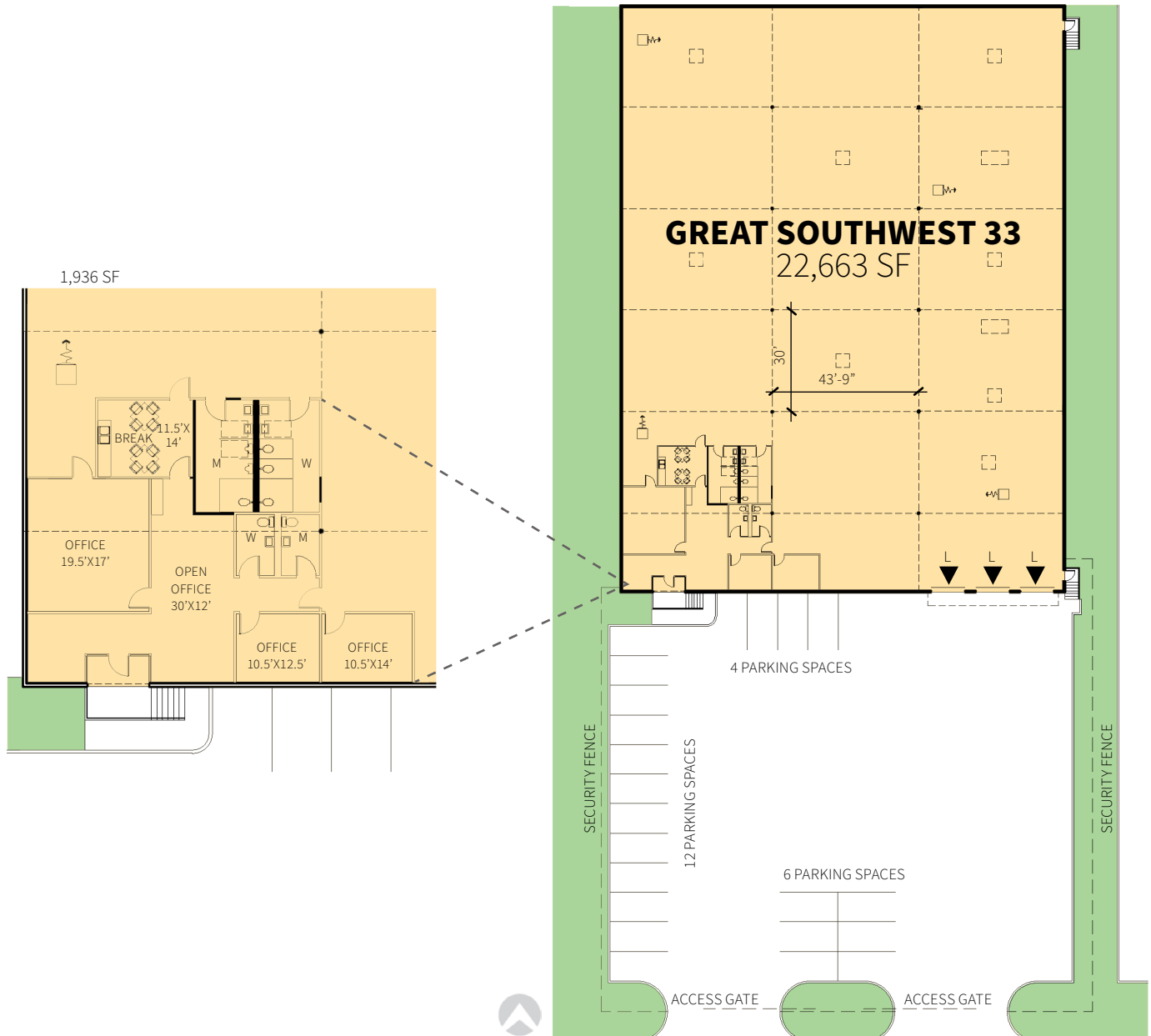

Mercer Company

Corby Hodgkiss, SIOR
Executive Vice President
chodgkiss@mercerc-company.com
ph +1 214 630 7010
cell +1 469 360 3918
2461 N Stemmons Freeway
Dallas, TX 75207 USA

Mercer Company

Harrison Putt
Market Director
hputt@mercerc-company.com
ph +1 214 630 7010
cell +1 214 945 7306
2461 N Stemmons Freeway
Dallas, TX 75207 USA

Prologis

Ryan McNaughton
Senior Leasing Manager
rmcnaughton@prologis.com
ph +1 972 884 9218
cell +1 214 673 9489
2021 McKinney Avenue
Suite 1050
Dallas, TX 75201 USA