

# 5,399 SF

## Flex/Industrial Space For Lease



## Prologis Ammendale Park

11800 BALTIMORE AVENUE

Beltsville, MD 20705 USA

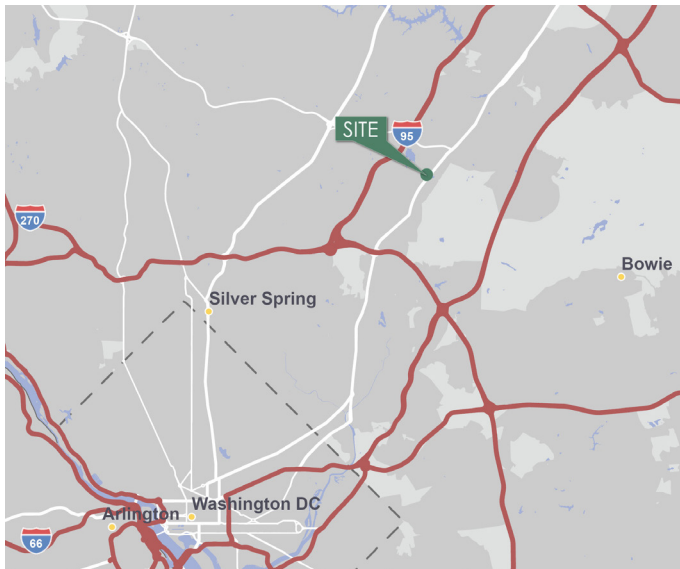

### LOCATION

- Immediate access to the Capital Beltway (I-495), I-95, and the ICC (Route 200)

### FACILITY

- Suite 112 available - 5,399± SF
- One loading dock
- 33' x 37' column spacing
- 21' clear ceiling height
- 3/1000 SF parking ratio
- 277/480v power

### ADVANTAGES AND AMENITIES

- Ideal location for serving Washington DC and Baltimore markets
- Fast, cost-effective forklift and racking sourcing through Prologis Essentials.

# 5,399 SF

## Flex/Industrial Space For Lease

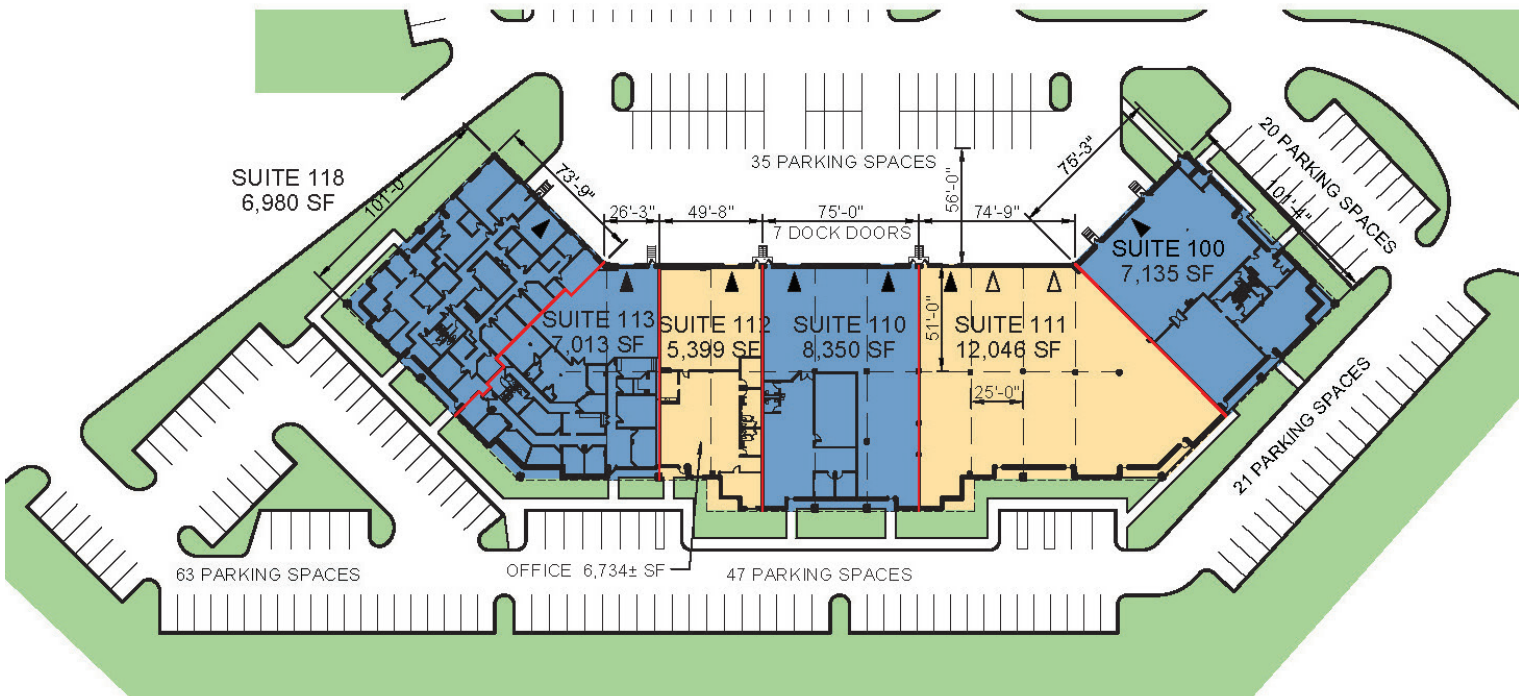

**LEGEND:**

- ▲ DOCK POSITION
- ▲ DOCK POSITION W/LEVELER
- ▲ FUTURE DOCK POSITION
- ◆ DRIVE-IN DOOR
- LAND
- LEASED AREA
- AVAILABLE AREA



COMMERCIAL REAL ESTATE SERVICES, WORLDWIDE

**NAI Michael**

Lance Schwarz, SIOR  
lschwarz@naimichael.com  
ph +1 301 918 2938  
cell +1 301 675 2027  
10100 Business Parkway  
Lanham, MD 20706 USA

**NAI Michael**

Joe Palermo  
jpalermo@naimichael.com  
ph +1 301 918 2916  
cell +1 240 417 1787  
10100 Business Parkway  
Lanham, MD 20706 USA

**NAI Michael**

Peter Burleigh  
pburleigh@naimichael.com  
ph +1 301 918 2938  
cell +1 410 212 4303  
10100 Business Parkway  
Lanham, MD 20706 USA

**Prologis**

Todd Summerfield  
tsummerfield@prologis.com  
ph +1 410 715 7220  
6711 Columbia Gateway Drive  
Suite 130  
Columbia, MD 21046 USA