

# ±55,744 SF



Industrial Space For Lease

## Prologis Beltway Distribution Center



6580 Lindell Road, Suite 200  
Las Vegas, NV 89118 USA

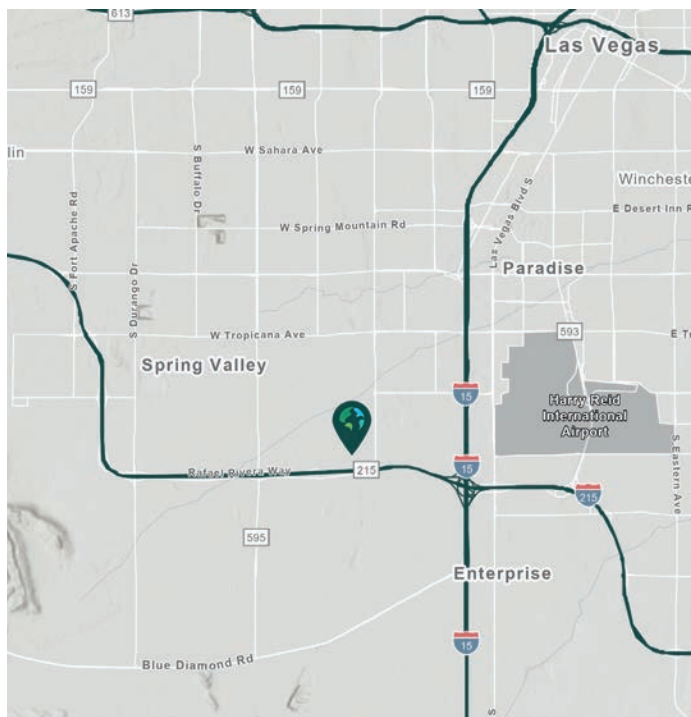

### LOCATION

- Less than 1/2 mile to I-215 via Jones Blvd. & Decatur Blvd.
- Corporate neighbors include: Pepsi Bottling, Creel Printing, Freeman, Golden Gaming, Scientific Games/Bally Technologies, Ainsworth Gaming
- Zoned: M-D, Designed Manufacturing

### FACILITY

- LEED certified ±211,438 SF rear loaded facility on 9.96 acres
  - ±55,744 SF available
  - ±2,797 SF spec office
  - 32' clear height
  - 12 dock doors (9' x 10')
  - 1 ramp to grade door (12' x 14')
  - R-38 spec roof insulation
  - 58 car parking stalls
  - 4-ply built-up roofing system
  - 2% skylights
  - Concrete tilt-up construction
  - 6" slab
  - Truck court with 60' concrete apron
  - ESFR sprinkler system
  - Evaporative cooling in warehouse
  - LED lighting in warehouse and office
  - 1,000 A, 277 V, 3-phase power

Your single-source service for efficient move-in and operations: [prologisessentials.com](http://prologisessentials.com)

# ±55,744 SF

Industrial Space For Lease



## Prologis Beltway Distribution Center

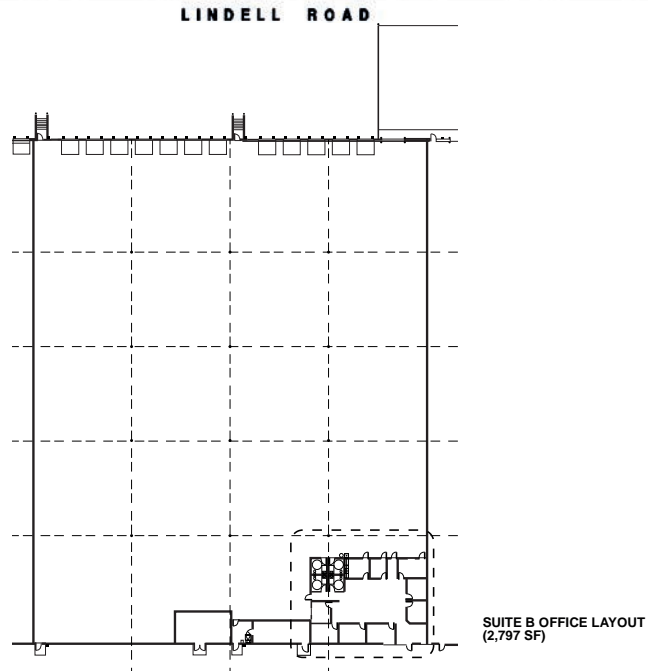
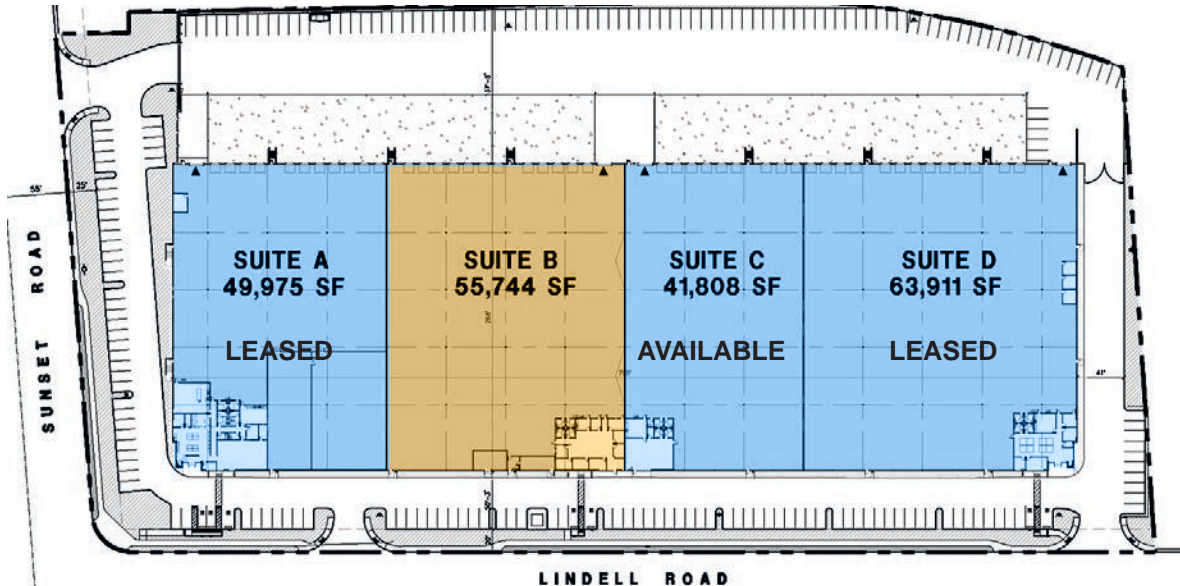

**CBRE**  
Sean Zaher, SIOR  
Senior Vice President  
sean.zaher@cbre.com  
Lic. S.0175473  
+1 702 369 4863  
8548 Rozita Lee Ave., Ste. 200  
Las Vegas, NV 89113 USA

**Prologis**  
Mathias Hughes  
SVP - Investment Officer  
mhughes@prologis.com  
Lic. S.0073128  
+1 775 829 3035  
3883 Howard Hughes Pkwy., Ste. 850  
Las Vegas, NV 89169 USA

**Prologis**  
Renee Carroll  
Senior Leasing Manager  
rcarroll@prologis.com  
+1 702 891 9503  
3883 Howard Hughes Pkwy., Ste. 850  
Las Vegas, NV 89169 USA