

±26,145 SF

Industrial Space For Lease



Prologis Hayward 35 | 3525 Arden Road



3525 Arden Road
Hayward, California 94545



LOCATION

- Bayside Distribution Center is located in the Eden Landing Submarket of Hayward and enjoys excellent access to both I-880 and Highway 92 which leads to the San Mateo/Hayward Bridge. Built in 1998, Bayside Distribution Center can easily accommodate warehouse/distribution or manufacturing type uses and serve as a corporate or regional headquarters facility.

FACILITY

- ±26,145 SF
- ±3,500 SF Office Area
- 29' Clear Height
- ESFR Sprinkler System
- Immediate Access to Highway 92 and I-880
- Heavy Power: 800 amps 277/480 volts; 3 phase
- Column Spacing: 48'x56'
- Seven (7) Dock High Doors
- One (1) Ramped Drive-in Door at One of the Dock Spots
- Concrete Truck Apron
- Available: November 1, 2023 or Earlier
- Lease Rate: Call Agent

±26,145 SF

Industrial Space For Lease



Prologis Hayward 35 | 3525 Arden Road

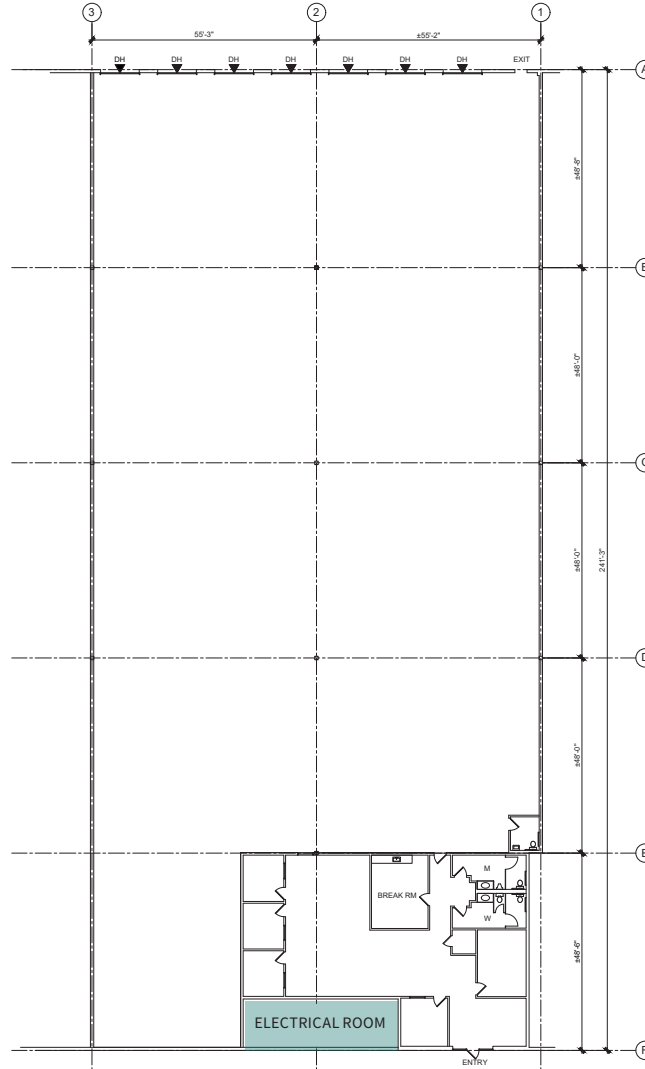

Cushman & Wakefield
Jay Hagglund, SIOR
jay.hagglund@cushwake.com
ph +1 510 267 6011
cel +1 510 918 7922
555 12th Street, Suite 1400
Oakland, CA USA
DIR Lic #00888011

Cushman & Wakefield
Kate Woodcox, SIOR
kate.woodcox@cushwake.com
ph +1 510 267 6041
cel +1 925 785 5425
555 12th Street, Suite 1400
Oakland, CA USA
DIR Lic #01809900

Cushman & Wakefield
Jackson Hagglund
jackson.hagglund@cushwake.com
ph +1 925 978 3142
cel +1 925 978 3142
555 12th Street, Suite 1400
Oakland, CA USA
DIR Lic #02138597

Prologis
Jordan Lewis
Senior Leasing Manager
jlewis2@prologis.com
ph +1 510 661 4025
3353 Gateway Boulevard
Fremont, CA USA
DIR Lic #02034839