

38,908 SF

Industrial Space For Lease



Prologis Harrisburg

7253 Grayson Road, SUITE 309
Harrisburg, PA 17111 USA

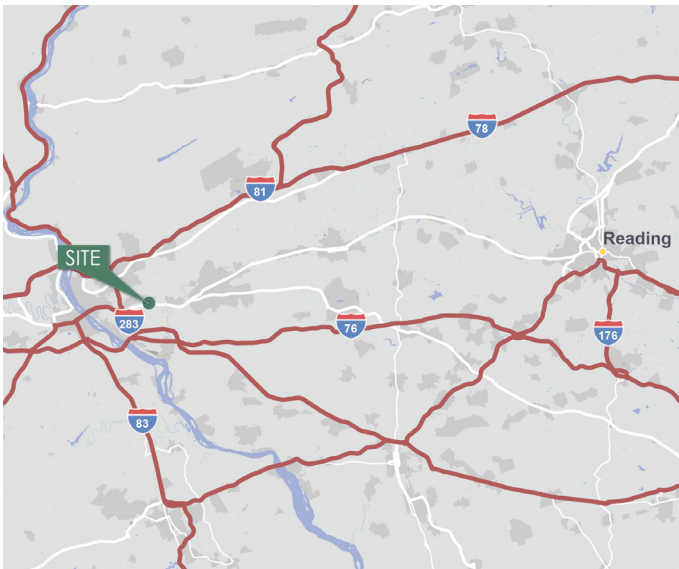

LOCATION

- This property is strategically located along Route 322 and easily accessible from I-83 and the Pennsylvania Turnpike (I-76) via I-283.
- Near major parcel hubs (UPS, FedEx) and the Rutherford Intermodal yard

FACILITY

- 197,048 square foot building
- 38,908 square foot available
- 1,587 square foot office space
- 12.42 acres
- Built in 1990
- 28'3" clear height
- 40' x 40' column spacing, 50' x 60' at docks
- 5 dock doors
- 1 drive-in door
- Wet sprinkler system
- ±26 car parking spaces

ADVANTAGES AND AMENITIES

- Access to interstates, major cities and airports.
- Route 322/Paxton Street visibility

38,908 SF

Industrial Space For Lease

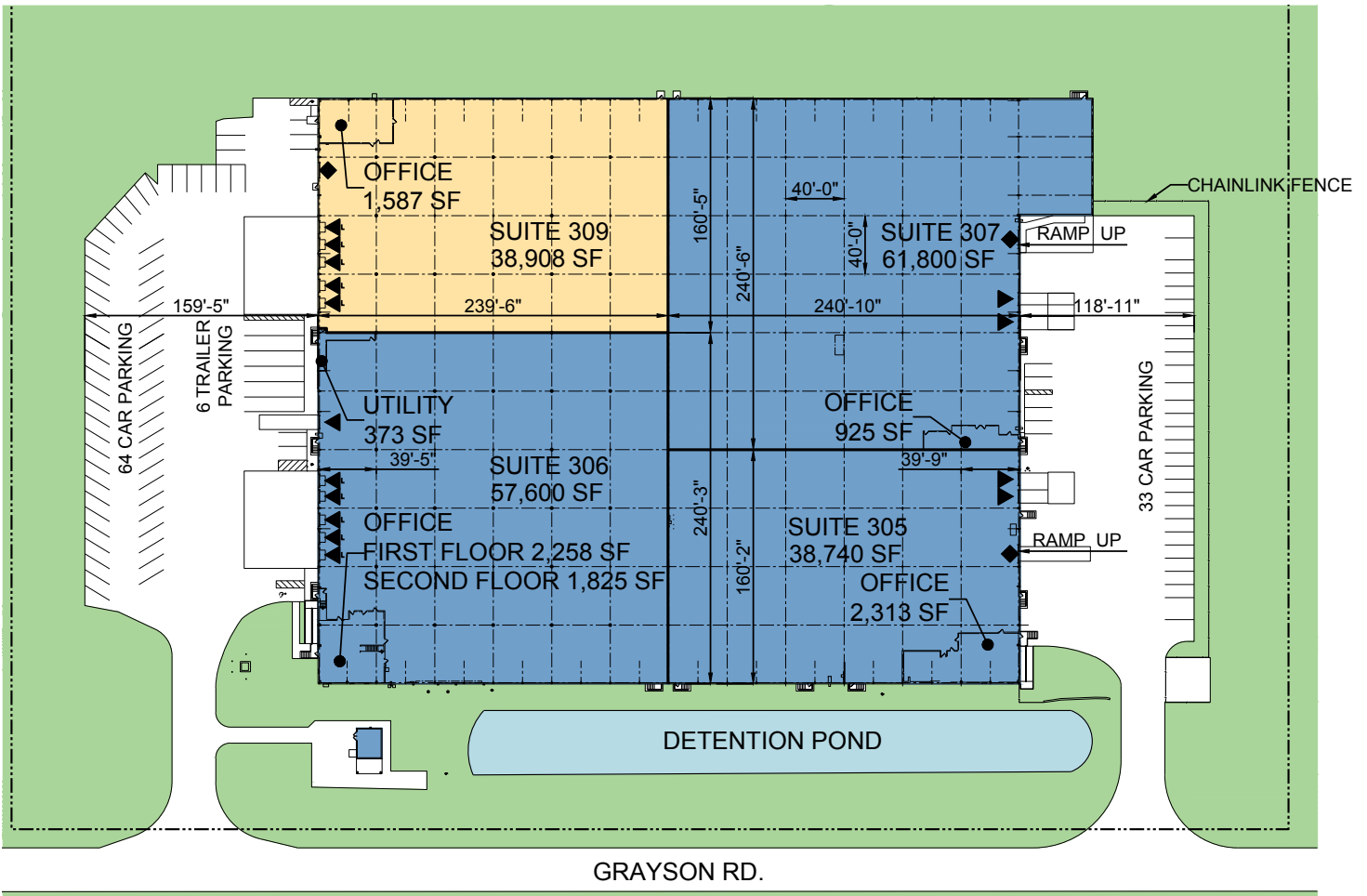

CBRE, Inc.
 Patrick Lafferty, CCIM, SIOR
 patrick.lafferty@cbre.com
 ph +1 717 540 2704
 cell +1 717 940 2131
 5 Capital Drive
 Suite 201
 Harrisburg, PA 17110 USA

CBRE, Inc.
 Bart D. Anderson
 bart.anderson@cbre.com
 ph +1 717 540 2706
 cell +1 717 756 2651
 5 Capital Drive
 Suite 201
 Harrisburg, PA 17110 USA

CBRE, Inc.
 Michael Hess, SIOR
 michael.hess@cbre.com
 ph +1 717 540 2705
 cell +1 717 649 5209
 5 Capital Drive
 Suite 201
 Harrisburg, PA 17110 USA

Prologis
 Bill Mehl
 bmehl@prologis.com
 ph +1 610 530 2866
 cell +1 610 533 2300
 7584 Morris Ct.
 Suite 200
 Allentown, PA 18106 USA