

7,200 SF

Industrial Space For Lease



Prologis Park Renton - Renton 6

820 Thomas Ave SW
Renton, WA 98057

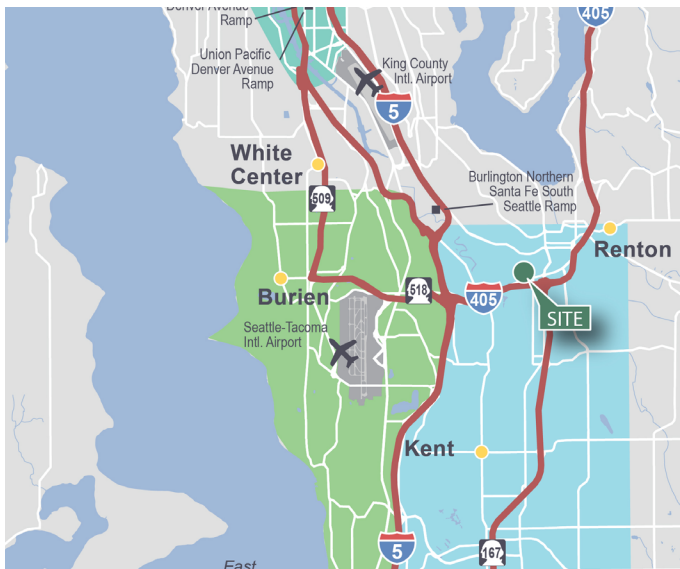

LOCATION

- North of I-405. Great freeway access via West Valley Highway, Rainier Avenue South.

FACILITY

- Property Type: Industrial
- Year Built: 1969
- Land: 5.67 AC
- Parking: 0.91/1,000 SF
- Total SF: 7,200 SF
- Office SF: 751 SF
- Clear Height: 22'
- Loading Doors: 1 Dock Door, 1 Drive-In Door, and 1 Rail Door
- Rate: Call broker, Brian Bruininks, CCIM for rates
- Available: December 1, 2021 please call broker to arrange access/tour

ADVANTAGES AND AMENITIES

- High-efficiency fluorescent lighting, no city of Seattle B&O tax.

7,200 SF

Industrial Space For Lease

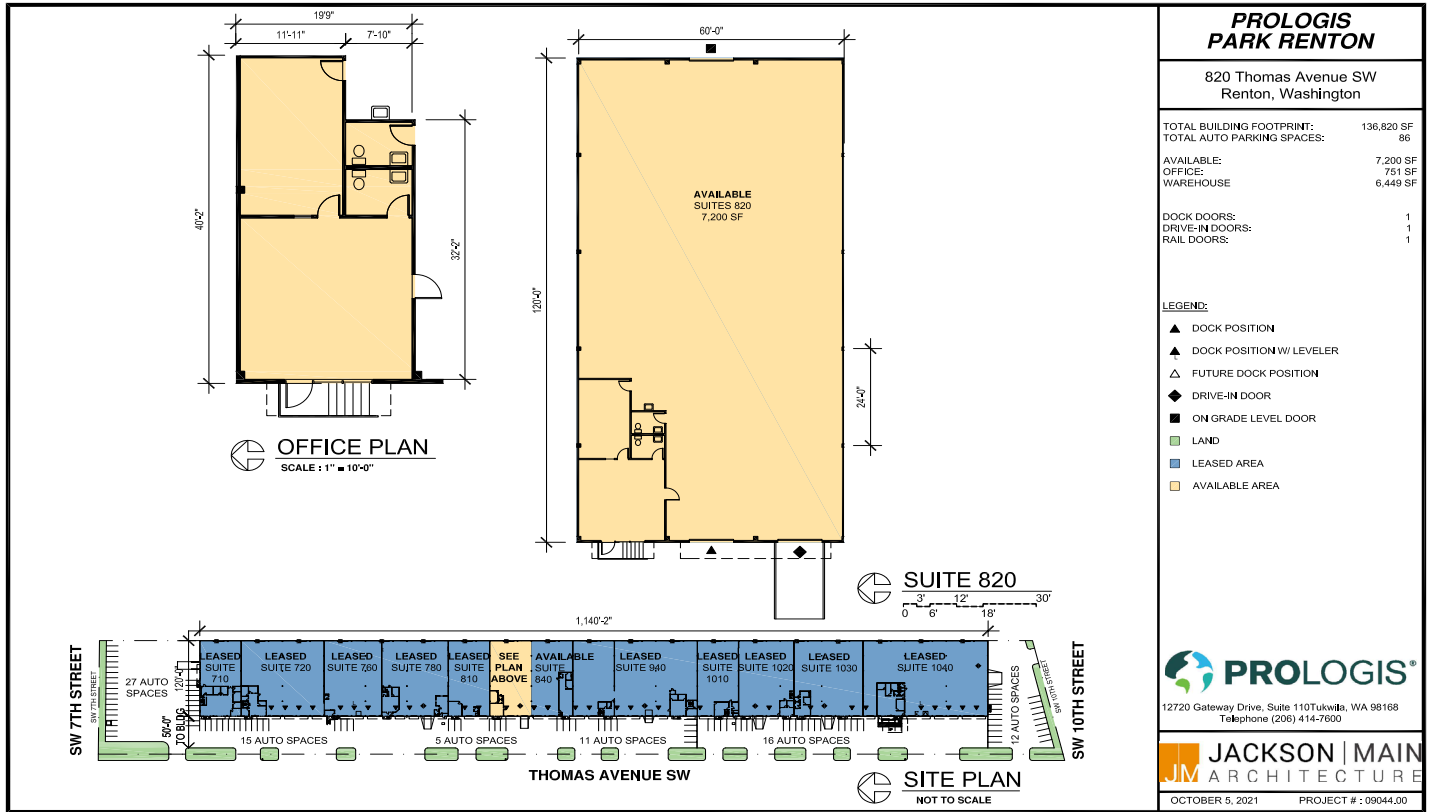

The Andover Company, Inc.
Brian Bruininks, CCIM
 bbruininks@andoverco.com
 ph +1 206 336 5324
 cell +1 206 856 6249
 900 SW 16th St
 Ste 100
 Renton, WA 98057 USA

Prologis
Kimberley Nemethy
 knemethy@prologis.com
 ph +1 206 414 7616
 cell +1 253 508 1737
 33930 Weyerhaeuser Way S
 Ste 100
 Federal Way, WA 98001 USA