

131,492 SF

Industrial Space For Lease



San Pedro Building 2



Blvd. General Pedro Verona Rodríguez Triana 2143,
Villas La Merced, Torreón, Coah. 27297

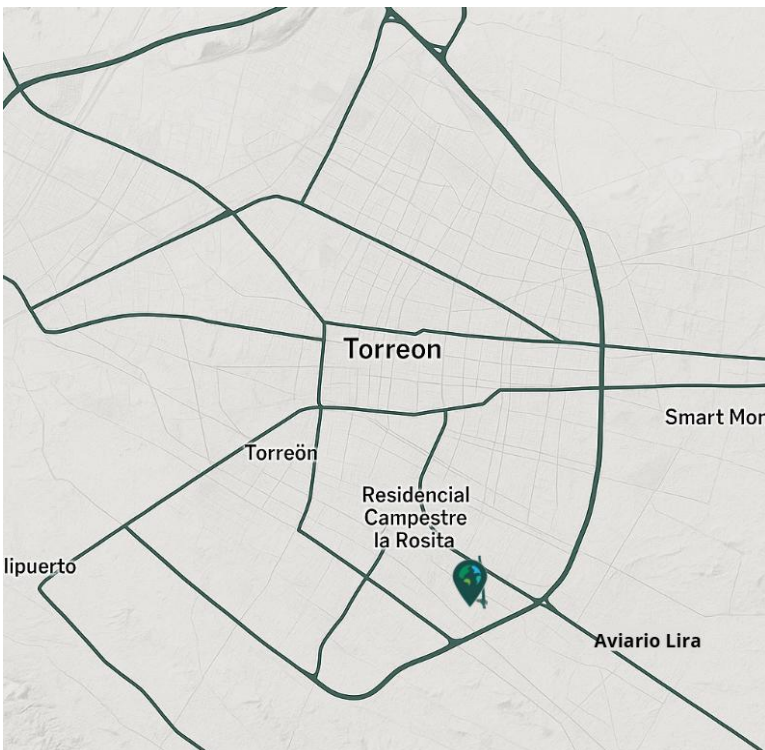

LOCATION

- Premier location for international logistics and manufacturing
- Abundant and qualified labor in the area
- Secure perimeter around property
- Secured access gate to Building

FACILITY

- Total building area: 131,492 SF.
- Clear Height: 29 FT
- Office Area: 13,195.47 SF.
- 6 Utility spaces.
- Cross Dock
- Roof: Galvanized KR-18 Ga. 22
- Production Floor: 6" Thick concrete floor
- LED interior lighting
- Fire Protection System: Hoses and Cabinets
- 10 dock-high doors
- 2 Drive-in doors
- 130 car parking spaces

Your single-source service for efficient move-in and operations: prologisessentials.com

131,492 SF

Industrial Space For Lease



San Pedro Building 8

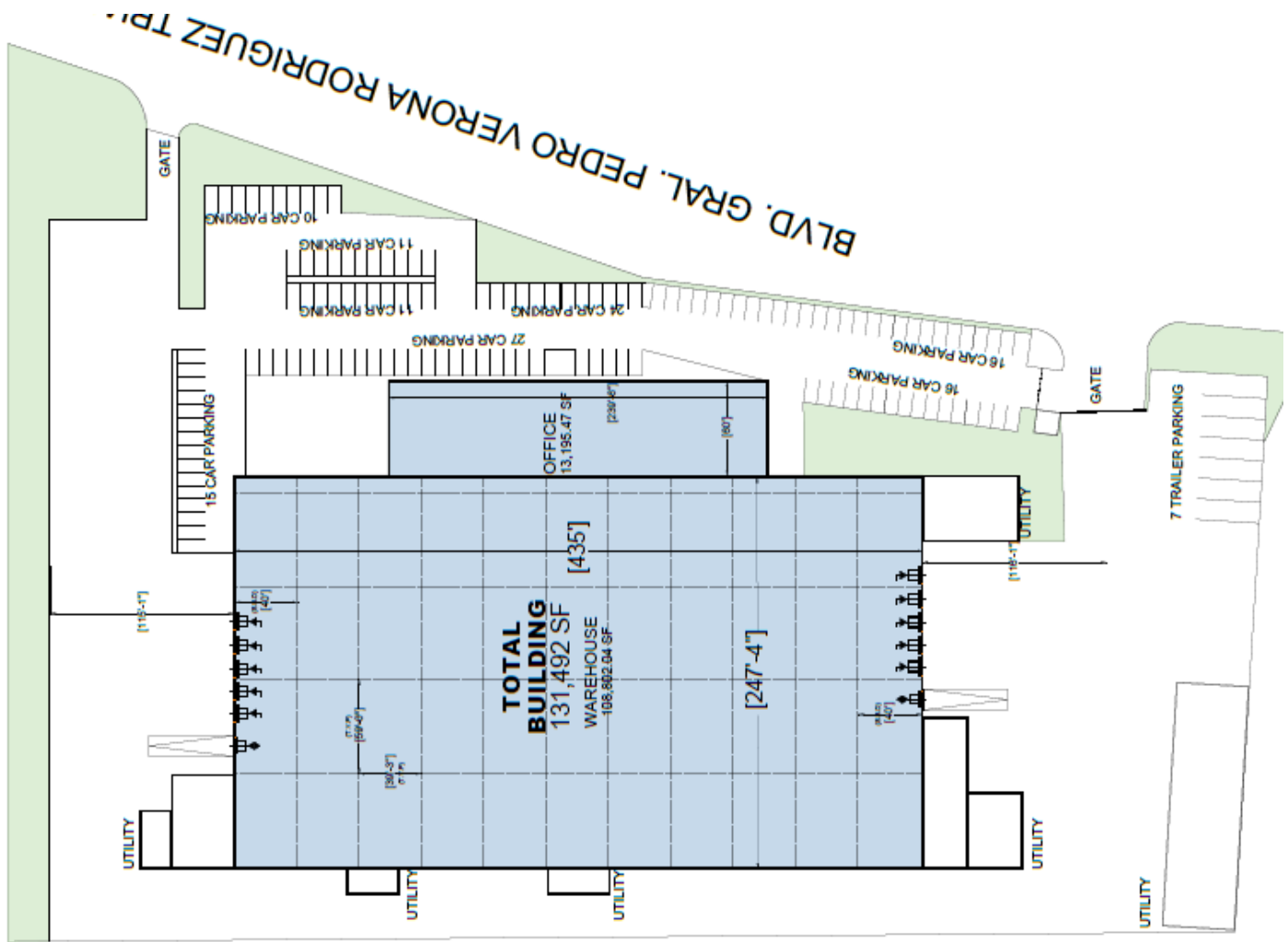

CBRE

Sergio Mireles Montaño
Advisory & Transactions
Sergio.mireles@cbre.com
D+ (81) 1517 7846
Torre Cytrus | Av. Roble 660
Piso 11, San Pedro Garza
García, N.L. C.P. 66265

CBRE

Erika Gabriela Galindo
A&T Invstr Office & PJM
Erika.galindo@cbre.com
D+ (81) 1824 1721
Torre Cytrus | Av. Roble 660
Piso 11, San Pedro Garza
García, N.L. C.P. 66265

Prologis

Fernando Pedraza Ruiz
Leasing Coordinator
fpedraza@prologis.com
+52 (81) 8684 5316
Carretera Miguel Aleman KM
21 Apodaca, Nuevo Leon,
Mexico Main: +52 81 8004 8016