

PROLOGIS PARK LERMA BUILDING 03

CASCO DEL RANCHO "ALTA EMPRESA" KM 2 CARR
AMOMOLULCO "SAN JOSÉ EL LLANITO", MPIO. LERMA DE
VILLADA, MÉXICO

MASTER PLAN

DATA:

NET RENTABLE AREA	291,210 SF
LAND AREA	624,476 SF
TOTAL PARKING	80 SPACES
REGULAR PARKING	36 SPACES
HANDICAP PARKING	4 SPACES
EV CHARGERS INSTALLED PARKING	4 SPACES
FUTURE ELECTRIC PARKING	36 SPACES
TRUCK PARKING	46 SPACES
DOCK DOORS	20 POSITIONS
DOCK DOORS W/LEVELERS	10 POSITIONS
DRIVE-IN DOORS	2 POSITIONS
CLEAR HEIGHT	32 FT
DIVISIBILITY	2 TENANTS
COVERAGE	46.71%

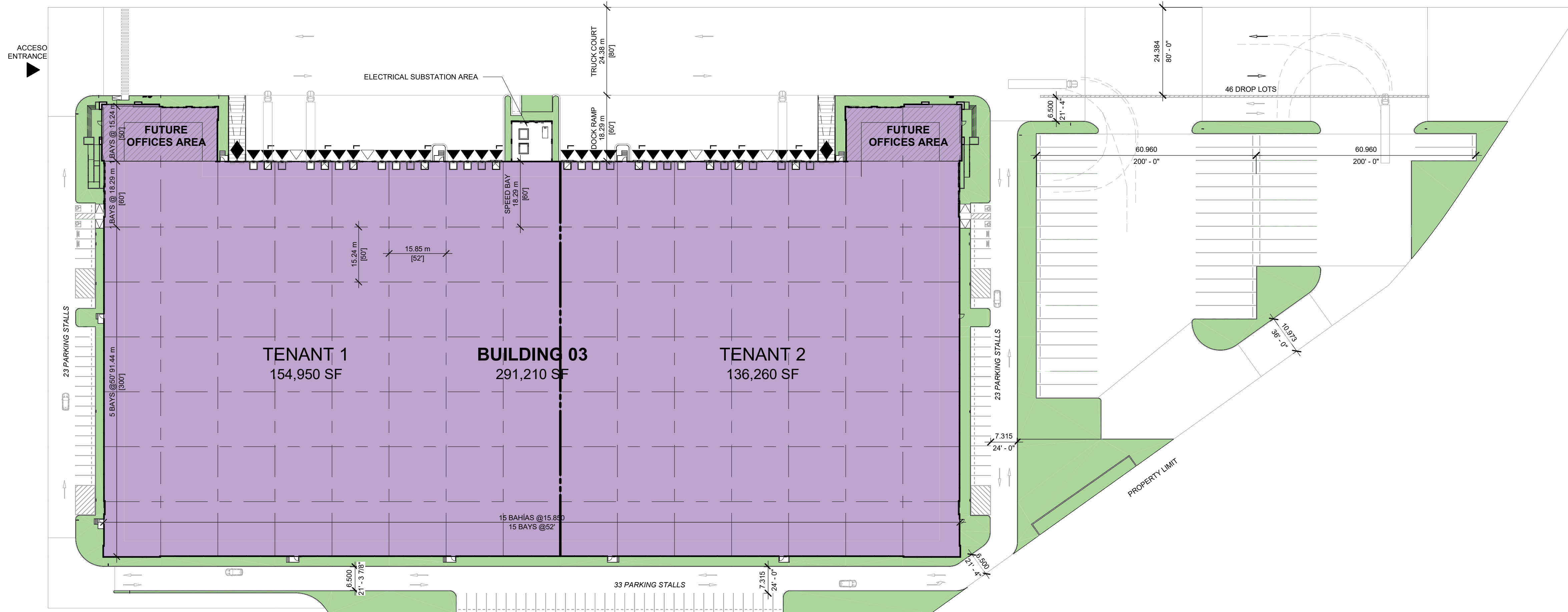

LEGEND:

- LEASED AREA
- AVAILABLE AREA
- CONSTRUCTION
- PLANNED
- BACKGROUND LAND
- ▶ DOCK POSITION
- ◀ DOCK POSITION W/ LEVELER
- ▷ FUTURE DOCK POSITION
- ◆ DRIVE-IN DOOR

NOTE:
THIS CONCEPTUAL PLAN IS FOR MARKETING PURPOSES ONLY AND HAS BEEN PREPARED BASED ON PRELIMINARY AVAILABLE SITE INFORMATION DEEMED RELIABLE. ALL DIMENSIONS AND AREA CALCULATIONS ARE SUBJECT TO VERIFICATION BY A PROFESSIONAL ENGINEER FOR COMPLIANCE WITH ALL FEDERAL, STATE AND LOCAL REGULATIONS.



PASEO DE LOS TAMARINDOS 90 TORRE 2
PISO 22 BOSQUES DE LAS LOMAS | CD.
MÉXICO 05120 MÉXICO
T: (55) 1105 2924



Punta Este Corporativo
Bld. Venustiano Carranza #951
Col. Rivera CP. 21259 Mexicali, B.C., Mexico