

**PROLOGIS
SOUTH BRUNSWICK**

30 TOWER ROAD
DAYTON, NEW JERSEY 08810

TOTAL FOOTPRINT:	234,000 S.F.
OFFICE:	12,718 S.F.
WAREHOUSE:	221,282 S.F.
PERCENTAGE OFFICE:	5.4%
CLEAR HEIGHT:	30'-0"
PARKING:	71 STALLS
DOCK-HIGH DOORS:	36
DRIVE-IN DOORS:	0
TYPICAL BAY:	42'-1" x 42'-0"

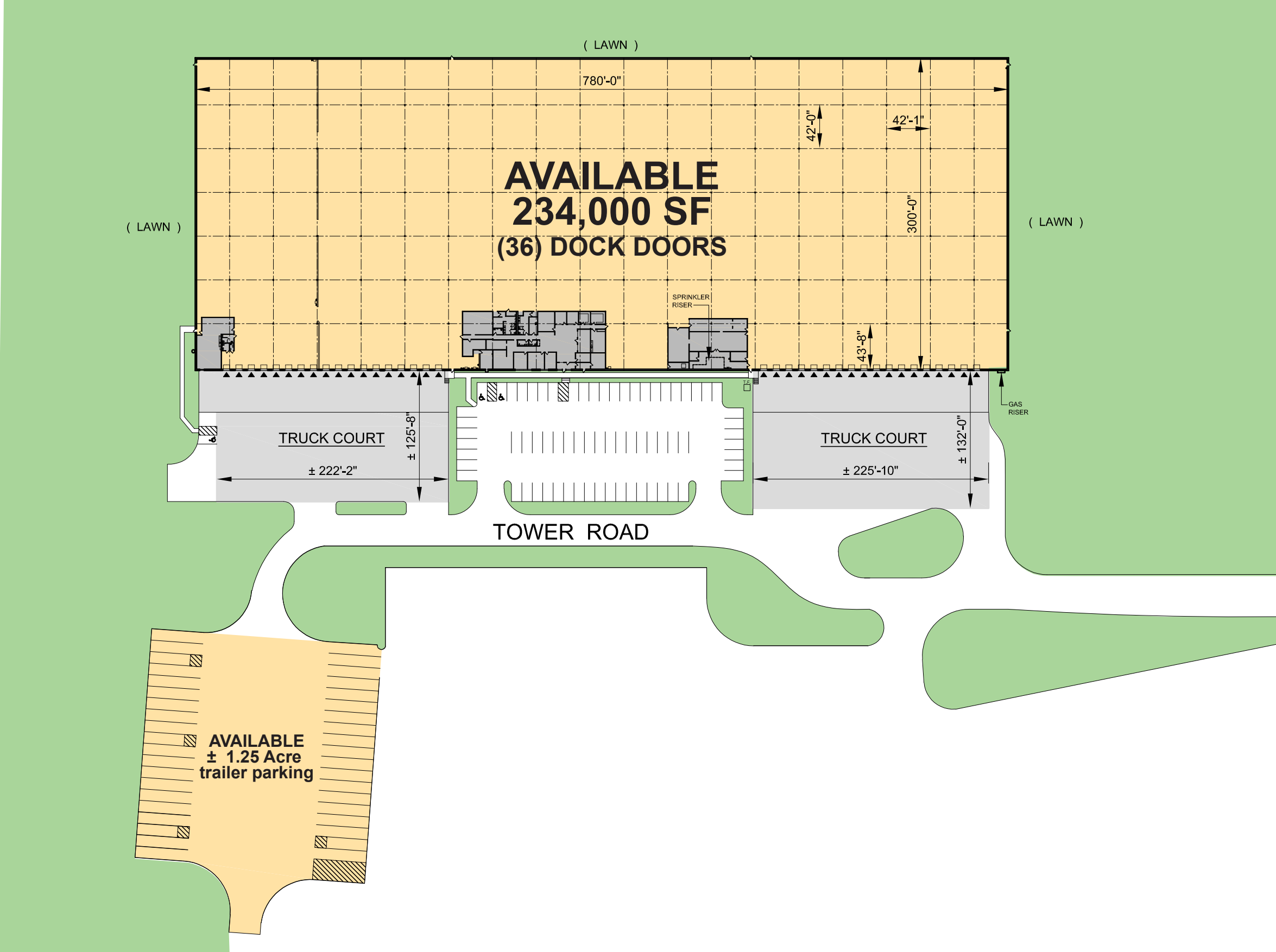



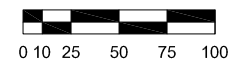

**AVAILABLE
234,000 SF
(36) DOCK DOORS**

**AVAILABLE
± 1.25 Acre
trailer parking**

TOWER ROAD



-  LAND
-  AVAILABLE
-  DOCK DOOR
-  DRIVE-IN DOOR



The above information/drawing is for reference only and is subject to verification, and/or revision. No liability for omissions shall be assumed. Area calculations are approximate and subject to change without notice.

COPYRIGHT 2024 PARETTE-SOMIEN ARCHITECTS L.L.C. - DATABESTUR 2024-11-04