

# 40,000 SF

## Industrial Space For Lease



### Prologis South Bay Industrial Center

1815 South Anderson Avenue  
Compton, CA 90220 USA



#### LOCATION

- Centrally Located South Bay Facility with proximity to the Ports of LA and LB, Downtown Los Angeles, and LAX
- Immediate Access to the 91 Freeway
- Close Proximity to the 110, 710 and 405 Freeways

#### FACILITY

- 40,000 SF Industrial Warehouse Facility
- 4,457 SF of Functional Office
- 22' Minimum Clear Height
- Three (3) Dock High Loading Positions
- Two (2) Ground Level Ramps
- Energy Efficient Lighting with Motion Detection
- 600 Amps, 120/208 Volts
- .33 gpm/4,500 sf Calculated Sprinkler System
- Private, Secure and Fenced Yard

#### ADVANTAGES AND AMENITIES

- Professionally Managed Business Park Environment

# 40,000 SF

## Industrial Space For Lease

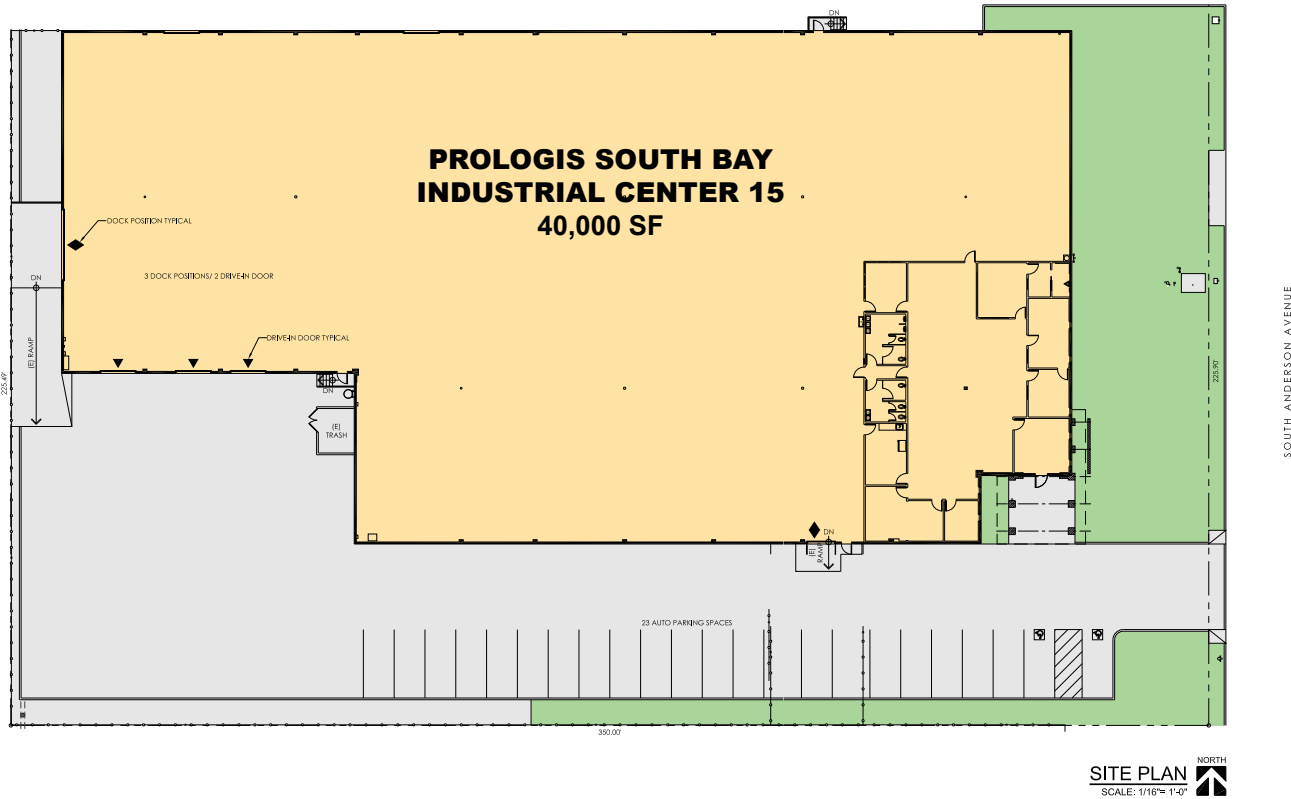

## NEWMARK

### Newmark

**Danny Williams, SIOR** | CA RE Lic#01776416  
danny.williams@nmrk.com  
ph +1 310 491 2061  
cell +1 310 347 5759  
2301 Rosecrans Avenue  
Suite 4100  
El Segundo, CA 90245 USA

### Newmark

**Barry Hill, SIOR** | CA RE Lic#01250531  
barry.hill@nmrk.com  
ph +1 310 491 2026  
cell +1 310 619 5600  
2301 Rosecrans Avenue  
Suite 4100  
El Segundo, CA 90245 USA

### Newmark

**Tom Patten** | CA RE Lic#02031131  
tom.patten@nmrk.com  
ph +1 310 491 2076  
cell +1 949 275 7786  
2301 Rosecrans Avenue  
Suite 4100  
El Segundo, CA 90245 USA

### Prologis

**Lisa Reddy** | CA RE Lic#01327922  
LReddy@prologis.com  
ph +1 562 345 9206  
2141 Rosecrans Avenue  
Suite 1151  
El Segundo, CA 90245 USA