

# 253,410 SF

Industrial Space For Lease



## Prologis Des Plaines



255 Wille Road  
Des Plaines, IL 60804 USA

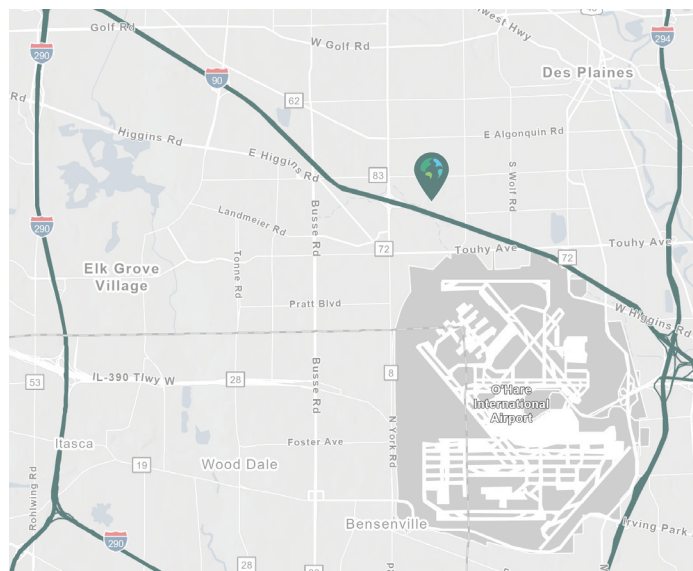

### LOCATION

- Immediate access to I-90 via 4-way interchange at Elmhurst Road
- Proximity to O'Hare International Airport and the North Air Cargo entrance

### FACILITY

- 253,410 SF building
- 253,410 SF available
- 18,216 SF office
- 30'-6" clear height
- 2,000 amps, 277/480 volt 3-phase power
- 55 exterior docks
- 4 drive-in doors
- 208 auto parking stalls
- 42 trailer parking stalls (expandable to 70)

### ADVANTAGES AND AMENITIES

- Tollway visibility
- Highly visible frontage on I-90
- Secured truck court and parking

**Prologis Essentials: Your single-source service for efficient move-in and operations: [prologisessentials.com](https://www.prologisessentials.com)**

# 253,410 SF

Industrial Space For Lease



## Prologis Des Plaines

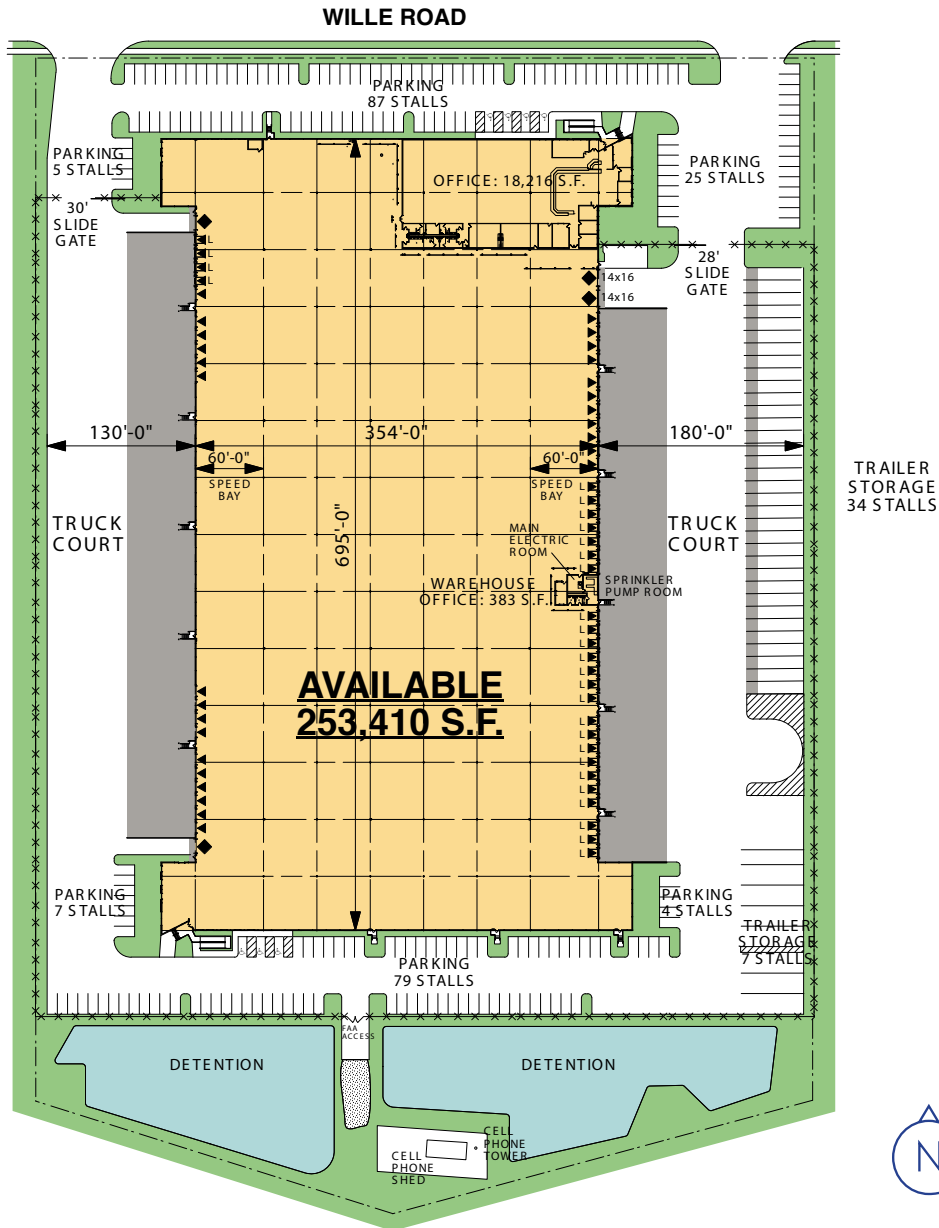

**Colliers**  
Thomas Rodeno  
tom.rodeno@colliers.com  
ph +1 847 698 8231  
cell +1 773 230 2596  
6250 N. River Road  
Suite 11-100  
Rosemont, IL 60018 USA

**Colliers**  
David Bercu, SIOR  
david.bercu@colliers.com  
ph +1 847 698 8207  
cell +1 847 721 6011  
6250 N. River Road  
Suite 11-100  
Rosemont, IL 60018 USA



**Prologis**  
Ana Rovito  
arovito@prologis.com  
ph +1 847 292 3850  
6250 N. River Road  
Suite 1100  
Rosemont, IL 60018 USA

**Prologis Essentials: Your single-source service for efficient move-in and operations: [prologisessentials.com](http://prologisessentials.com)**

No warranty or representation, expressed or implied, is made as to the accuracy of the information contained herein, and same is submitted subject to error and omissions.

# 253,410 SF

Industrial Space For Lease



## Prologis Des Plaines

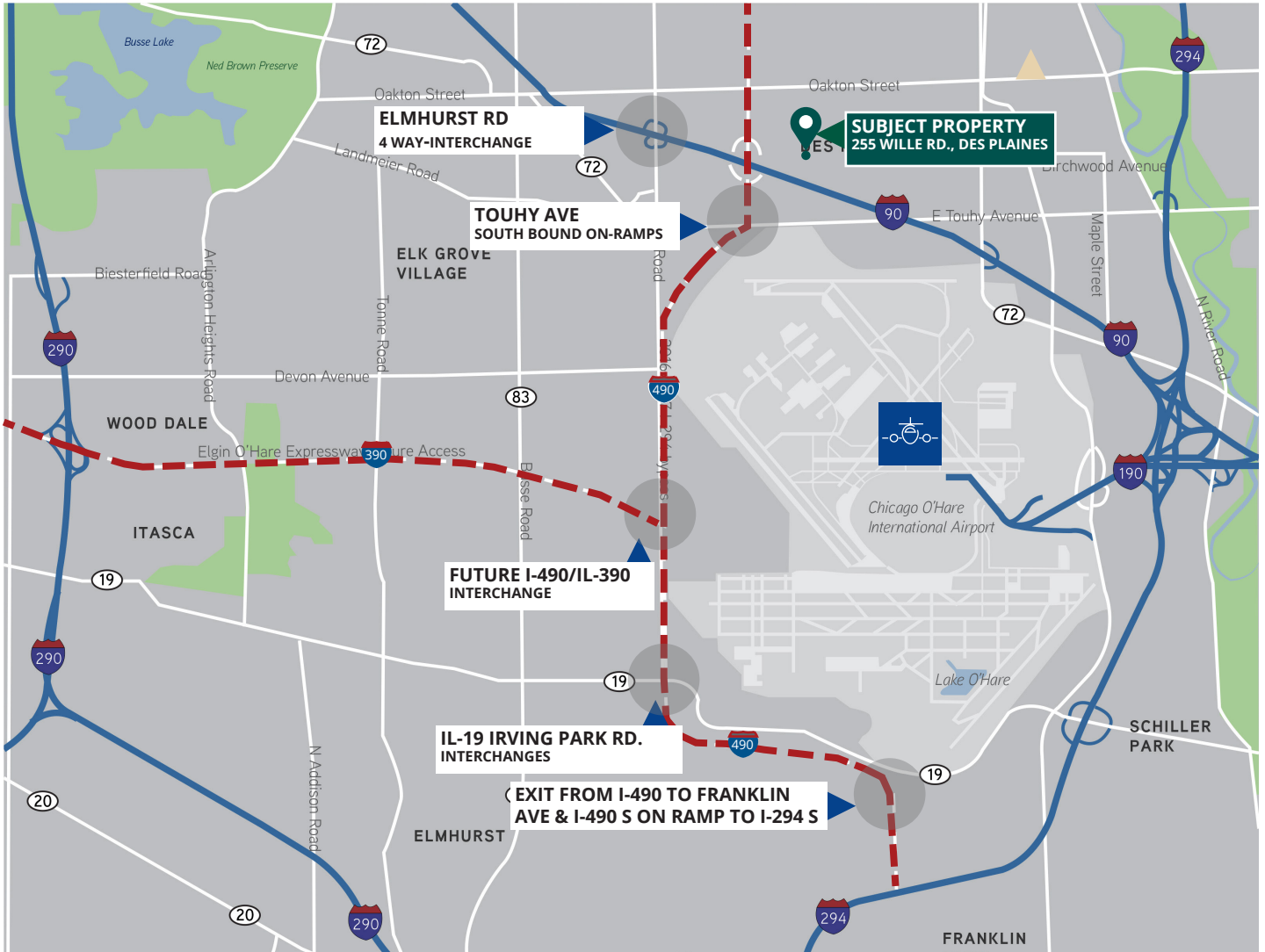

**Colliers**

Thomas Rodeno  
tom.rodeno@colliers.com  
ph +1 847 698 8231  
cell +1 773 230 2596  
6250 N. River Road  
Suite 11-100  
Rosemont, IL 60018 USA

**Colliers**

David Bercu, SIOR  
david.bercu@colliers.com  
ph +1 847 698 8207  
cell +1 847 721 6011  
6250 N. River Road  
Suite 11-100  
Rosemont, IL 60018 USA

**Prologis**

Ana Rovito  
arovito@prologis.com  
ph +1 847 292 3850  
6250 N. River Road  
Suite 1100  
Rosemont, IL 60018 USA

**Prologis Essentials: Your single-source service for efficient move-in and operations: [prologisessentials.com](http://prologisessentials.com)**

No warranty or representation, expressed or implied, is made as to the accuracy of the information contained herein, and same is submitted subject to error and omissions.