

±206,483 SF



## Prologis South Bay Industrial Center



250 W Manville St.  
Compton, CA 90220

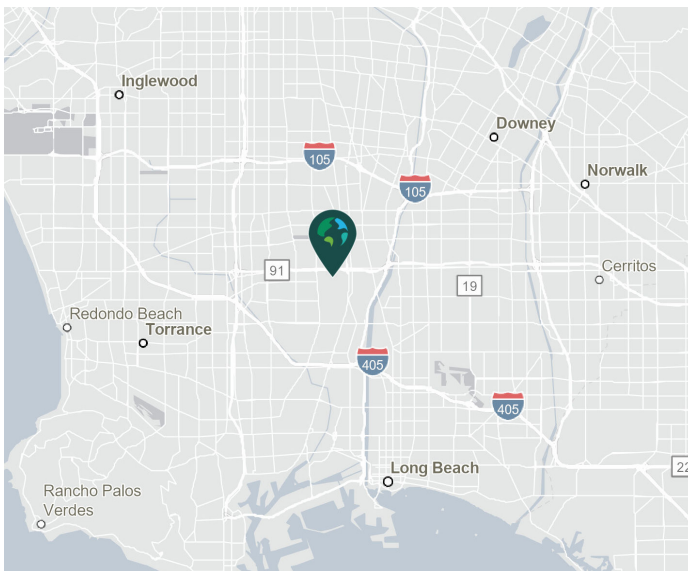

### LOCATION

- Direct Access to 91, 105, 110 & 405 Freeways
- 11.2 Miles to Ports of LA & LB
- 16.8 Miles to LAX

### FACILITY

- ±206,483 SF Available
- ±20,466 SF Office Area
- 22' Clear Height
- 27 Dock High Positions and 2 Ground Level Doors
- Large Secured Yard
- .33 gpm/3,000 sf Calculated Sprinkler System
- 1600 Amps, 277/480 Volts Electrical Power
- Large Secured Yard

### ADVANTAGES AND AMENITIES

- 27 Dock High Loading Positions
- Proximity to World Ports of Los Angeles and Long Beach

Your single-source service for efficient move-in and operations: [prologisessentials.com](https://www.prologisessentials.com)

±206,483 SF



# Prologis South Bay Industrial Center

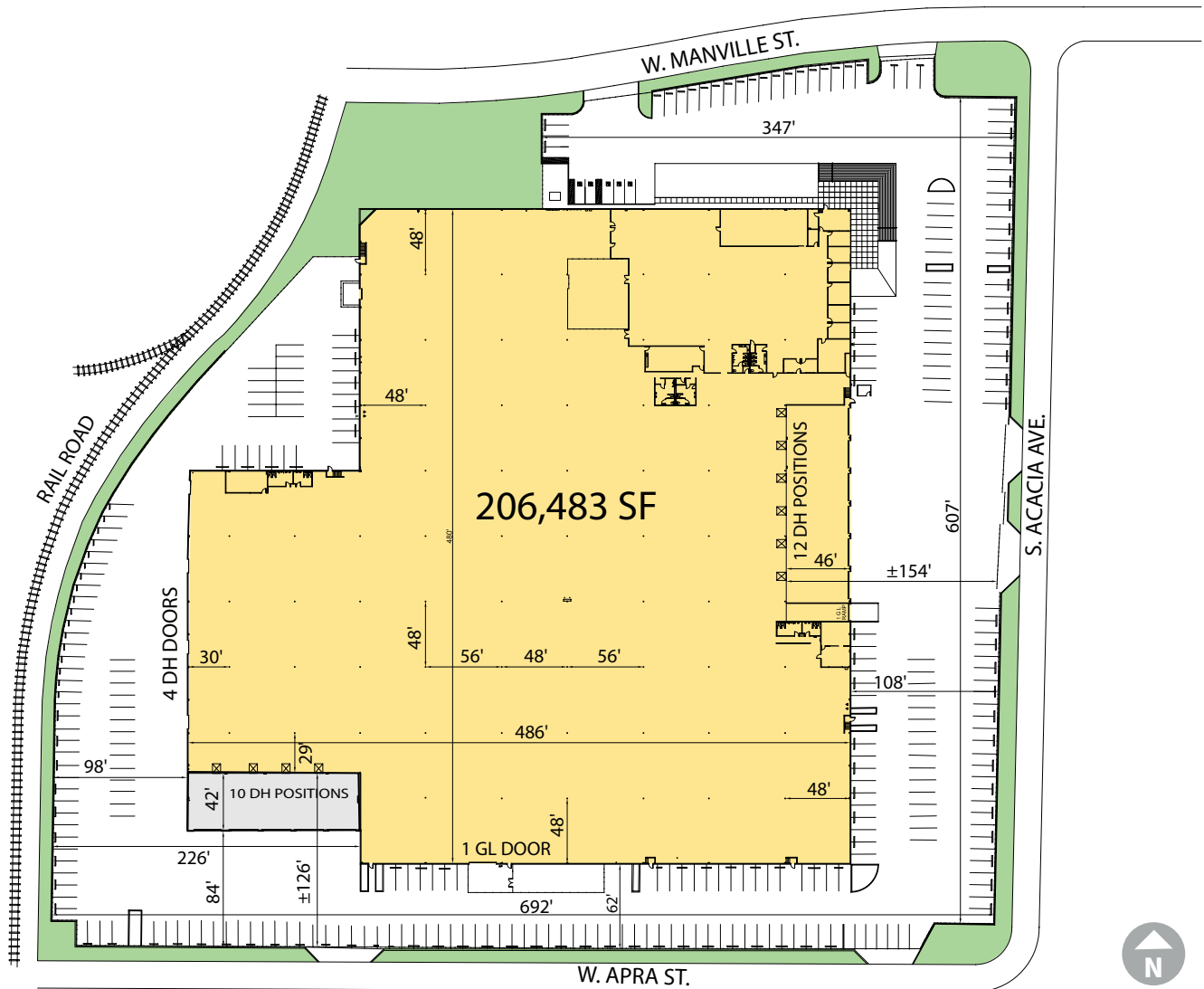

**John Schumacher**  
Executive Vice President  
+1 310 489 1439  
john.schumacher@cbre.com  
Lic. 00987225  
2221 Rosecrans Ave, Ste 100  
El Segundo, CA 90245 USA

**Bret Quinlan**  
Executive Vice President  
+1 310 408 8696  
bret.quinlan@cbre.com  
Lic. 01144338  
2221 Rosecrans Ave, Ste 100

**James Hooks**  
Senior Vice President  
+1 310 897 1798  
james.hooks@cbre.com  
Lic. 01813302  
2221 Rosecrans Ave, Ste 100  
El Segundo, CA 90245 USA

**Prologis**  
Lisa Reddy  
+1 562 345 9206  
lreddy@prologis.com  
Lic. 01327922  
2141 Rosecrans Ave, Ste 1151