

# 21,840 SF

Industrial Space For Lease



## Prologis Northpark 10



100 Northpark Central Drive, Suite 300  
Houston, TX 77073 USA

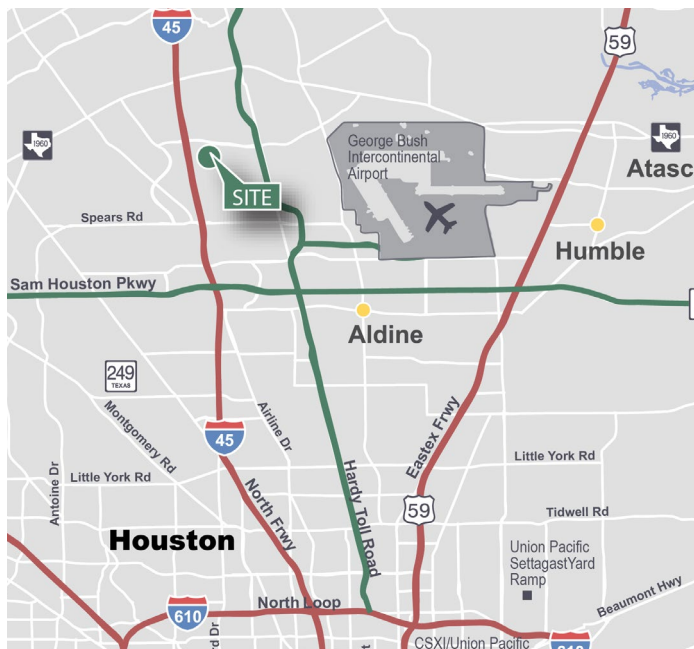

### LOCATION

- Conveniently located along I-45 North between Airtex Drive and Richey Road
- Easy access to I-45, Beltway 8 and the Hardy Toll Road
- Unincorporated Harris County
- Double Freeport tax exemption

### FACILITY

- 21,840 SF available
- 4,768 SF of office
- 24' clear height
- 7 dock doors / 1 drive-in ramp
- 52' x 45' column spacing

### ADVANTAGES AND AMENITIES

- Part of the master planned Prologis Park Northpark
- Rear-load building
- 100% HVAC space
- ESFR sprinklers
- Fenced truck court

**Prologis Essentials: your single-source service for efficient move-in and operations at [prologisessentials.com](https://www.prologisessentials.com)**

# 21,840 SF

Industrial Space For Lease



## Prologis Northpark 10

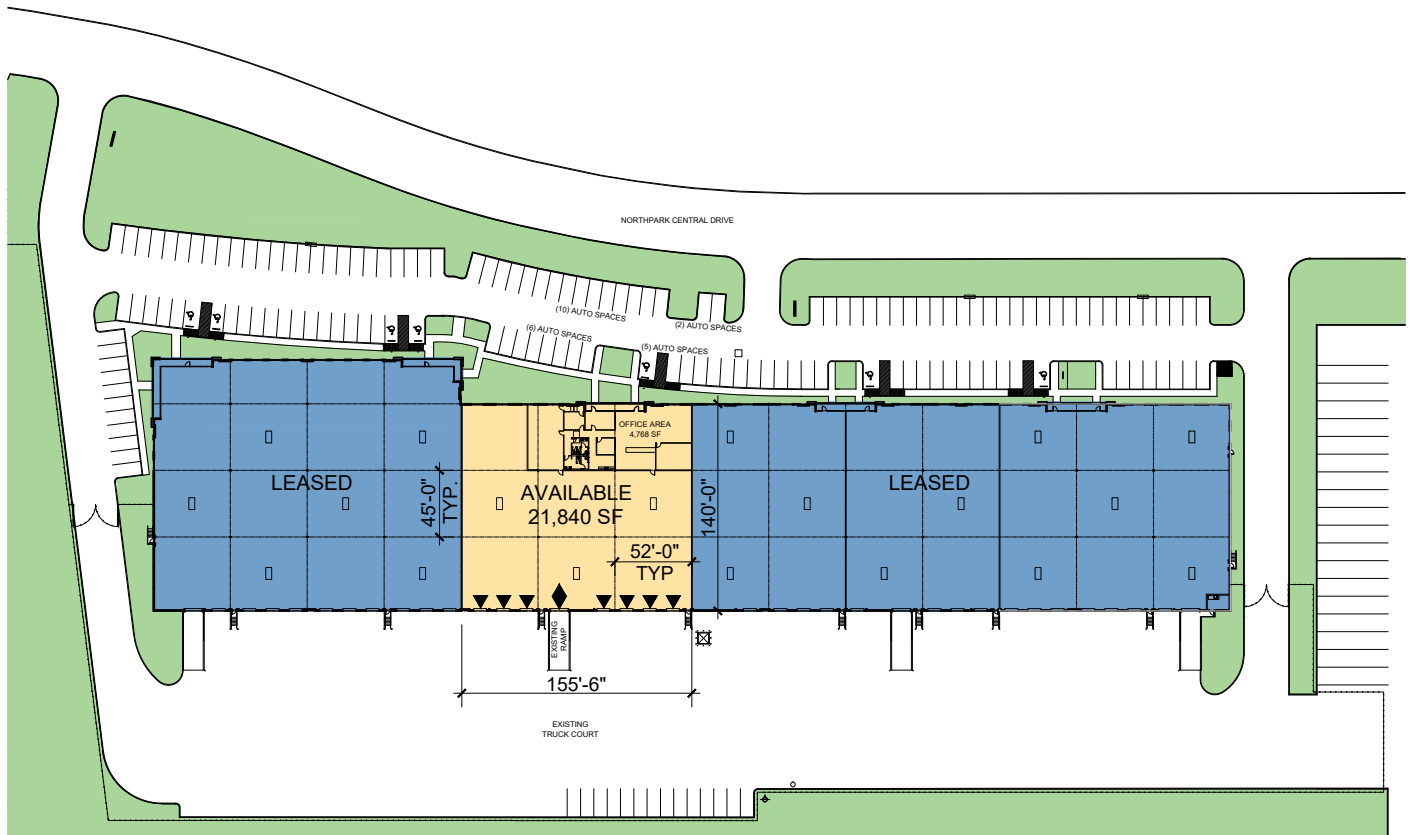

## CBRE

### CBRE

Jason Dillee  
Jason.Dillee@cbre.com  
ph +1 713 577 1796  
cell +1 832 741 0733  
2800 Post Oak Blvd., Suite 500  
Houston, TX 77056 USA

### CBRE

Nathan Wynne  
Nathan.Wynne@cbre.com  
ph +1 713 577 1724  
cell +1 713 206 3881  
2800 Post Oak Blvd., Suite 500  
Houston, TX 77056 USA

### CBRE

Nick Bergmann  
Nick.Bergmann@cbre.com  
ph +1 713 577 1772  
cell +1 713 301 0024  
2800 Post Oak Blvd., Suite 500  
Houston, TX 77056 USA

### Prologis

Adam Bray  
abray@prologis.com  
ph +1 281 517 2514  
cell +1 713 202 7699  
9655 Katy Freeway, Suite 400  
Houston, TX 77024 USA

**Prologis Essentials: your single-source service for efficient move-in and operations at [prologisessentials.com](http://prologisessentials.com)**

No warranty or representation, expressed or implied, is made as to the accuracy of the information contained herein, and same is submitted subject to error and omissions.