

# 27,500 SF

Industrial Space For Lease



## Prologis Park Kingsport 3



19613 81<sup>st</sup> Avenue South  
Kent, Washington 98032 USA

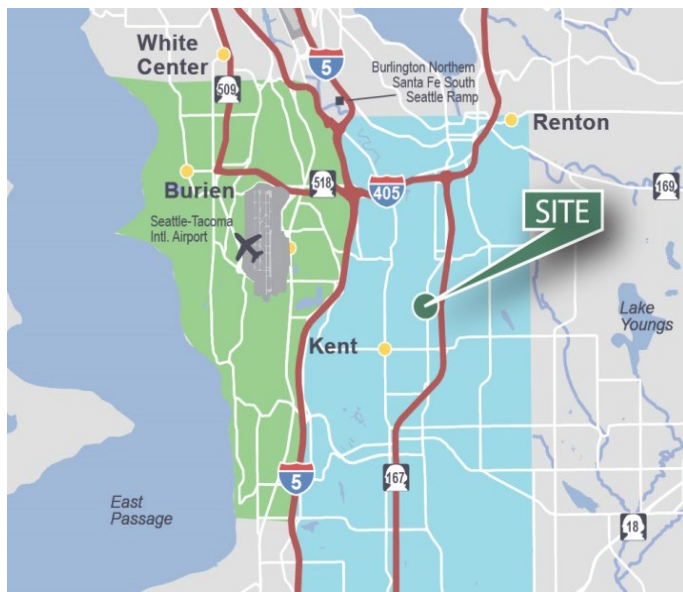

### LOCATION

- Excellent North Kent Valley location
- Quick Access to SR-167 and I-5
- Prominent frontage on S. 196<sup>th</sup> St.

### FACILITY

- ±27,500 square feet
- ± 996 square feet of office (Up to an additional ±8,732 SF of office available directly adjacent to the premises.)
- ± 20' clear height
- 6 dock-high doors
- 2 drive-in doors
- ± 100' deep x 275' wide
- ± 50' x 25' typical column spacing
- Upgraded sprinklers
- Available 6/1/2024

### ADVANTAGES AND AMENITIES

- Access to the Prologis Essentials platform

**Your single-source service for efficient move-in and operations: [prologisessentials.com](https://prologisessentials.com)**

# 27,500 SF

## Industrial Space For Lease



### Prologis Park Kingsport 3

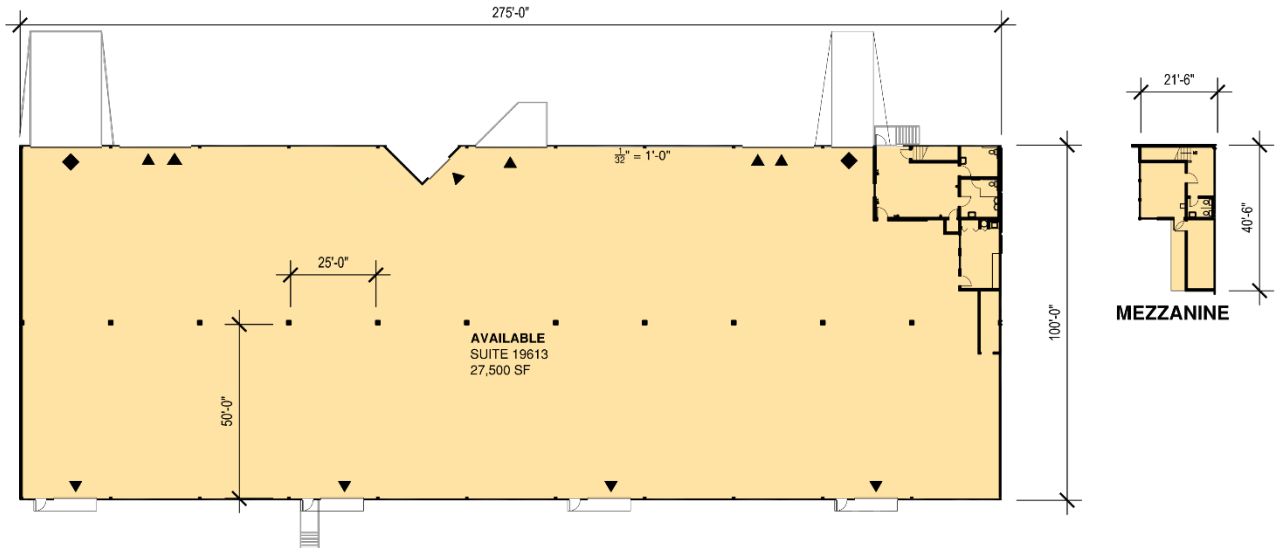

**SUITE 19613**

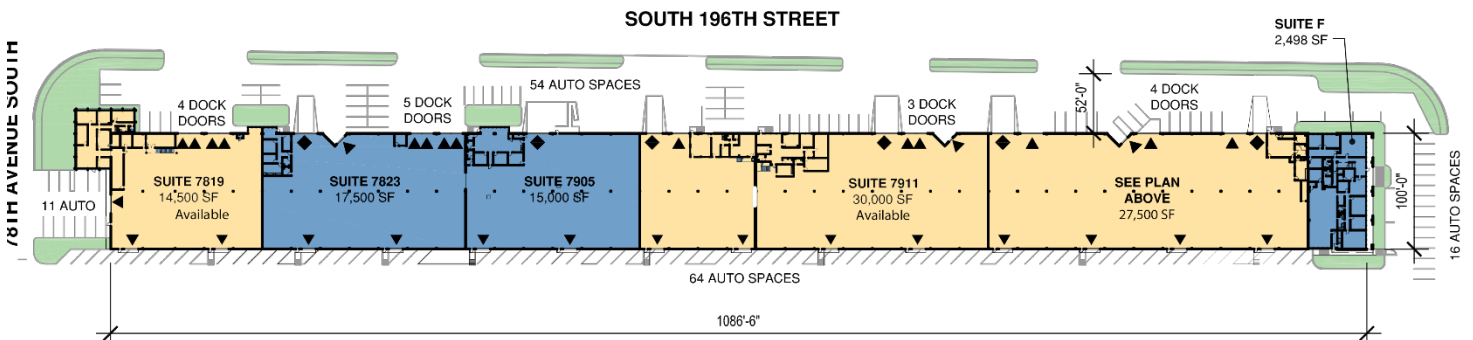

**SITE PLAN**  
NTS



#### WA-REA

Wilma Warshak, SIOR  
wilma.warshak@wa-rea.com  
ph +1 206 838 5492  
cell +1 206 409 1432  
2371 Eastlake Ave. East  
Suite 200  
Seattle, WA 98102 USA

#### WA-REA

Alana Garrett  
alana.garrett@wa-rea.com  
ph +1 206 838 5492  
cell +1 858 722 5627  
2371 Eastlake Ave. East  
Suite 200  
Seattle, WA 98102 USA

#### WA-REA

Jackson Peterson  
jackson.peterson@wa-rea.com  
ph +1 206 838 5492  
cell +1 503 739 1830  
2371 Eastlake Ave. East  
Suite 200  
Seattle, WA 98102 USA

#### Prologis

Lucca Merlino  
lmerlino@prologis.com  
ph +1 206 414 7621  
cell +1 206 498 6511  
5900 Airport Way South  
Suite 300  
Seattle, WA 98108 USA