

# 6,124 SF

## Industrial Space For Lease



### Prologis West Orange County Business Center



7220 Fenwick Lane

Westminster, CA 92683

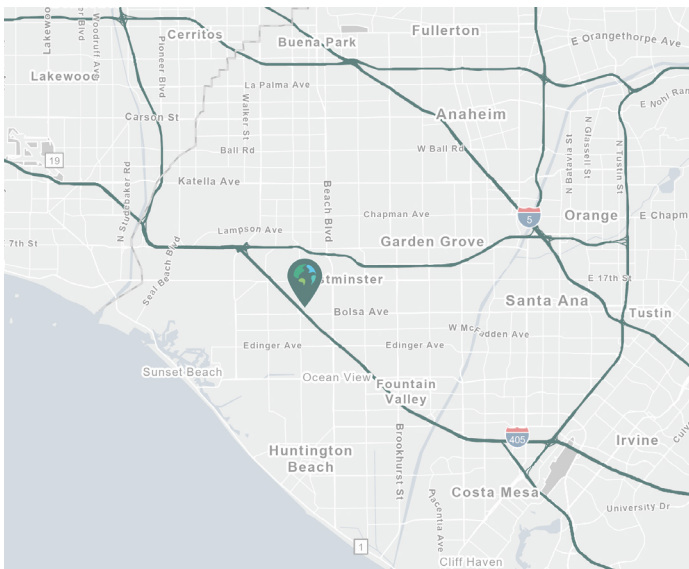

#### LOCATION

- Immediate access to the 405 Freeway
- Strategic West Orange County location with skilled and diversified work force
- Close to retail/dining amenities at the Westminster Mall and Bella Terra
- Part of a larger 265,678 s.f. professionally managed business park

#### FACILITY

- ±15,511 square foot building
- ±6,124 square feet available
- ±516 square feet of single-story office space
- 1 ground-level loading door (12' x 14')
- 16'-6" warehouse clearance
- 400 Amps, 120/208 volts (to be verified)
- .33 gpm/3,000 s.f. calculated fire sprinkler system
- ±1.25 parking spaces per 1,000 s.f.
- LED lighting in warehouse

#### ADVANTAGES AND AMENITIES

- Access to the Prologis Essentials platform, which includes:
  - [Operations Essentials](#)
  - [Energy Essentials](#)
  - [Workforce Essentials](#)
  - [Mobility Essentials](#)
  - [Digital Essentials](#)

[www.prologis.com](http://www.prologis.com)

Your single-source service for efficient move-in and operations: [prologisessentials.com](http://prologisessentials.com)

# 6,124 SF

Industrial Space For Lease



## Prologis West Orange County Business Center

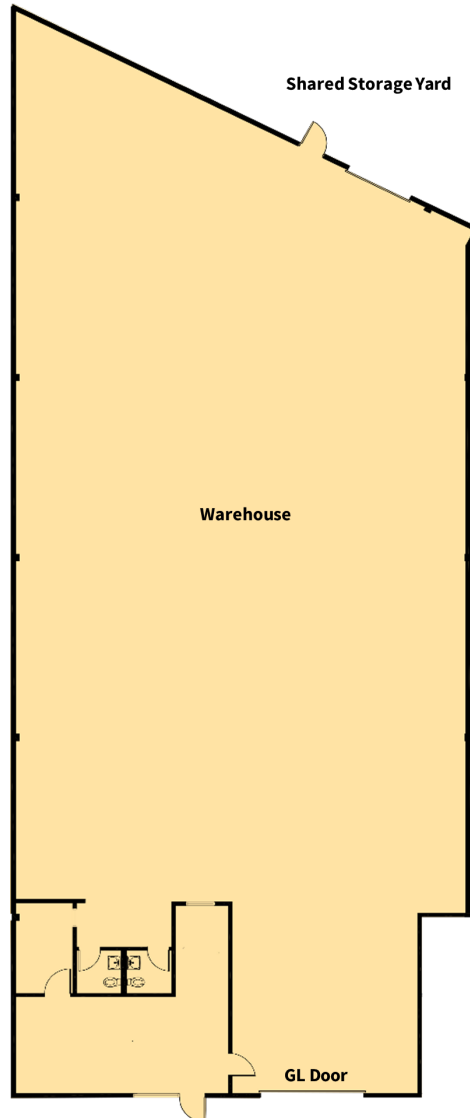

### JLL

Steve Wagner  
License #01314652  
steve.wagner@jll.com  
+1 949 885 2923  
17877 Von Karman Ave.,  
Suite 500  
Irvine, CA 92614  
www.jll.com

### JLL

Louis Tomaselli  
License #00904844  
louis.tomaselli@jll.com  
+1 949 885 2985  
17877 Von Karman Ave.,  
Suite 500  
Irvine, CA 92614  
www.jll.com

### JLL

Zach Niles  
License #01311756  
zach.niles@jll.com  
+1 949 885 2922  
17877 Von Karman Ave.,  
Suite 500  
Irvine, CA 92614  
www.jll.com

### Prologis

Parker Hutchison  
License #01875578  
phutchison@prologis.com  
+1 562 345 9209  
17777 Center Court Dr N.,  
Suite 100  
Cerritos, CA 90703  
www.prologis.com