

10,457 SF

Industrial Space For Lease



Prologis Camp Creek



2400 Centre Parkway, Suite 106
East Point, Georgia 30344 USA

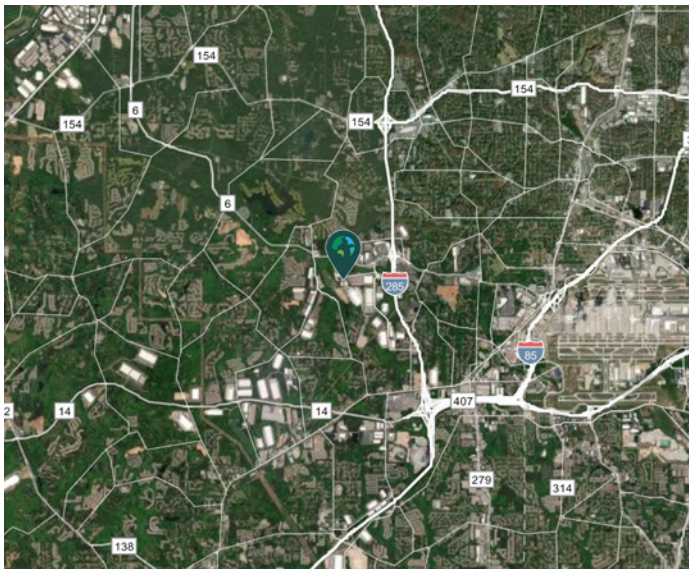

Scan the QR code for more info!

LOCATION

- ± 1.4 miles I-285
- ± 6.0 miles I-85
- ± 7.7 miles from Hartsfield-Jackson Atlanta International Airport, the nation's busiest airport
- ± 9.6 miles I-20
- ± 11.4 miles I-75

FACILITY

- 61,820 SF building
- 10,457 SF available
 - 7,474 SF office
- 20' minimum clear height
- One (1) dock door with ability to add three (3) additional doors
- Twenty-one (21) auto spaces
- Power: 277/480V, 500 amps

ADVANTAGES AND AMENITIES

- Access to the Prologis Essentials platform, which includes:
 - [Operations Essentials](#)
 - [Energy Essentials](#)
 - [Workforce Essentials](#)
 - [Mobility Essentials](#)
 - [Digital Essentials](#)

Your single-source service for efficient move-in and operations: [prologisessentials.com](https://www.prologisessentials.com)

www.prologis.com

10,457 SF

Industrial Space For Lease



Prologis Camp Creek

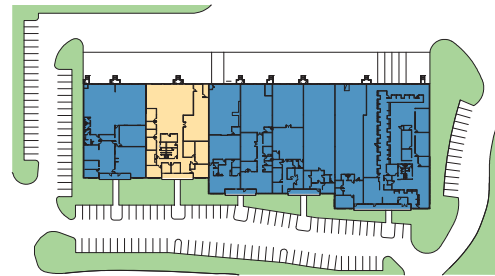
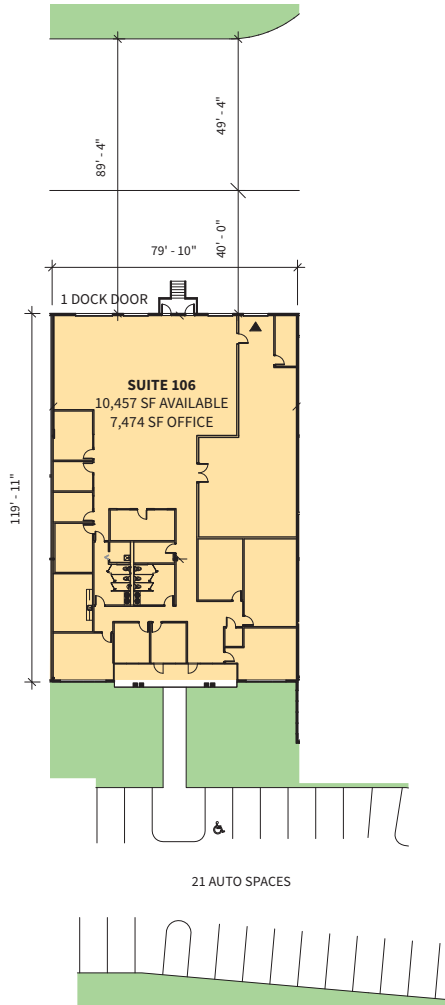

KEY PLAN

LEGEND:

- ▲ DOCK DOOR
- ▲ DOCK DOOR W/LEVELER
- ◆ DRIVE-IN DOOR
- ▲ ON-GRADE DOOR
- ▨ EDGE OF DOCK
- ▽ PIT LEVELER
- LAND
- LEASED AREA
- VACANT AREA



Seefried Industrial

Joseph Kriss

josephk@seefriedproperties.com
ph +1 404 233 0204
cell +1 678 362 4641
3333 Riverwood Parkway SE
Suite 200
Atlanta, GA 30339 USA

Seefried Industrial

Tripp Ausband

tausband@seefriedproperties.com
ph +1 404 233 0204
cell +1 770 825 3391
3333 Riverwood Parkway SE
Suite 200
Atlanta, GA 30339 USA

Prologis

Sarah Stafford

sstafford@prologis.com
ph +1 404 760 7214
cell +1 404 561 8378
3475 Piedmont Road NE
Suite 650
Atlanta, GA 30305 USA