

# 23,000 SF

## Industrial Space For Lease



## Prologis Schiller Park

4310 Transworld Road  
Schiller Park, IL 60176 USA

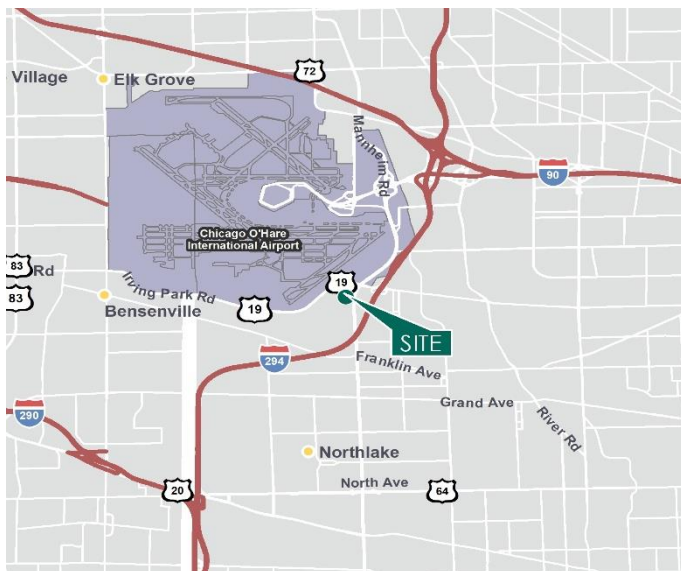

### LOCATION

- Close proximity to O'Hare International Airport
- Excellent access to I-294 and I-90
- 19 miles to downtown Chicago

### FACILITY

- 23,000 SF available
- 4,814 SF office space
- 18' clear height
- 2 interior docks
- 1 drive in door
- 34'0" x 41'6" column spacing
- Power – 200 amps/480 volts
- 26 car parking stalls

### ADVANTAGES AND AMENITIES

- Easily accessible to strong labor pool and public transportation
- Great end unit

# 23,000 SF

## Industrial Space For Lease

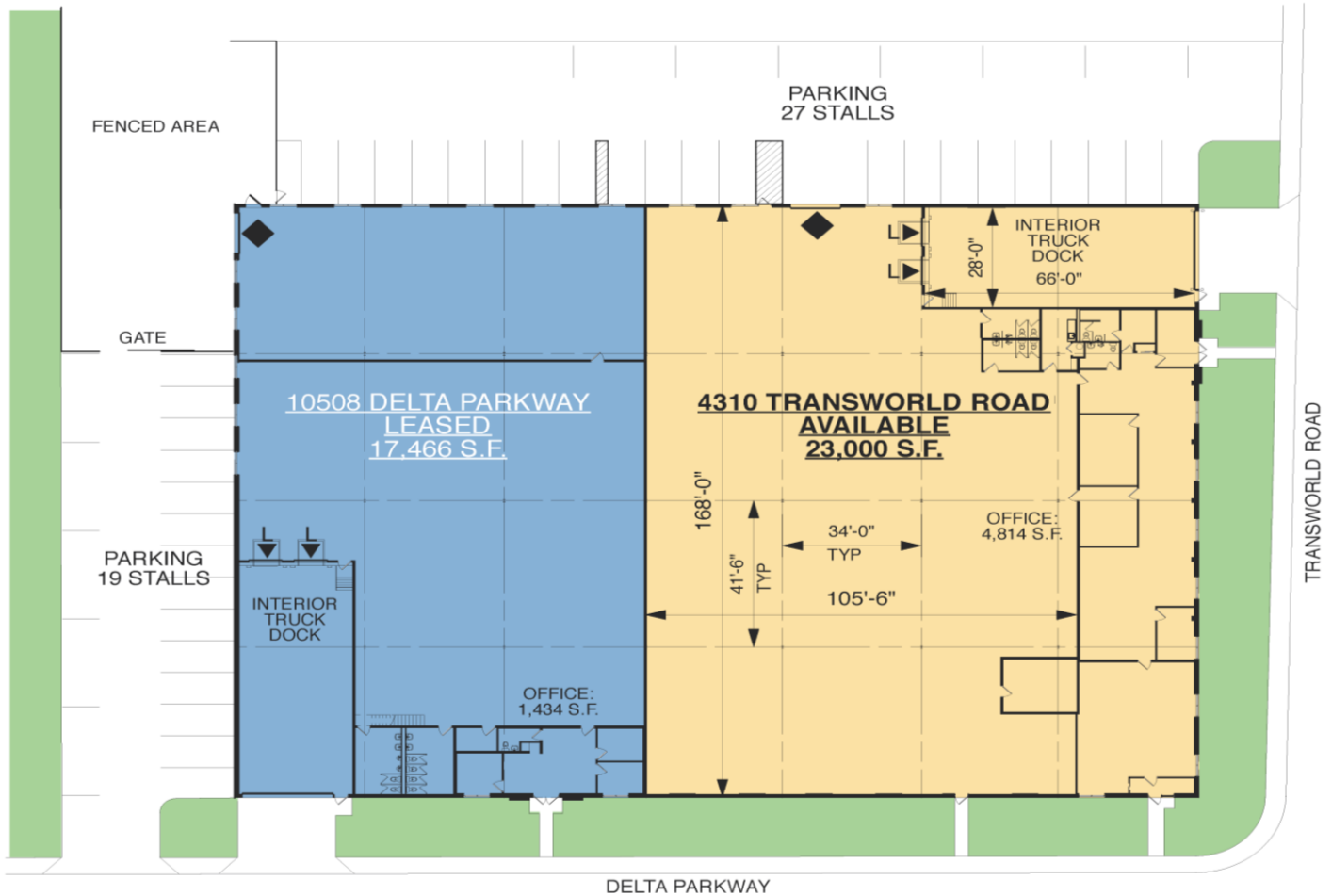

### Cushman & Wakefield

**Matt Cowie**

Matt.cowie@cushwake.com  
ph +1 312 470 1872  
cell +1 312 735 6510  
225 W Wacker Drive  
Suite 3000  
Chicago, IL 60606 USA

### Cushman & Wakefield

**Colin Green**

Colin.green@cushwake.com  
ph +1 312 470 2322  
cell +1 630 272 9968  
225 W Wacker Drive  
Suite 3000  
Chicago, IL 60606 USA

### Cushman & Wakefield

**Larry Goldwasser, SIOR**

Larry.goldwasser@cushwake.com  
ph +1 312 470 2323  
cell +1 312 953 5744  
225 W Wacker Drive  
Suite 3000  
Chicago, IL 60606 USA

### Prologis

**Maggie Tullier | Leasing Associate**

mtullier@prologis.com  
ph +1 847 292 3943  
cell +1 847 420 4145  
6250 N River Road  
Suite 1100  
Rosemont, IL 60018 USA