

55,385 SF

Industrial Space For Lease



Prologis Binz-Engleman 2



4036 Binz Engleman Road, Suite 208
San Antonio, TX 78219 USA

LOCATION

- Great access to IH 35 N and Loop 410 in northeast San Antonio
- Located adjacent to Fort Sam Houston and San Antonio Military Medical Center

FACILITY

- 55,385 sf available
- 7,164 sf office
- 24' clear height
- 40' x 40' column spacing
- 8 dock high doors, 5 with pit levelers
- 1 drive-in door
- ESFR sprinkler system

ADVANTAGES AND AMENITIES

- Rear load configuration
- Heavy power
- Partially conditioned warehouse
- Access to the [Prologis Essentials](#) platform, which includes:
 - [Operations Essentials](#)
 - [Energy + Sustainability Essentials](#)
 - [Mobility Essentials](#)
 - [Workforce Essentials](#)

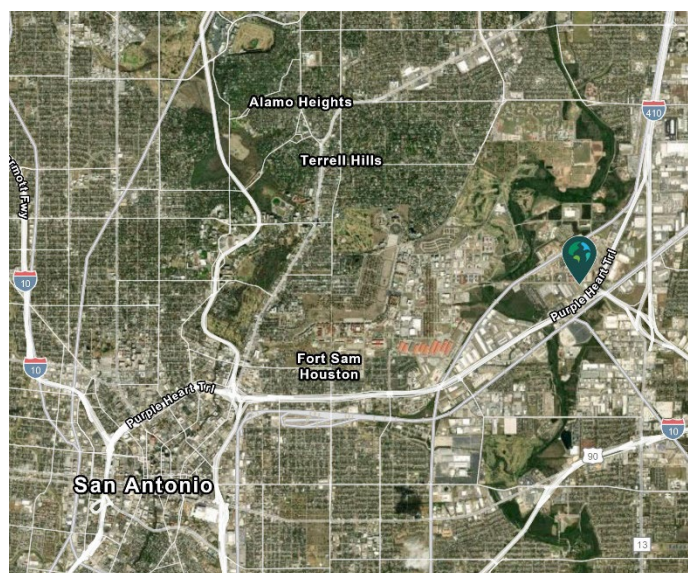

Your single-source service for efficient move-in and operations: [prologisessentials.com](https://www.prologisessentials.com)

55,385 SF

Industrial Space For Lease



Prologis Binz-Engleman 2

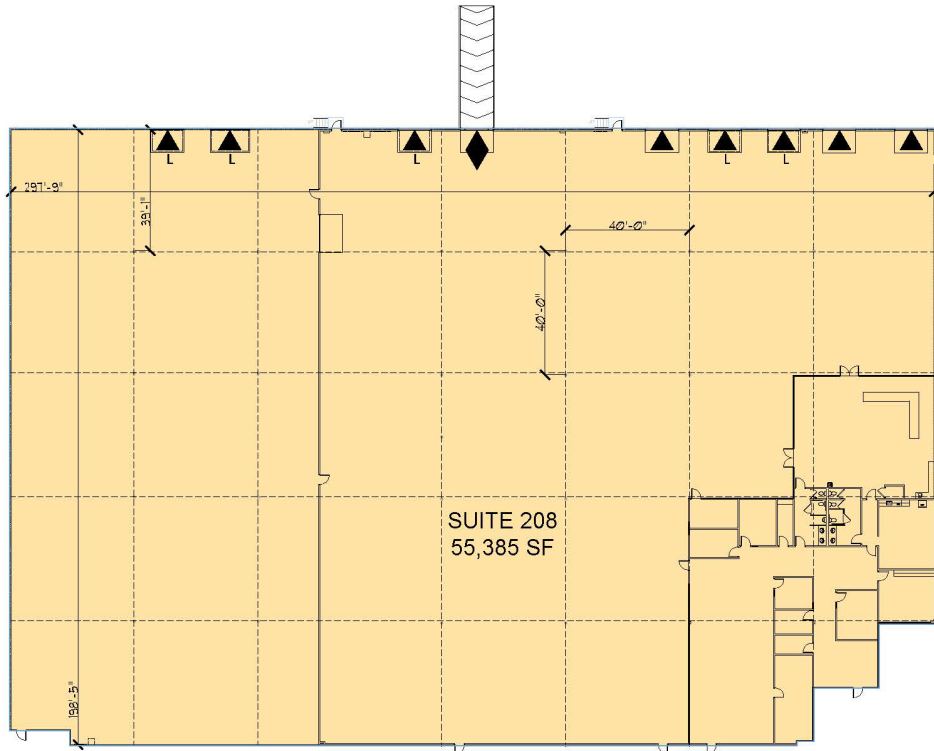

8 DOCK DOORS
1 RAMP



CBRE, Inc.

Rob Burlingame
rob.burlingame@cbre.com
ph +1 210 507 1123
cell +1 210 885 3730
1803 Broadway
Suite 825
San Antonio, TX 78215 USA

CBRE, Inc.

Joshua Aguilar
Joshua.aguilar@cbre.com
ph +1 210 253 6049
cell +1 915 740 0556
1803 Broadway
Suite 825
San Antonio, TX 78215 USA

CBRE, Inc.

Brad O'Neill
Brad.oneill@cbre.com
ph +1 210 253 6070
cell +1 915 373 3467
1803 Broadway
Suite 825
San Antonio, TX 78215 USA

Prologis

Whitney Williamson
wwilliamson@prologis.com
ph +1 972 884 9244
cell +1 817 781 5186
200 E Grayson Street
Suite 116
San Antonio, TX 78215 USA