

429,756 SF (Divisible)



Industrial Space For Lease

Prologis North Aurora



300 N Mitchell Road
North Aurora, IL 60542

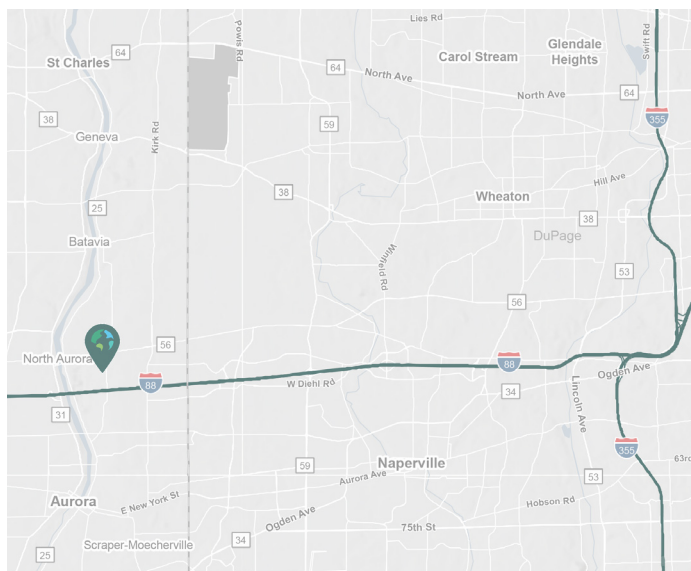

LOCATION

- Immediate access to the full interchange at Farnsworth & I-88

FACILITY

- 429,756 SF available (divisible)
- 6,275 SF office
- 1,230 SF warehouse office
- 36' clear height
- 48 exterior docks
- 4 drive in doors
- 84 trailer parking stalls
- 130' and 180' trailer courts
- 246 car parking stalls
- 52' x 54' column spacing with typical 75' speed bay
- ESFR sprinkler system
- 3700A / 480V

ADVANTAGES AND AMENITIES

- Move-in ready unit in institutionally-owned facility
- Established business park setting
- Low Kane County taxes

Prologis Essentials: your single-source service for efficient move-in and operations at [prologisessentials.com](https://www.prologisessentials.com)

429,756 SF (Divisible)



Industrial Space For Lease

Prologis North Aurora

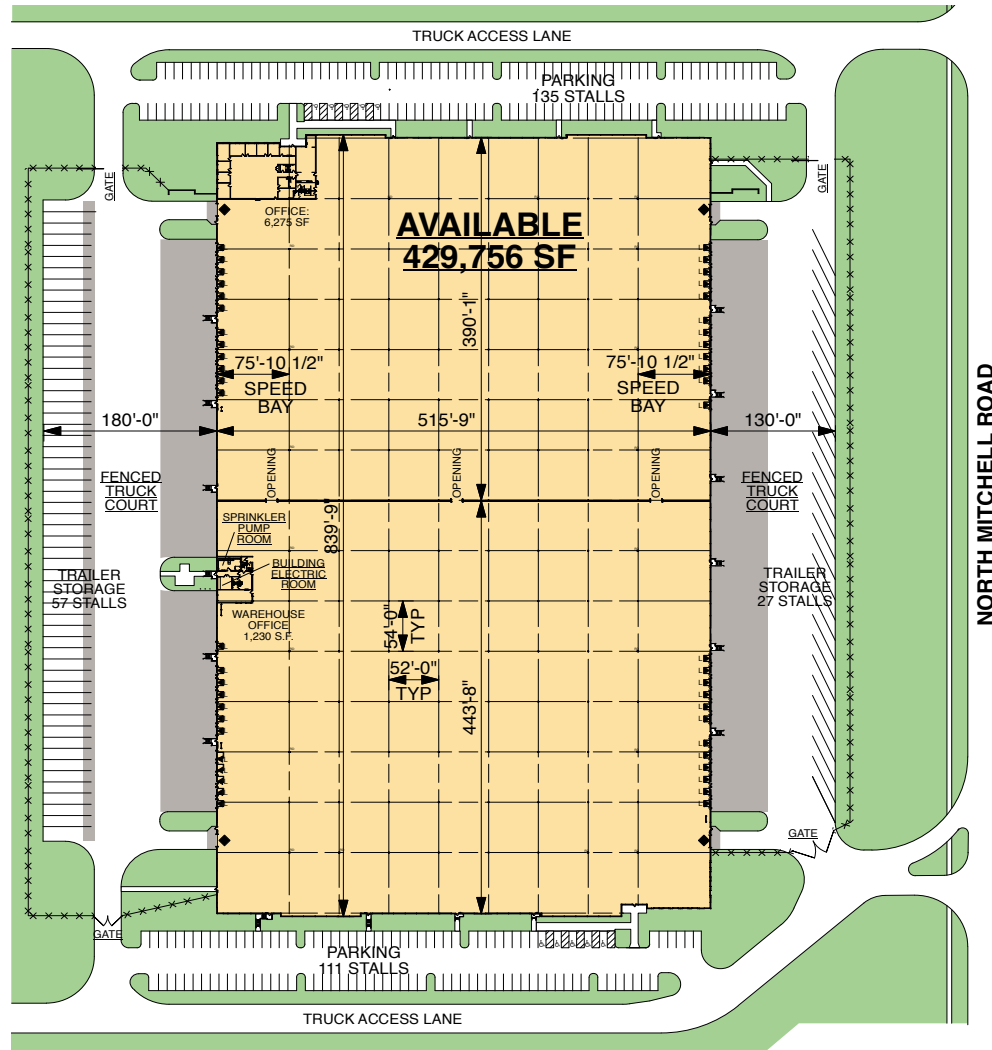

NAI Hiffman
Steve Connolly
sconnolly@hiffman.com
ph +1 630 693 0642
cell +1 312 593 0959
1 Oakbrook Terrace
Suite 400
Oakbrook Terrace, IL 60181 USA

NAI Hiffman
Mark Moran
mmoran@hiffman.com
ph +1 630 693 0656
cell +1 773 520 2132
1 Oakbrook Terrace
Suite 400
Oakbrook Terrace, IL 60181 USA

NAI Hiffman
Jack Pappas
jpappas@hiffman.com
ph +1 630 317 0775
cell +1 773 677 0330
1 Oakbrook Terrace
Suite 400
Oakbrook Terrace, IL 60181 USA

Prologis
Matthew Mannina
mmannina@prologis.com
ph +1 847 292 3939
cell +1 847 791 3827
6250 North River Road
Suite 1100
Rosemont, IL 60018 USA

Prologis Essentials: your single-source service for efficient move-in and operations at prologisessentials.com

No warranty or representation, expressed or implied, is made as to the accuracy of the information contained herein, and same is submitted subject to error and omissions.