

33,886 SF

Industrial Space For Lease



Prologis Meadowridge 6



6675 Business Parkway
Elkridge, MD 21075 USA

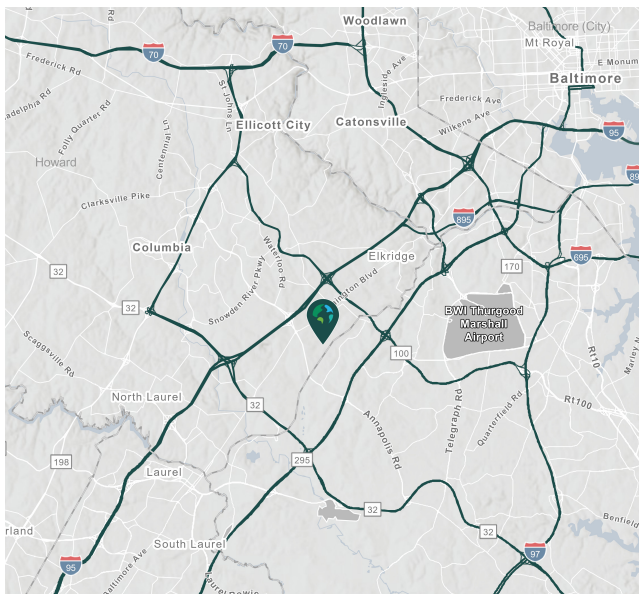

LOCATION

- Immediate access to Route 1, Route 100, and I-95
- Ease of market accessibility, 6675 Business Parkway is equidistant between Washington D.C. and Baltimore
- Heart of the Baltimore/Washington Corridor with efficient travel times to BWI Thurgood Marshall Airport

FACILITY

- 33,886 SF available
- 3,191 SF office space
- 24' clear height
- 40' x 40' column spacing
- 6 dock doors and 1 drive-in; 5 with edge of docks; potential for 1 additional dock
- 1000 amps; 277-480v electric service
- ESFR
- LED lighting

ADVANTAGES AND AMENITIES

- Fast, cost-effective forklift and racking sourcing through Prologis Essentials
- Prologis Clear Lease® – Know your lease expenses and capital costs with greater certainty before you sign

Prologis Essentials: your single-source service for efficient move-in and operations at prologisessentials.com

www.prologis.com

33,886 SF

Industrial Space For Lease



Prologis Meadowridge 6

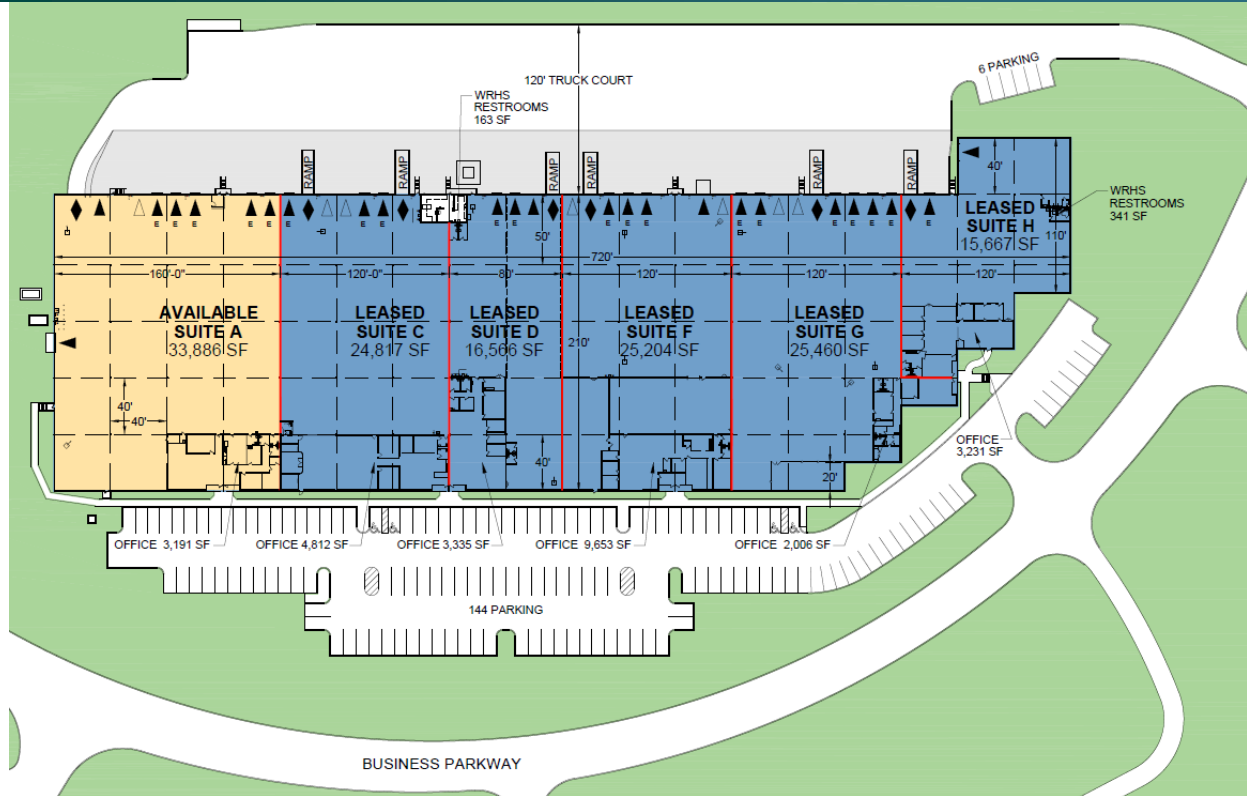

LEGEND:

- ▲ DOCK POSITION
- ▲ DOCK POSITION W/ LEVELER
- ◆ DRIVE-IN DOOR
- LAND
- LEASED AREA
- AVAILABLE AREA

CBRE

CBRE, Inc.

Michael Elardo
michael.elardo@cbre.com
ph +1 410 244 3128
100 E. Pratt Street
Suite 1700
Baltimore, MD 21202 USA

CBRE, Inc.

Jared Ross
jared.ross@cbre.com
ph +1 410 244 3136
100 E. Pratt Street
Suite 1700
Baltimore, MD 21202 USA

Prologis

Karen Cherry
kcherry@prologis.com
ph +1 410 872 4560
6721 Columbia Gateway Drive
Suite 150
Columbia, MD 21046 USA

Prologis Essentials: your single-source service for efficient move-in and operations at prologisessentials.com

No warranty or representation, expressed or implied, is made as to the accuracy of the information contained herein, and same is submitted subject to error and omissions.