

927,696 SF



Prologis Rialto I-210 Distribution Center 8



1979 W. Renaissance Parkway
Rialto, CA 92336 USA

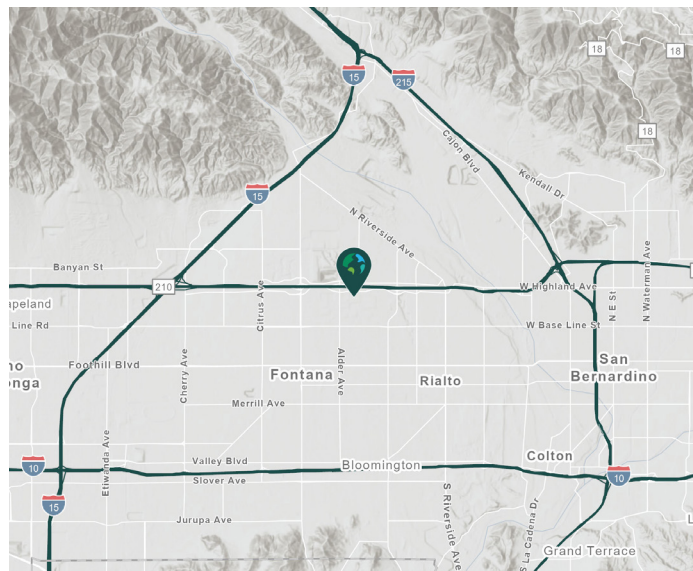

LOCATION

- Located in the City of Rialto
- Convenient access to 210, 15 & 10 Freeways
- Corporate neighbors include Target, Amazon, Under Armour, Monster, Kelloggs, Geodis, Medline Industries and Niagara Bottling.

FACILITY

- 927,696 SF Crossdock Building
- 5,127 SF Office at NWC / 2,172 SF Office at SWC
- 2,781 SF & 1,051 SF of Shipping/Receiving Offices
- 32' Clear Height (at first column)
- ESFR Sprinkler System (K-17 heads)
- 123 Dock High Doors
- 114 Doors Equipped with Levelers
- 4 Ground Level Doors
- 24 Battery Charging Stations
- Drive-Around Capability
- 235' Secured Truck Courts
- 284 Trailer Parking Positions
- 355 Auto Parking Spaces
- 2,000 amps with 4,000 UGS
- 52' x 50' Column Spacing
- LED Warehouse Lighting
- 3% Skylights

Prologis Essentials: your single-source service for efficient move-in and operations at prologisessentials.

www.prologis.com
CalDRE License #01944561

927,696 SF



Prologis Rialto I-210 Distribution Center 8

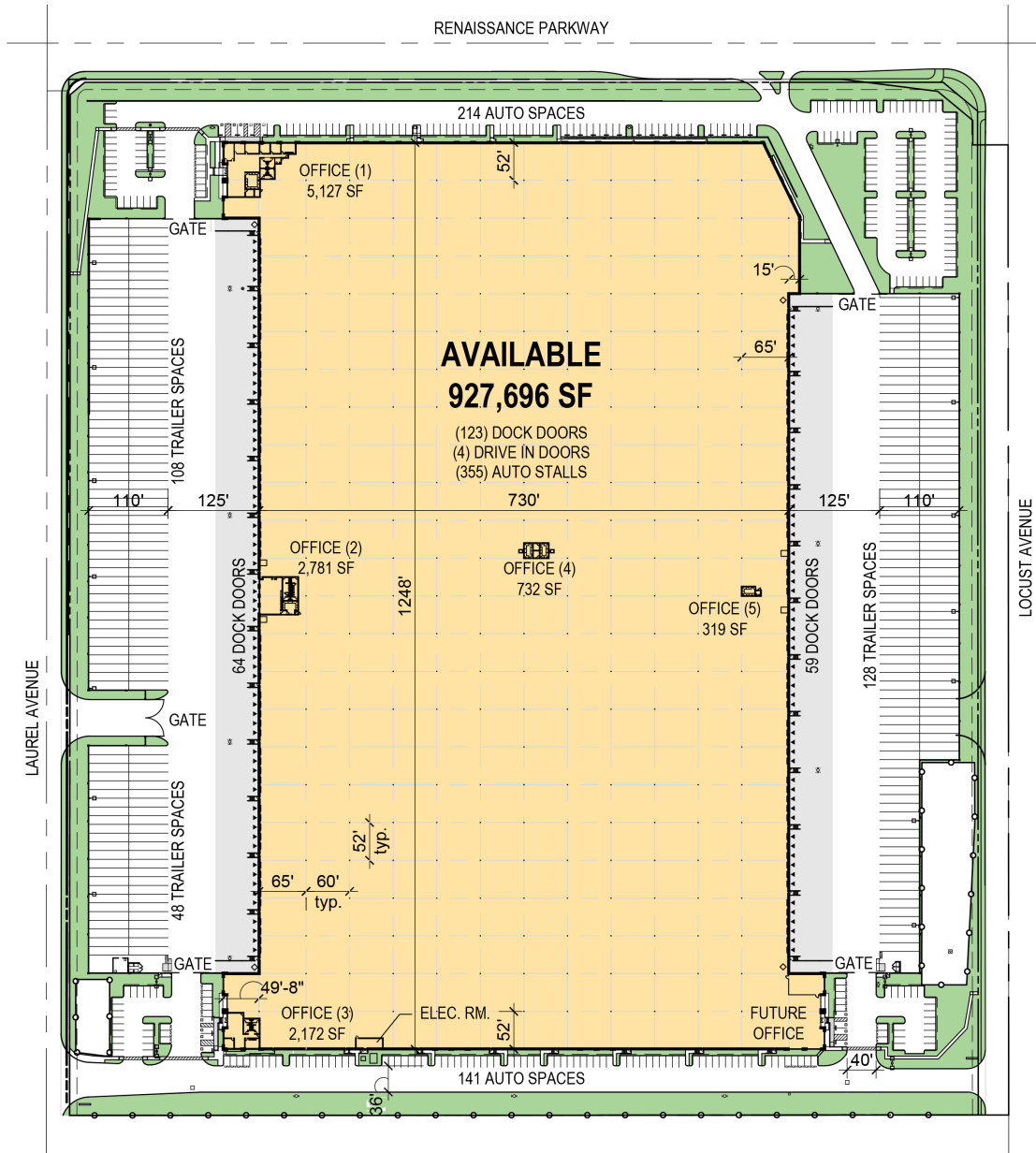

Lee & Associates

Michael Chavez
mchavez@lee-assoc.com
ph +1 909 373 2900
cell +1 951 206 5776
3535 Inland Empire Blvd.
Ontario, CA 91764 USA
License ID 00929693

Colliers International

Mark Zorn
mark.zorn@colliers.com
ph +1 909 937 6318
cell +1 909 841 3657
2855 E. Guasti Rd., Ste 401
Ontario, CA 91761
License ID 01303982

Lee & Associates

David Nguyen
dnguyen@lee-assoc.com
ph +1 909 373 2725
cell +1 909 518 7470
3535 Inland Empire Blvd.
Ontario, CA 91764 USA
License ID 01880998

Colliers International

Cory Whitman
cory.whitman@colliers.com
ph +1 909 937 6318
cell +1 909 227 2867
2855 E. Guasti Rd., Ste 401
Ontario, CA 91761
License ID 01876150

Lee & Associates

Valentina Cadogan
vcadogan@lee-assoc.com
ph +1 909 373 2903
cell +1 909 728 1443
3535 Inland Empire Blvd.
Ontario, CA 91764 USA
License ID 01829336

Prologis

Mark Zehner
mzehner@prologis.com
ph +1 909 673 8736
cell +1 714 624 5859
3546 Concourse St., Ste. 100
Ontario, CA 91764
License ID 00974420