

6,084 SF

Industrial Space For Lease



Prologis Park Chicago



9757 Farragut Street
Chicago, IL 60631 USA

LOCATION

- Conveniently located near O'Hare International Airport.
- Excellent access to I-294, I-190 and I-90.

FACILITY

- 11,168 sf building
- 6,084 sf available
- 1,853 sf office area
- 12' clear height
- 1 drive-in door
- 400 amp service

ADVANTAGES AND AMENITIES

- Immediate access to the Rosemont Entertainment District.
- Heavy office with six privates and break room.
- Walking distance to hotels and entertainment.
- Well maintained space.

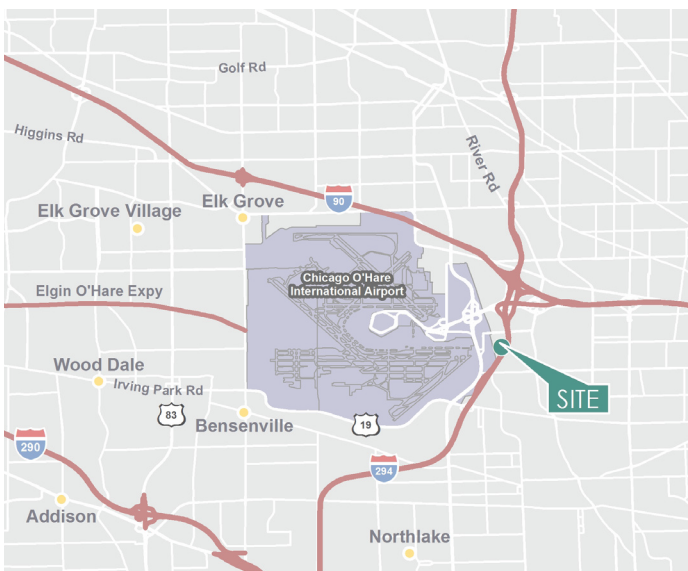

Prologis Essentials: your single-source service for efficient move-in and operations at [prologisessentials.com](https://www.prologisessentials.com)

6,084 SF

Industrial Space For Lease



Prologis Park Chicago

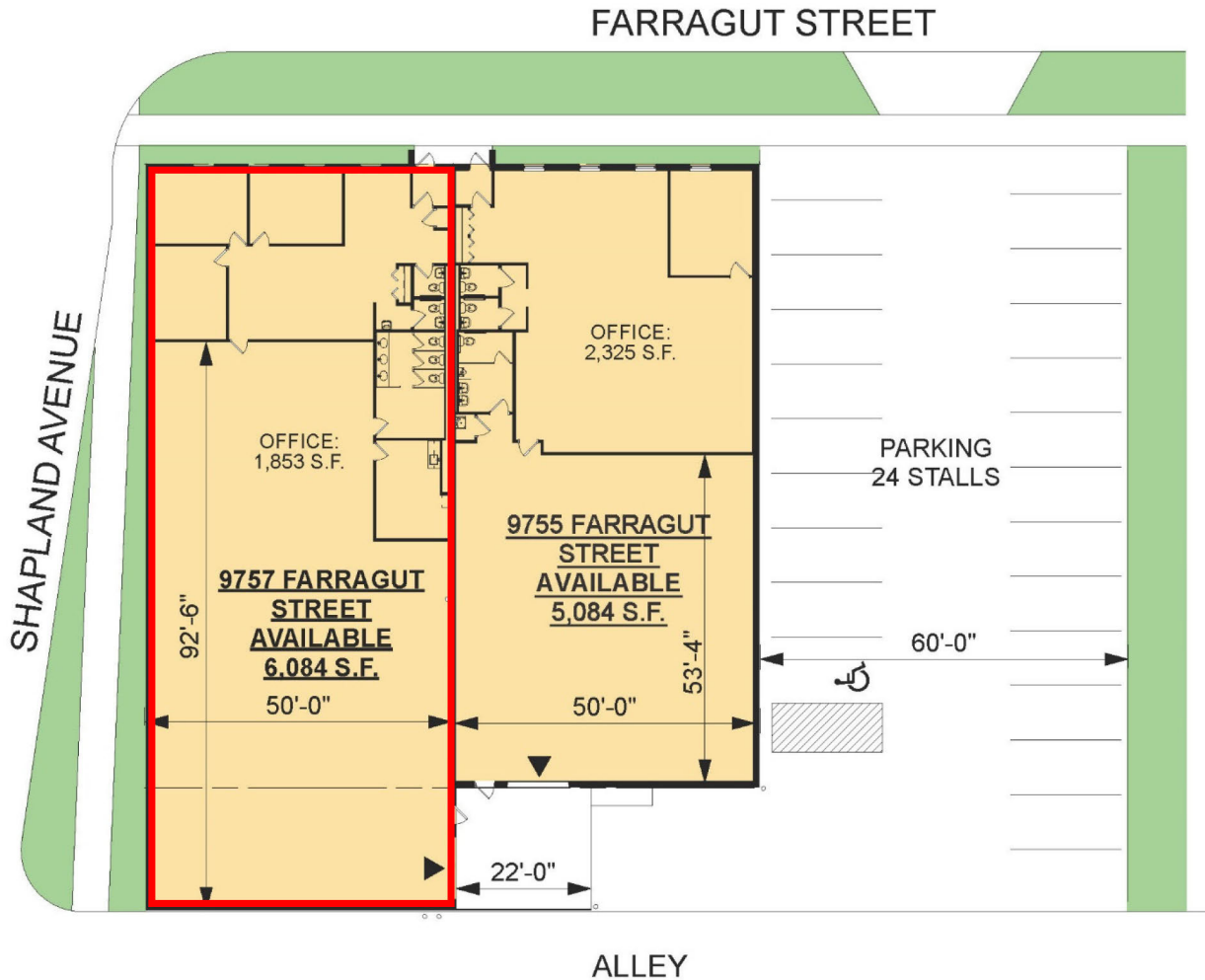

NEWMARK

Newmark

Tom Gath
thomas.gath@nrmk.com
ph +1 773 957 1415
cell +1 847 942 9438
8750 W. Bryn Mawr
Suite 350
Chicago, IL 60631 USA

Prologis

Ana Rovito
arovito@prologis.com
ph +1 847 292 3850
cell +1 312 420 4426
6250 North River Road
Suite 1100
Rosemont, IL 60018 USA

Prologis Essentials: your single-source service for efficient move-in and operations at prologisessentials.com

No warranty or representation, expressed or implied, is made as to the accuracy of the information contained herein, and same is submitted subject to error and omissions.