

# 310,000 SF

Industrial Space For Lease



## Prologis Great Southwest 83



14900 Trinity Boulevard  
Fort Worth, TX 76155 USA

### LOCATION

- Located in the heart of the North Great Southwest industrial submarket
- Convenient access to Highway 360, 183, and 161

### FACILITY

- 310,000 sf available
- 8,935 sf office
- 1,401 sf warehouse office
- 28' clear height
- 40'7" x 40' typical bay spacing
- 29 (9' x 10') dock high doors, 18 with levelers
- 1 (12' x 14') dock door with ramp
- ESFR sprinkler system
- Existing racking in  $\pm$  1/3 of building can stay in place

### ADVANTAGES AND AMENITIES

- Cross-dock configuration
- 120' & 118' truck courts
- Access to the [Prologis Essentials](https://prologisessentials.com) platform, which includes:
  - [Operations Essentials](#)
  - [Energy + Sustainability Essentials](#)
  - [Mobility Essentials](#)
  - [Workforce Essentials](#)

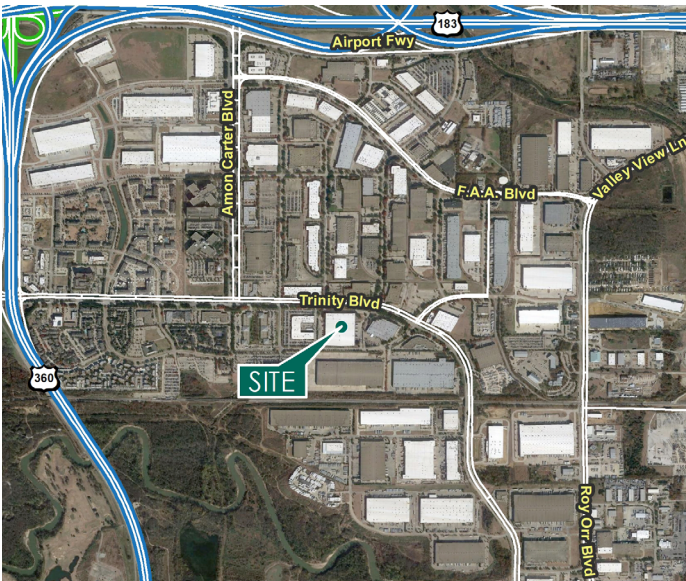

**Prologis Essentials: your single-source service for efficient move-in and operations at [prologisessentials.com](https://prologisessentials.com)**

310,000 SF

# Industrial Space For Lease



# Prologis Great Southwest 83

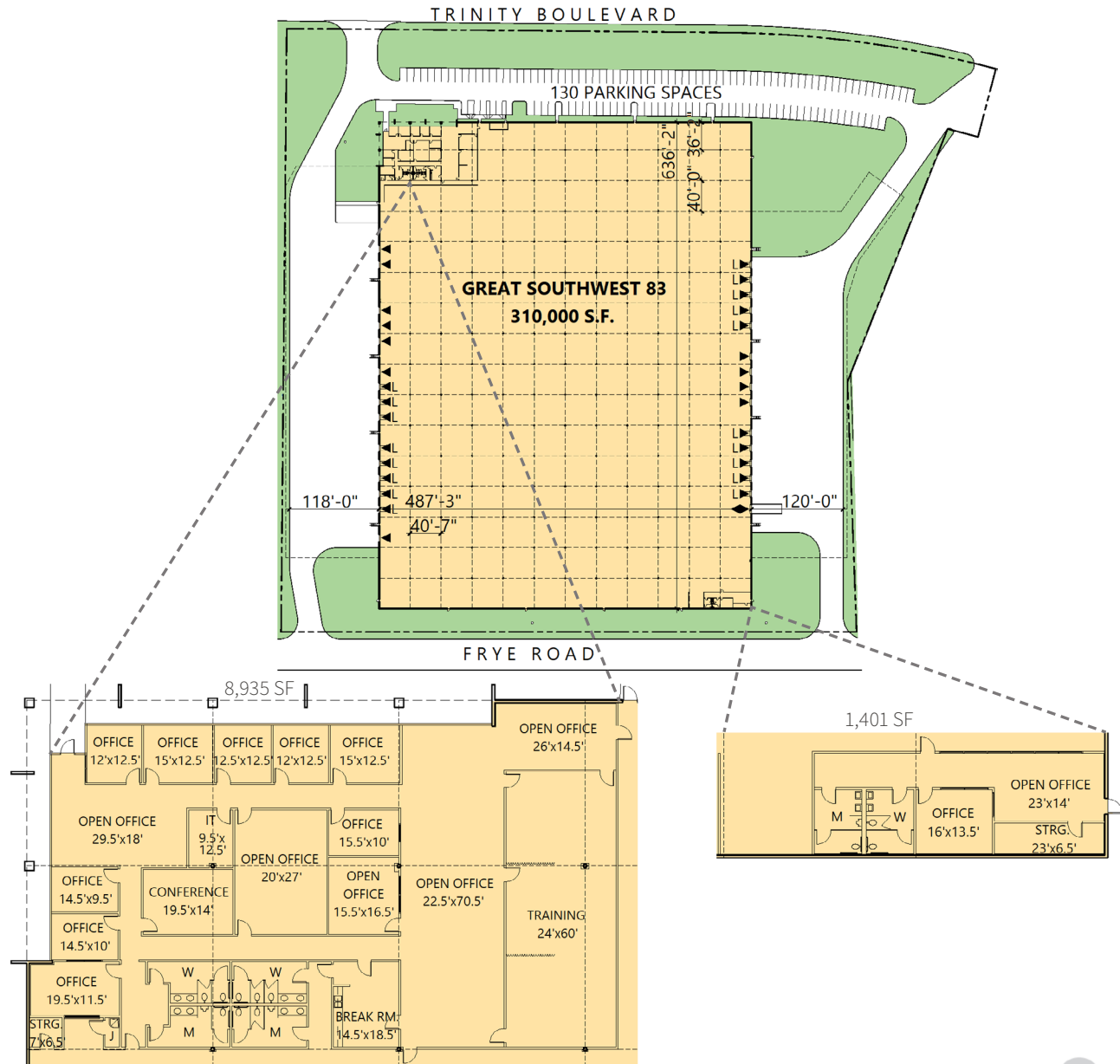

**Lee & Associates**

Mark Graybill, SIOR, CCIM  
mgraybill@lee-associates.com  
ph +1 972 934 4007  
cell +1 214 914 5537  
14950 Quorum Drive  
Suite 100  
Dallas, TX 75254 USA

**Lee & Associates**

Reed Parker, SIOR  
rparker@lee-associates.com  
ph +1 972 934 4020  
cell +1 214 558 5558  
14950 Quorum Drive  
Suite 100  
Dallas, TX 75254 USA

## Prologis

Ryan McNaughton  
rmcnaughton@prologis.com  
ph +1 972 884 9218  
cell +1 214 673 9489  
2021 McKinney Avenue  
Suite 1050  
Dallas, TX 75201 USA