

# 36,840 SF

## Industrial Space For Lease



## Prologis Great Southwest

1302 Avenue R  
Grand Prairie, TX 75050 USA

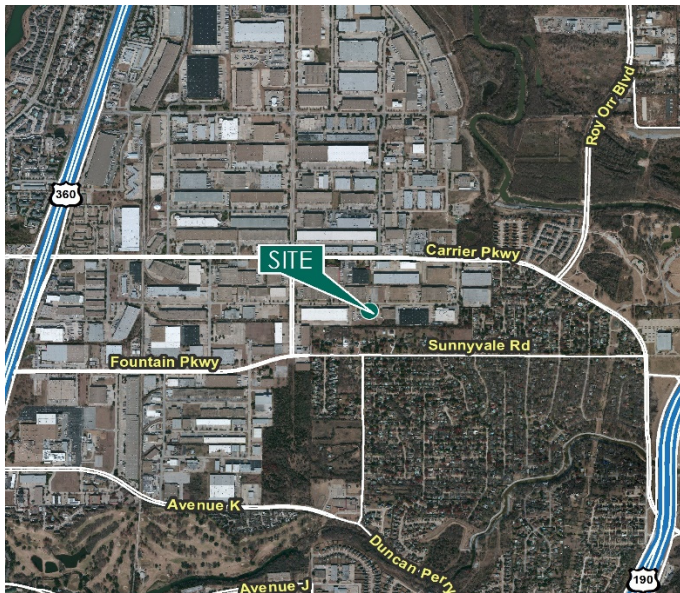

### LOCATION

- Stand alone building with easy access to SH 360, I-30 and TX 161
- Located in the heart of the North Great Southwest industrial submarket

### FACILITY

- 36,840 sf available
- 8,094 sf office total
- 21' clear height
- 5 (9' x 10') dock doors, 4 with levelers
- 1 (9'x10') drive-in door with ramp
- Fully sprinklered

### ADVANTAGES AND AMENITIES

- Stand alone building

# 36,840 SF

## Industrial Space For Lease

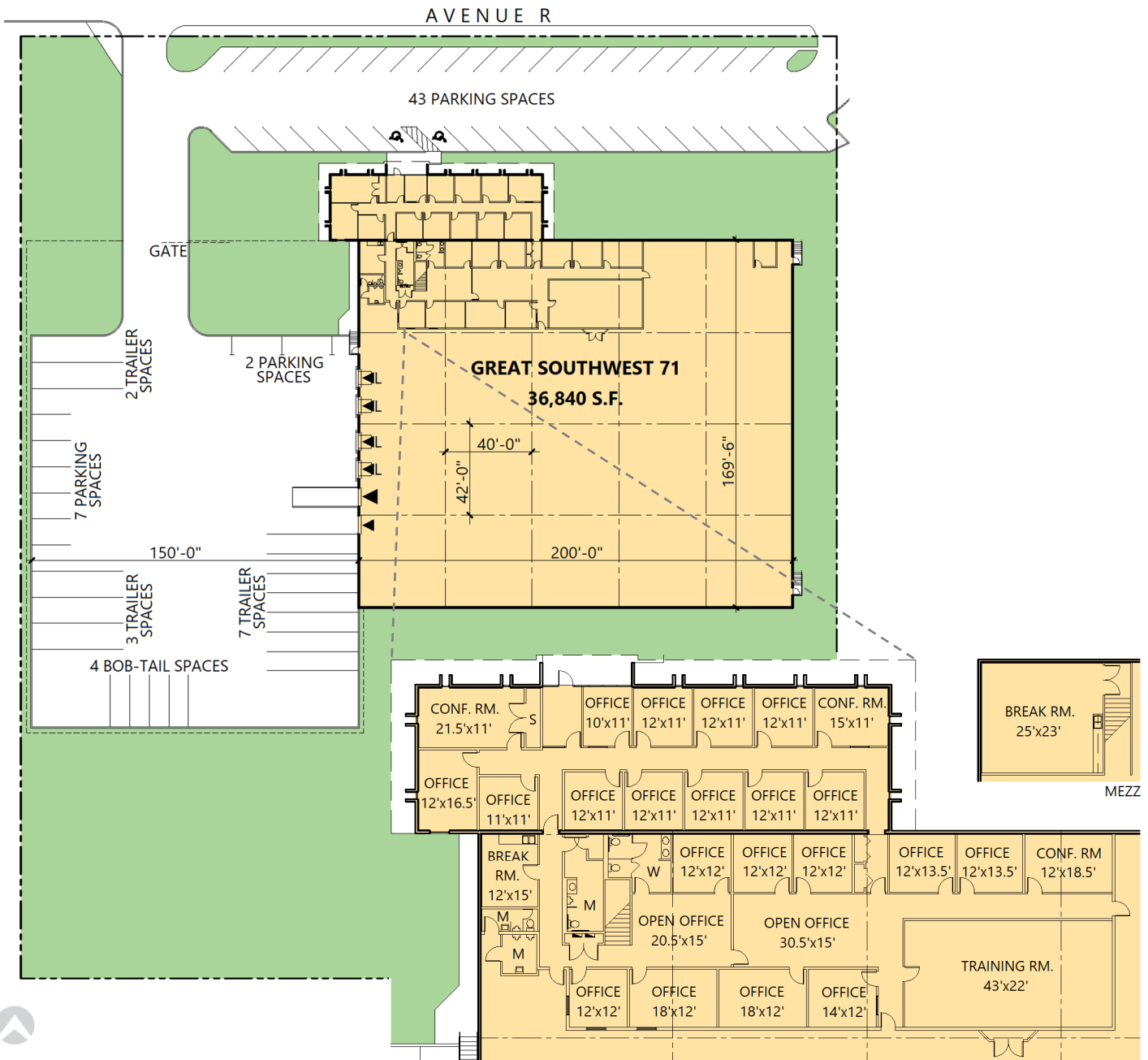

**CBRE**  
**Steve Koldyke**  
steve.koldyke@cbre.com  
ph +1 214 979 6381  
cell +1 214 850 4963  
2100 McKinney Avenue  
Suite 700  
Dallas, TX 75201 USA

**CBRE**  
**Brian Gilchrist**  
brian.gilchrist@cbre.com  
ph +1 214 979 6394  
cell +1 817 907 1774  
2100 McKinney Avenue  
Suite 700  
Dallas, TX 75201 USA

**Prologis**  
**Ryan McNaughton**  
rmcnaughton@prologis.com  
ph +1 972 884 9218  
cell +1 214 673 9489  
2021 McKinney Avenue  
Suite 1050  
Dallas, TX 75201 USA