

# 11,595 SF

Industrial Space For Lease



## Prologis Airtex 2



14820 North Freeway, Suite 200  
Houston, TX 77090 USA

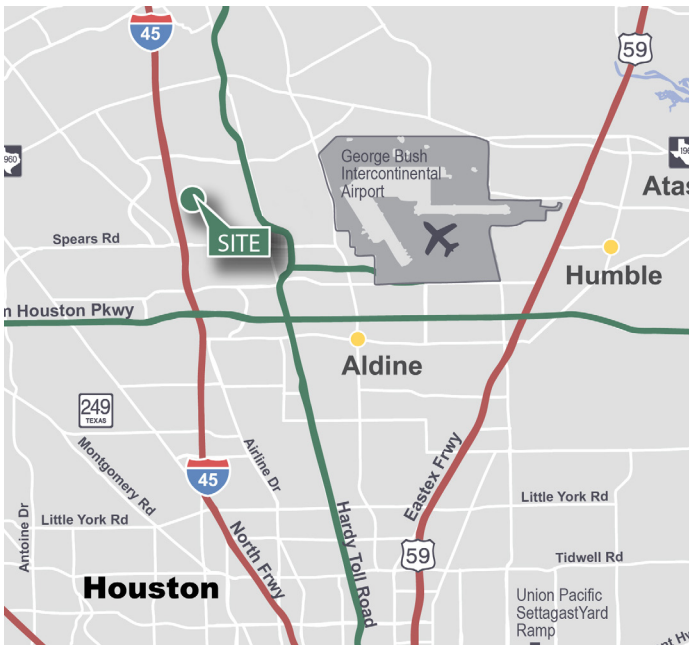

### LOCATION

- Conveniently located along I-45 at Airtex Drive with immediate access to the freeway
- Easy access within minutes to Beltway 8 and Hardy Toll Rd.
- Located in deed-restricted, master-planned business park

### FACILITY

- 11,595 SF available
- 3,026 SF of office
- 30' clear height
- 4 dock-high doors / 1 drive-in ramp
- 52' x 50' column spacing

### ADVANTAGES AND AMENITIES

- Freeway visibility and signage opportunity
- Rear-load configuration
- ESFR sprinklers
- 4 edge of dock levelers
- 120' truck court depth

**Prologis Essentials: your single-source service for efficient move-in and operations at [prologisessentials.com](https://www.prologisessentials.com)**

# 11,595 SF

Industrial Space For Lease



## Prologis Airtex 2

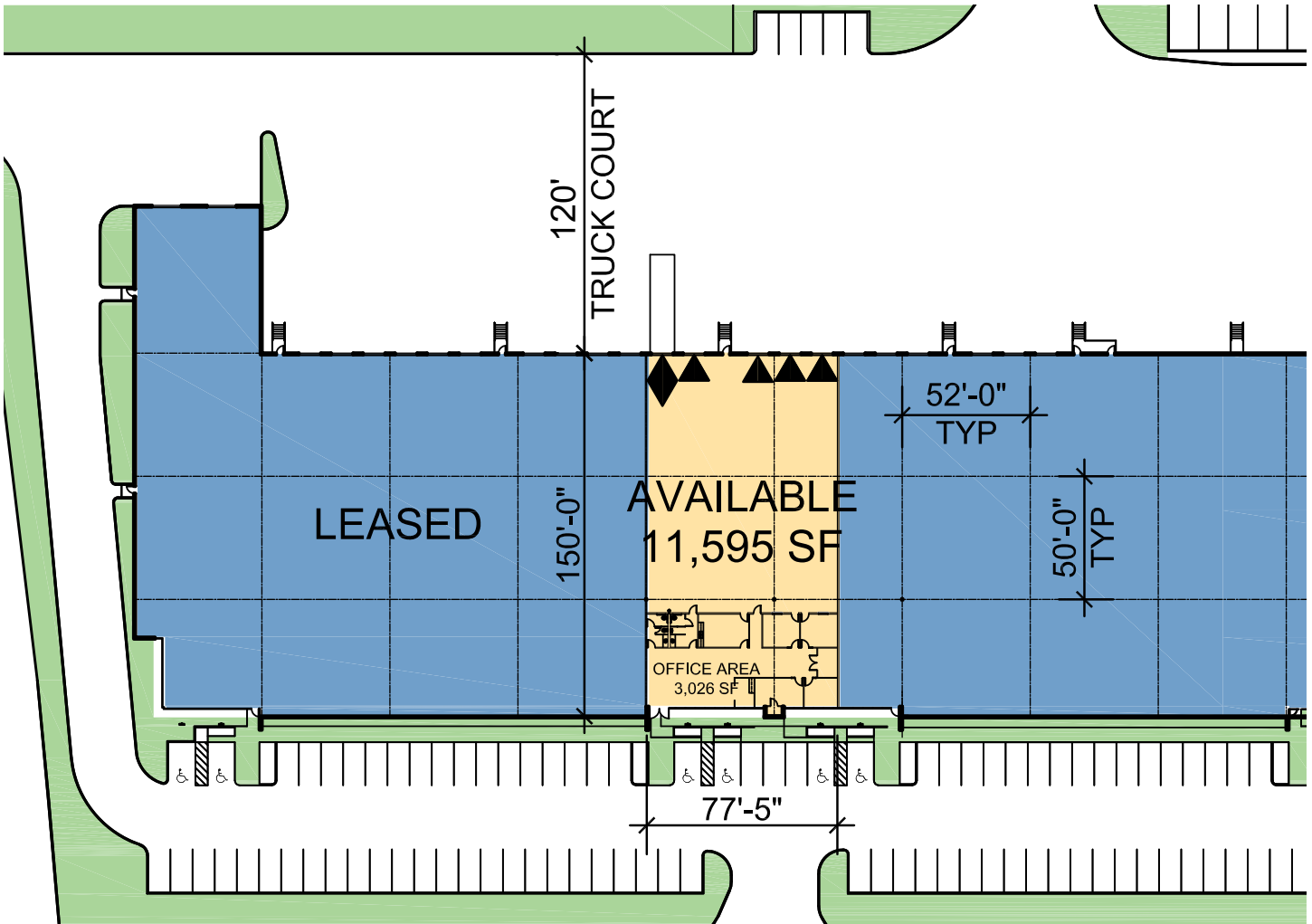

### Colliers

Walker Barnett, SIOR  
Walker.Barnett@colliers.com  
ph +1 713 830 2127  
cell +1 832 423 7063  
1233 West Loop South, Ste 900  
Houston, TX 77027 USA

### Colliers

Ryan Byrd  
Ryan.Byrd@colliers.com  
ph +1 713 830 2171  
cell +1 832 368 4884  
1233 West Loop South, Ste 900  
Houston, TX 77027 USA

### Prologis

Adam Bray  
abray@prologis.com  
ph +1 281 517 2514  
cell +1 713 202 7699  
9655 Katy Freeway, Suite 400  
Houston, TX 77024 USA

**Prologis Essentials: your single-source service for efficient move-in and operations at [prologisessentials.com](http://prologisessentials.com)**

No warranty or representation, expressed or implied, is made as to the accuracy of the information contained herein, and same is submitted subject to error and omissions.