

59,440 SF

Industrial Space For Lease



Prologis Stemmons

109-111 Regal Row, Suite 111
Dallas, TX 75247 USA



LOCATION

- Easy access to major highways including I-35E (2 mi.), I-30 (3 mi.), TX-183 (1.3 mi.) and TX-12 (1 mi.)
- Ten minutes to Love Field

FACILITY

- 59,440 sf available, divisible to 29,600 sf and 29,840 sf
- 5,617 sf office
- 22' clear height
- 11 (10' x 10') overhead dock door
- 1 (12' x 10') overhead dock door
- 1 (10' x 10') overhead dock door with ramp
- Fully sprinklered

ADVANTAGES AND AMENITIES

- Building frontage on Regal Row
- Front load distribution
- Open office/showroom layout with separate will call entrance
- Close proximity to Dallas CBD, Love Field, Medical District and Design District

59,440 SF

Industrial Space For Lease

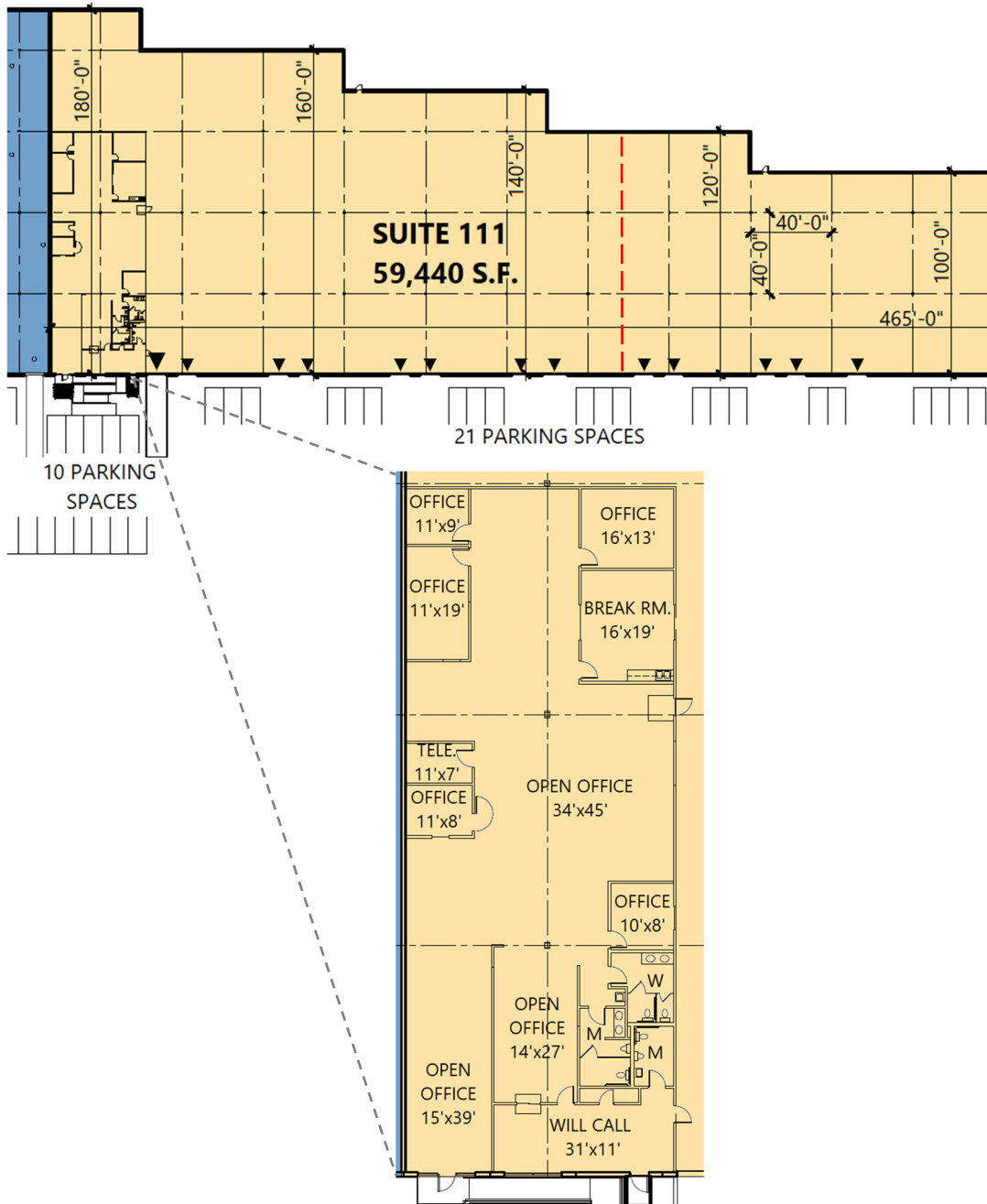

Lee & Associates

Adam Graham, SIOR, CCIM
agraham@lee-associates.com
ph +1 972 934 4011
cell +1 214 335 3320
14950 Quorum Drive
Suite 100
Dallas, TX 75254 USA

Lee & Associates

Stephen Williamson
swilliamson@lee-associates.com
ph +1 972 934 4045
cell +1 817 705 5470
14950 Quorum Drive
Suite 100
Dallas, TX 75254 USA

Prologis

Sal Giunta
sgjunta@prologis.com
ph +1 972 884 9247
cell +1 970 443 7574
2021 McKinney Avenue
Suite 1050
Dallas, TX 75201 USA