

# 49,268 SF

Industrial Space For Lease



## Prologis Corridor Park

8715 Bollman Place  
Savage, MD 20763 USA

### LOCATION

- Immediate access to I-95, Route 1, and Route 32
- Ease of multimarket accessibility, 8715 Bollman Place is equidistant between Washington D.C., and Baltimore
- Heart of the Baltimore/Washington Corridor with efficient travel times to BWI Thurgood Marshall Airport

### FACILITY

- 49,268 SF available
- 6,501 SF office space
- 24' clear height
- 7 dock doors with levelers; 3 drive-in doors
- Ample parking
- 33' x 34' column spacing
- 1200 amps
- Calculated wet sprinkler system
- LED lighting

### ADVANTAGES AND AMENITIES

- Prologis Clear Lease® – Know your lease expenses and capital costs with greater certainty before you sign
- Fast, cost-effective forklift and racking sourcing through Prologis Essentials

---

**Prologis Essentials: your single-source service for efficient move-in and operations at [prologisessentials.com](http://prologisessentials.com)**

[www.prologis.com](http://www.prologis.com)

# 49,268 SF

Industrial Space For Lease



## Prologis Corridor Park

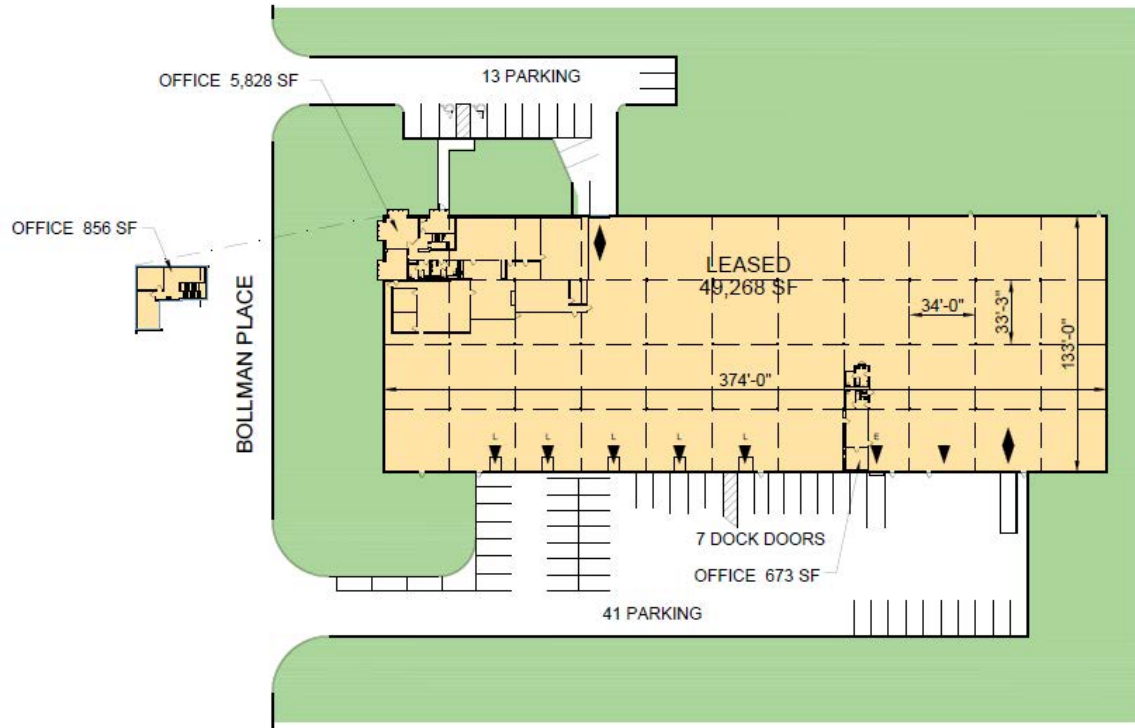

**LEGEND:**

- ▲ DOCK POSITION
- ▲ DOCK POSITION W/ LEVELER
- ◆ DRIVE-IN DOOR
- LAND
- LEASED AREA
- AVAILABLE AREA



**Lee & Associates**

Kate Jordan, SIOR  
kjordan@lee-associates.com  
ph +1 443 741 4041  
8840 Stanford Boulevard  
Suite 1800  
Columbia, MD 21045 USA

**Lee & Associates**

Tom Whelan  
twhelan@lee-associates.com  
ph +1 443 741 4042  
8840 Stanford Boulevard  
Suite 1800  
Columbia, MD 21045 USA

**Lee & Associates**

Marley Welsh, SIOR  
mwelsh@lee-associates.com  
ph +1 443 741 4050  
8840 Stanford Boulevard  
Suite 1800  
Columbia, MD 21045 USA

**Prologis**

Karen Cherry  
kcherry@prologis.com  
ph +1 410 872 4560  
6721 Columbia Gateway Drive  
Suite 150  
Columbia, MD 20146 USA

**Prologis Essentials: your single-source service for efficient move-in and operations at [prologisessentials.com](http://prologisessentials.com)**

No warranty or representation, expressed or implied, is made as to the accuracy of the information contained herein, and same is submitted subject to error and omissions.