

**PROLOGIS
PORTS LINDEN**

55 WILDCAT WAY
LINDEN, NEW JERSEY 07036

TOTAL FOOTPRINT:	385,140 S.F.
OFFICE:	19,365 S.F.
WAREHOUSE:	365,775 S.F.
PERCENTAGE OFFICE:	5%
CLEAR HEIGHT SUITE A:	37'-8"
CLEAR HEIGHT SUITE B:	37'-5"
CAR PARKING:	184 STALLS
TRUCK PARKING:	17 STALLS
TRAILER PARKING:	93 STALLS
DOCK-HIGH DOORS:	52
DRIVE-IN DOORS:	2
TYPICAL BAY SUITE A:	48'-8" x 50'-0"
TYPICAL BAY SUITE B:	48'-8" x 50'-0"

Suite 100: 203,233 S.F.

OFFICE:	15,646 S.F.
WAREHOUSE:	187,587 S.F.
PERCENTAGE OFFICE:	7.7%
CLEAR HEIGHT:	37'-8"
CAR PARKING:	161 STALLS
TRUCK PARKING:	17 STALLS
TRAILER PARKING:	72 STALLS
DOCK-HIGH DOORS:	25
DRIVE-IN DOORS:	1
TYPICAL BAY:	48'-8" x 50'-0"

Suite 101: 181,907 S.F.

OFFICE:	3,719 S.F.
WAREHOUSE:	178,188 S.F.
PERCENTAGE OFFICE:	2%
CLEAR HEIGHT:	37'-5"
CAR PARKING:	23 STALLS
TRUCK PARKING:	0 STALLS
TRAILER PARKING:	21 STALLS
DOCK-HIGH DOORS:	27
DRIVE-IN DOORS:	1
TYPICAL BAY:	48'-8" x 50'-0"

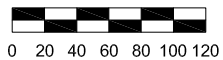
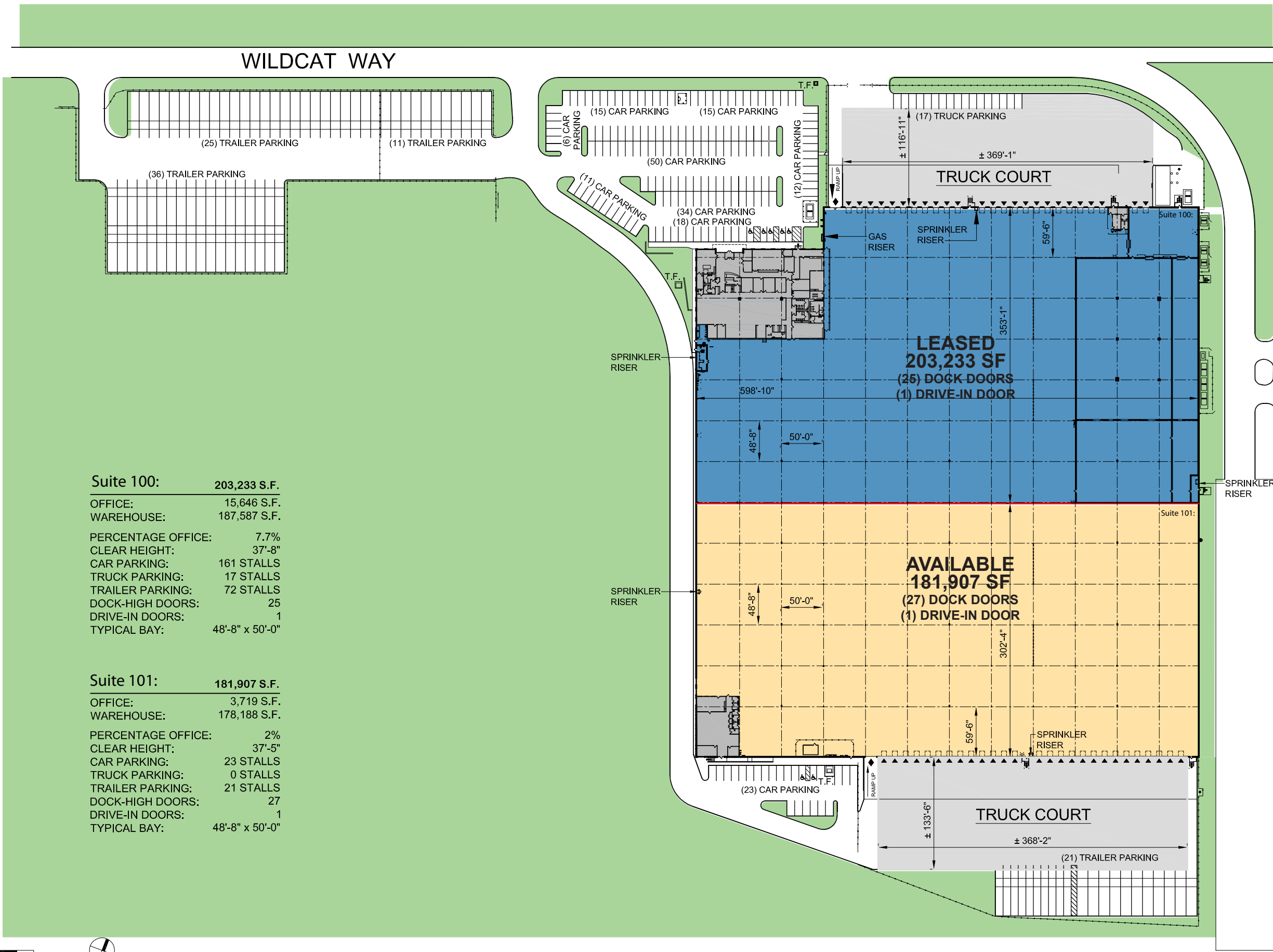

The above information/drawing is for reference only and is subject to verification, and/or revision. No liability for omissions shall be assumed. Area calculations are approximate and subject to change without notice.

COPYRIGHT 2024 - PARETTE SOMLEN ARCHITECTS LLC. - DAY/USE FOR 2024-06-27