

# 37,071 SF

## Industrial Space For Lease



## Prologis Lee Vista

6550 Hazeltine National Drive  
Orlando, FL 32822 USA



### LOCATION

- Easy access to Florida SR 417 and the Beachline Expressway (SR 528)

### FACILITY

- 121,400 SF building
- Built in 2004
- Rear loading
- 30' clear height
- 250' building depth
- 50' x 50' column spacing (typical)
- 130' truck court
- .66 / 1,000 SF parking
- Six trailer spaces

### SUITE 150

- 37,071 SF available
- 1,532 SF of office
- (10) 9' x 10' dock doors
- Three pit levelers
- LED office and warehouse lighting w/motion sensors
- 400 amp, 277/480 volt, three-phase power
- HVAC in warehouse
- ESFR fire protection

# 37,071 SF

## Industrial Space For Lease

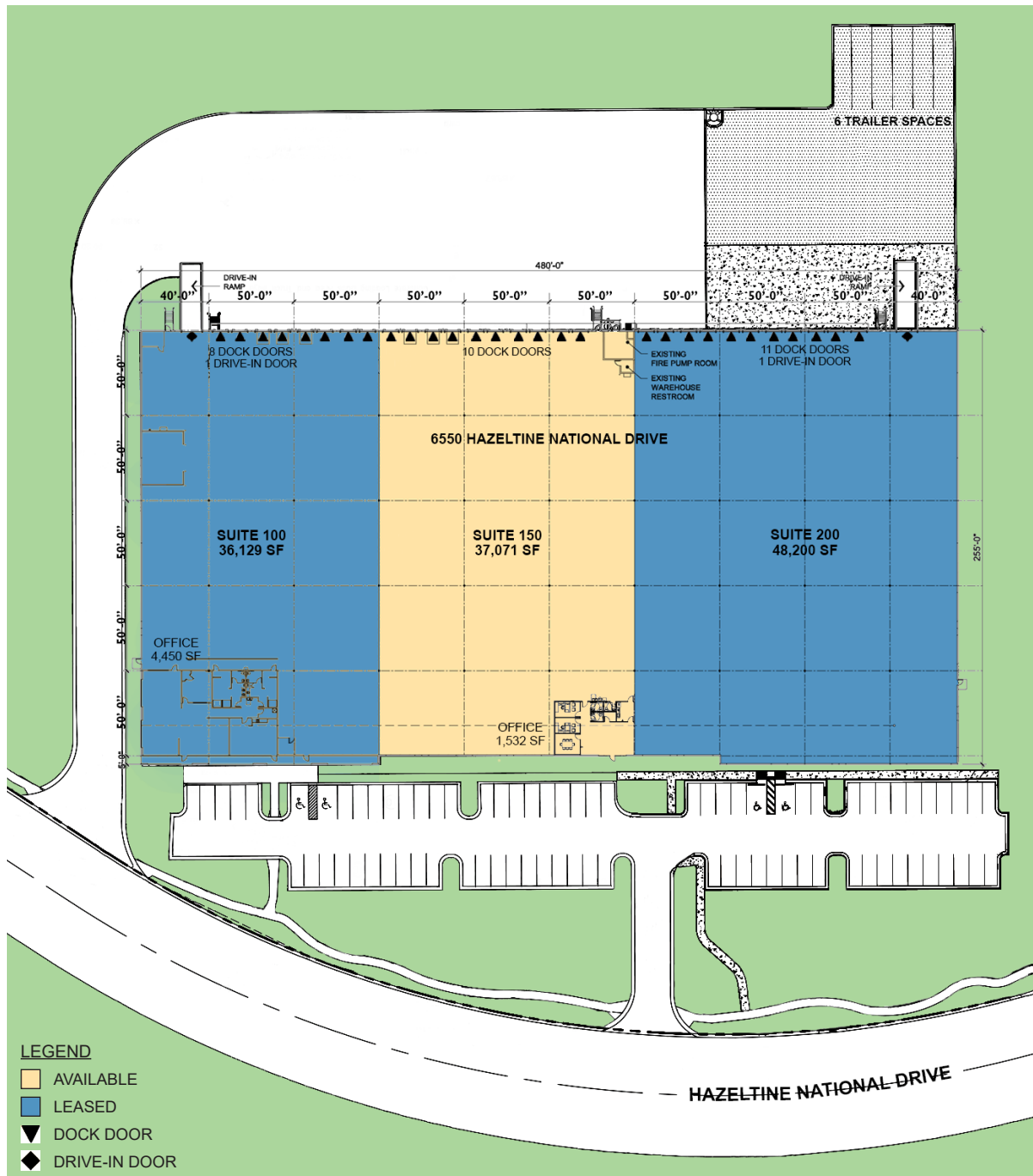

### Foundry Commercial

Justin Ruby, SIOR, CCIM

justin.ruby@foundrycommercial.com

+1 407.540.7727 phone

420 S. Orange Avenue, Suite 400

Orlando, FL 32801 USA

### Foundry Commercial

John Pietkiewicz

john.pietkiewicz@foundrycommercial.com

+1 407.540.2793 phone

420 S. Orange Avenue, Suite 400

Orlando, FL 32801 USA

### Foundry Commercial

Joey Woodman

joey.woodman@foundrycommercial.com

+1 407.757.1515 phone

420 S. Orange Avenue, Suite 400

Orlando, FL 32801 USA