

192,829 SF

Industrial Space For Lease



Prologis Edison | One Nixon Lane



One Nixon Lane
Edison, NJ 08837 USA

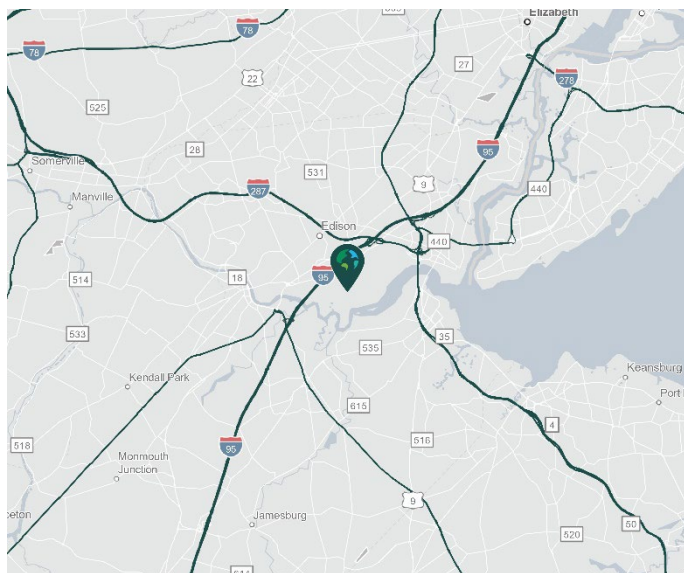

LOCATION

- Close access to NJ Turnpike, I-287, Route 1, Route 27, and Garden State Parkway
- ± 20 miles from Newark Liberty International Airport and Ports Newark-Elizabeth

FACILITY

- 192,829 SF total building size
- 192,829 SF available space
- 16,847 SF office
- 24' clear height
- 40' x 40' column spacing
- 20 dock doors
- 1 drive-in door
- 107 car parking spaces
- 1600 amps, 3 phase, 480/277 volt electrical service
- ESFR sprinkler system

ADVANTAGES AND AMENITIES

- Fast, cost-effective forklift and racking sourcing through Prologis Essentials
- Prologis Clear Lease® – Know your lease expenses and capital costs with greater certainty before you sign

Your single-source service for efficient move-in and operations: [prologisessentials.com](https://www.prologisessentials.com)

192,829 SF

Industrial Space For Lease



Prologis Edison | One Nixon Lane

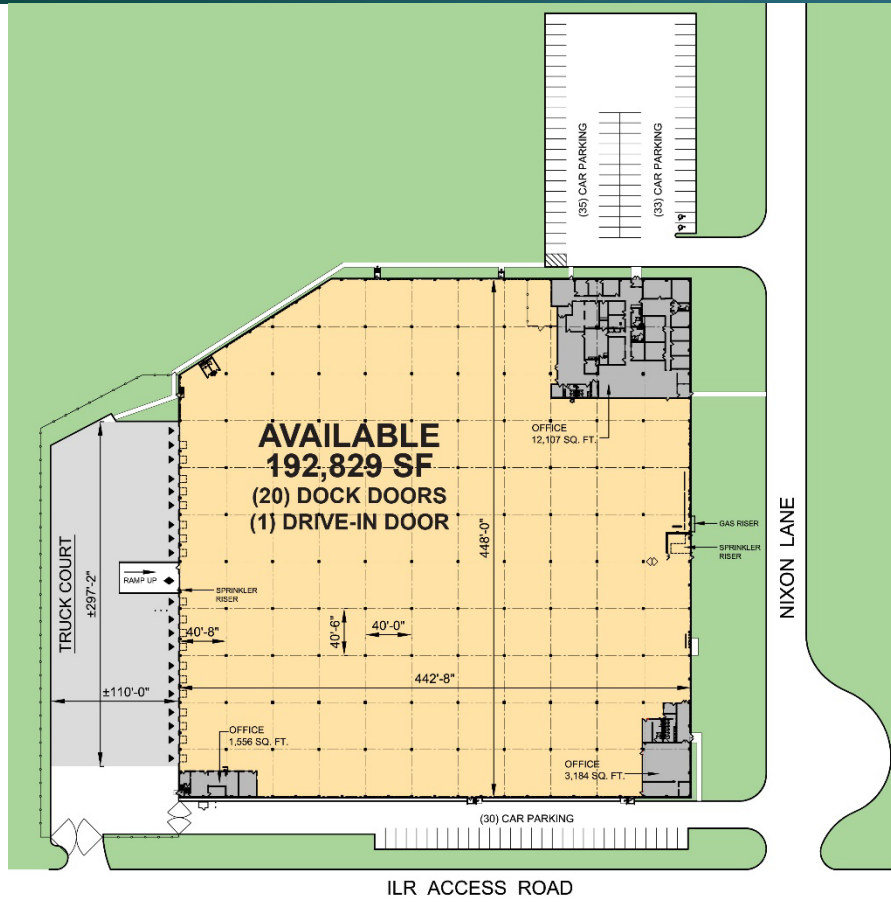

KBC Advisors

Marc Petrella
marc.petrella@kbcadvisors.com
cell +1 732 261 6317
90 Woodbridge Center Drive
Suite 110
Woodbridge, NJ 07095 USA

KBC Advisors

Jason Goldman
jason.goldman@kbcadvisors.com
cell +1 201 280 5360
90 Woodbridge Center Drive
Suite 110
Woodbridge, NJ 07095 USA

KBC Advisors

Andrew Siemsen
andrew.siemsen@kbcadvisors.com
cell +1 201 306 5019
90 Woodbridge Center Drive
Suite 110
Woodbridge, NJ 07095 USA

Prologis

Paul Rosen
prosen@prologis.com
ph +1 201 635 6013
cell +1 201 306 1332
One Meadowlands Plaza
Suite 100
East Rutherford, NJ 07073 USA