

24,791 SF

Industrial Space For Lease



Prologis Harvest Business Park - Kent 9



6405 S 194th Street
Kent, WA 98032 USA

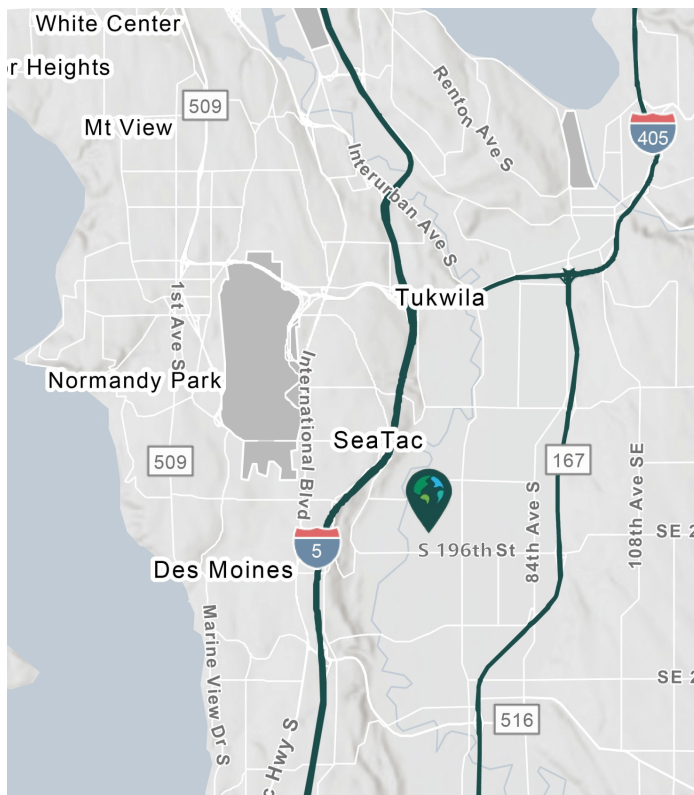

LOCATION

- Strategic distribution location
- Great access to I-5 and SR-167
- Just minutes from SeaTac International Airport

FACILITY

- Total building size: 63,944 SF
- Total available: 24,791 SF
- Total office: 5,494 SF
- 22' clear height
- 6 dock-high doors
- 50' x 22'6" typical column spacing
- Wet sprinkler system
- 52 auto parking stalls
- Available April 1, 2024
- Contact brokers for rates

ADVANTAGES AND AMENITIES

- Corporate image

Your single-source service for efficient move-in and operations: [prologisessentials.com](https://www.prologisessentials.com)

24,791 SF

Industrial Space For Lease



Prologis Harvest Business Park - Kent 9

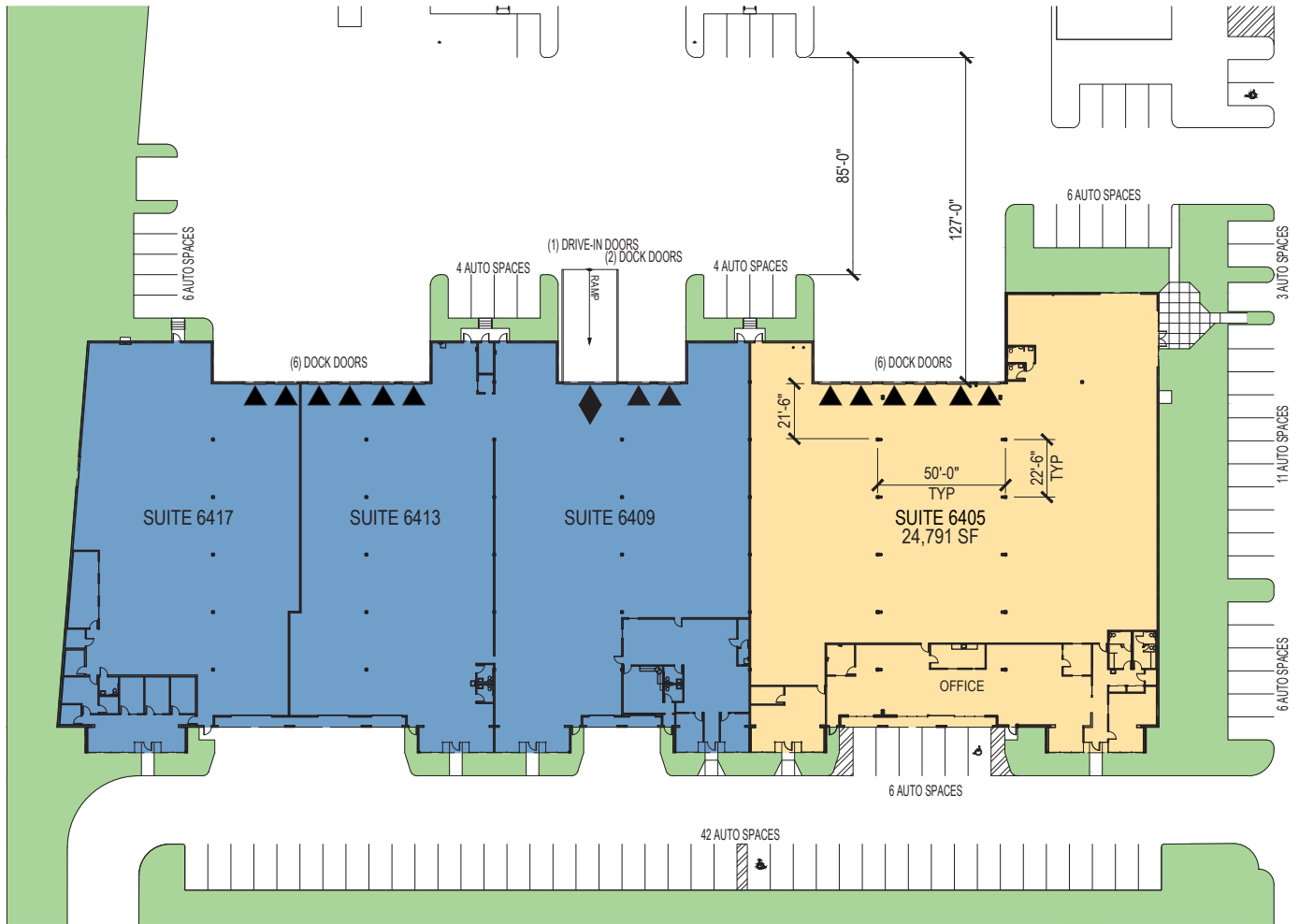

Les Boudwin, SIOR
les.boudwin@jll.com
ph +1 206 679 6393
225 108th Avenue NE
Suite 550
Bellevue, WA 98004 USA

Scott Carter
scott.carter@jll.com
ph +1 425 761 5880
225 108th Avenue NE
Suite 550
Bellevue, WA 98004 USA

David Cahill
david.cahill@jll.com
ph +1 206 930 5599
601 Union Street
Suite 2800
Seattle, WA 98101 USA

Prologis
Kimberley Nemethy
knemethy@prologis.com
ph +1 253 508 1737
33930 Weyerhaeuser Way S
Suite 100
Federal Way, WA 98001 USA