



Prologis Park Tongeren DC2

Belgium

PROLOGIS PARK TONGEREN DC2 / AERIAL



Highway
E313 - 2 km



Airport
Liège Airport - 22 km
Brussels Airport - 90 km
Düsseldorf Airport - 140 km



Sea Port
Antwerpen - 90 km



Clear height
9,47 m



Floor load
40 kN/sqm

PROLOGIS PARK TONGEREN DC2 / COUNTRY MAP

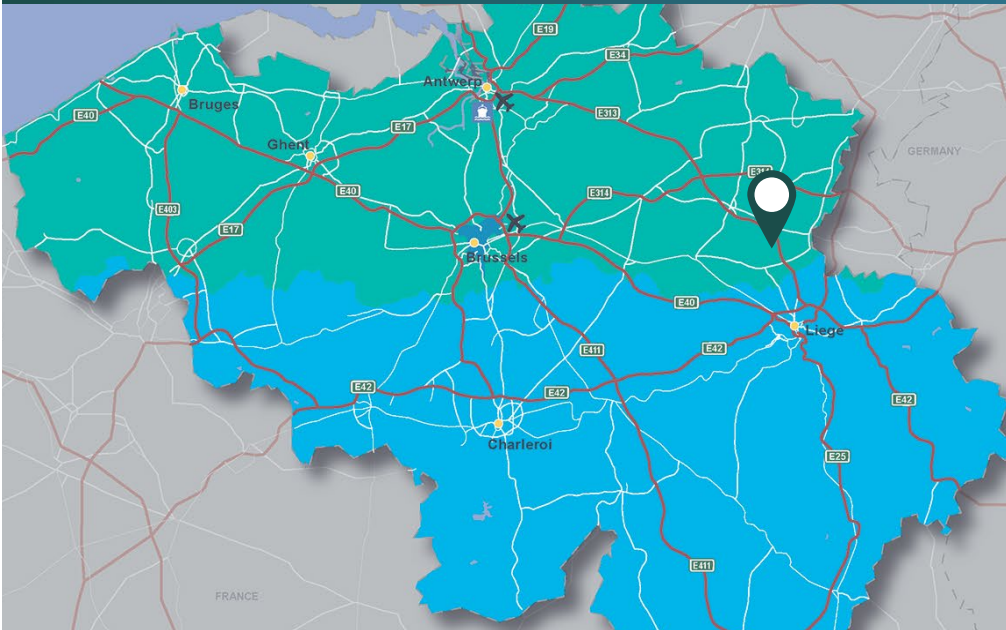

Location

Belgium is widely considered to be one of the main logistics gateways to Europe and is the location of choice for many large Pan-European distribution activities.

Tongeren Oost is a prime industrial park located along the motorway E313. This highway connects Tongeren via Liège to the German motorway network.

The E313 also provides connection via the E19 to France or the Netherlands, and the E40 to Brussels, Ostend and London. Eastward this highway connects to the Rhine-Ruhr area. The seaport of Antwerp is located 90 km west of Tongeren. The two airports of Liège and Maastricht are only 20 km from this unique industrial area. Brussels Airport is located 90 km from Tongeren.

Since the founding of Tongeren-Oost approximately forty companies have settled here. The excellent location makes Tongeren-Oost very attractive, especially for logistics companies. A number of multinationals, including SKF and Rajapack, have already expanded their businesses. The city government is deliberately looking for companies in the logistics or non-polluting industry that fit into the green character of the city of Tongeren. Attention is paid to the environmental quality of the land and public space by the preparation of a landscape plan for the entire region. The strong architecture of the buildings enhances this.

PROLOGIS PARK TONGEREN DC2 / CATCHMENT MAP

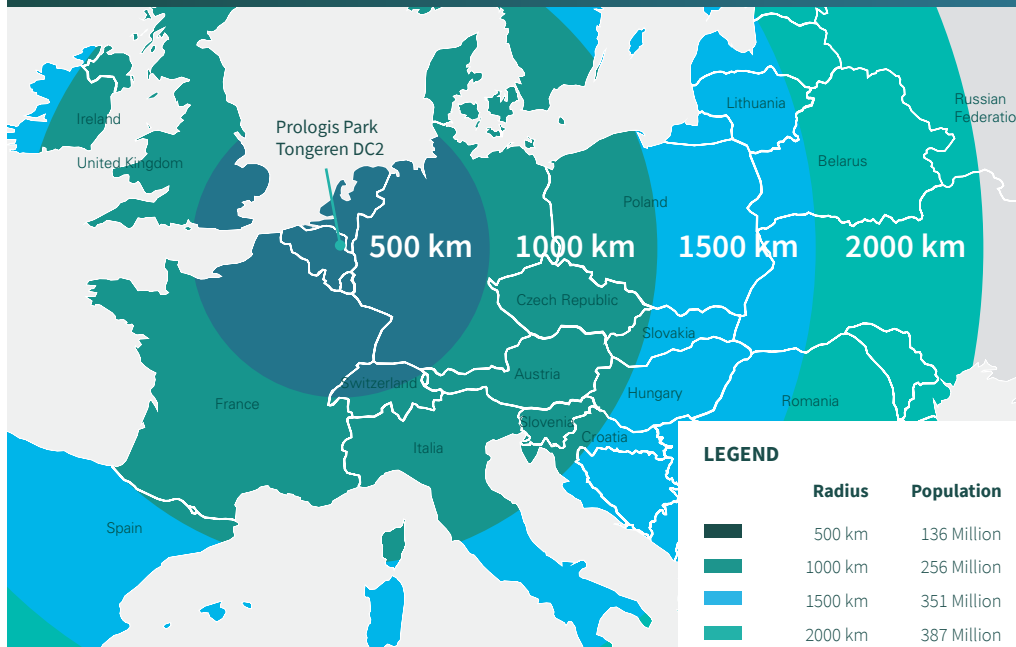

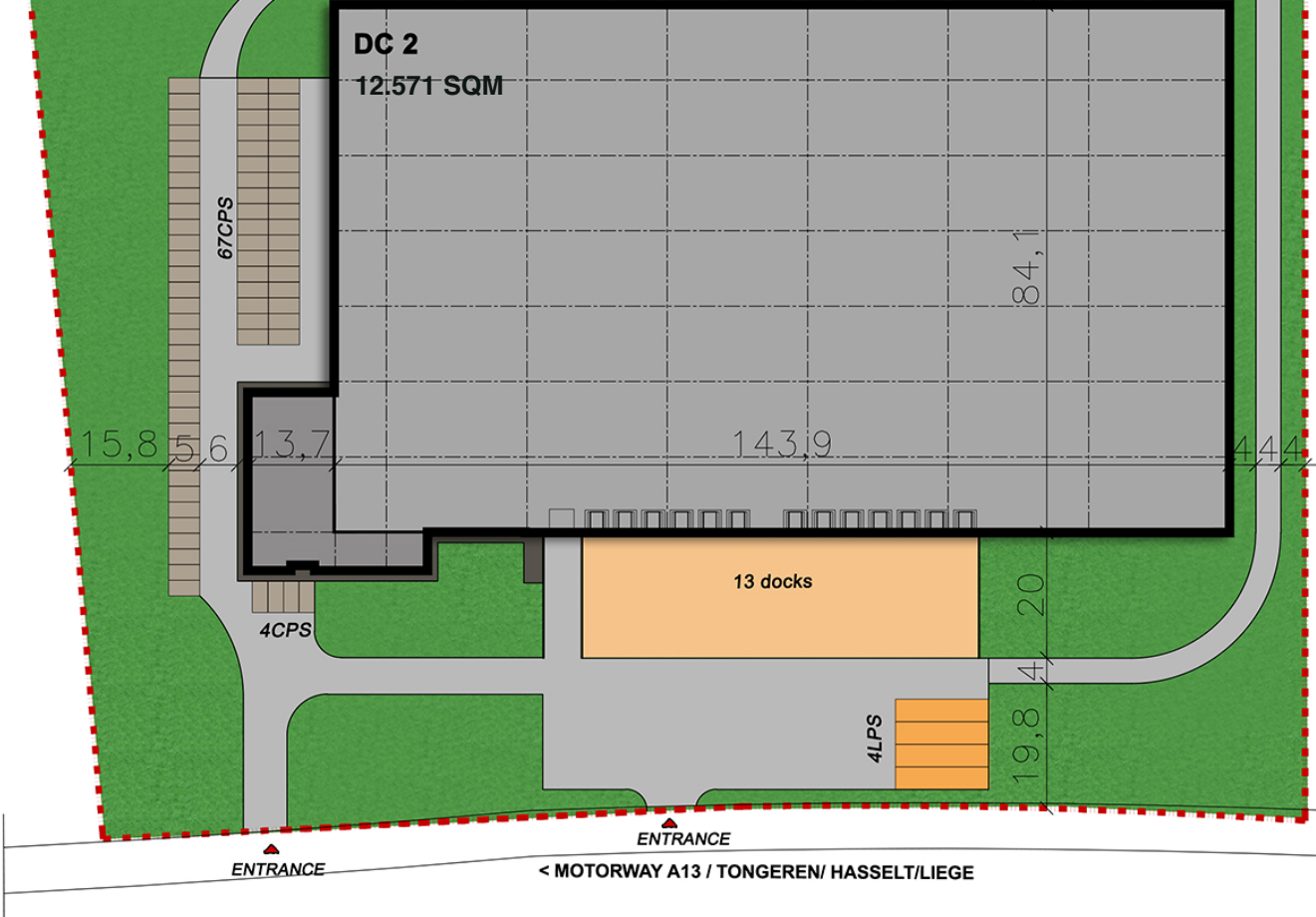

TOTAL AREA OVERVIEW

Prologis Park Tongeren DC2

UNIT 1	
Warehouse	12.086 SQM
Office	485 SQM
Total	12.571 SQM
Parking	75 pcs

Prologis Park Tongeren DC2 Specifications

Building description

Warehouse

- Warehouse: approx. 12.086 sqm gross floor area.
- Clear height warehouse: 9,47 m (=max. storage height).
- Office: 485 sqm.
- Loading docks: 13 pcs.
- Ground-floor gates: 1 pcs.
- Fire compartments: 1 pcs.
- Car parking space: 75 pcs.

Interior Work Office

- Reception area and sanitary rooms equipped with ceramic floor tiles.
- Kitchenette: connections are provided for installations made by the tenant.

LED

- Transformer: 1 x 630 kVA.

Heating/Cooling

- Warehouse: directly gas-fired heaters.
- Office: boiler with profiled flat-/valve radiators, step less thermostat valves.

Fire Protection

- Sprinkler system in warehouse: K14-ceiling-sprinkler according to ANPI.
- Fire alarm system: in compliance with fire protection requirements.
- Fire hose reels: in compliance with fire protection requirements.
- Evacuation Alarm System: in compliance with fire protection requirements.
- Fire hydrants around the building.
- The roof is equipped with smoke hatches.
- Separation wall elements according to fire regulations.

Prologis Essentials

For easy set up and smooth operations

When it comes to getting your warehouse up and running, we've got you covered.

Prologis Essentials is the first complete warehouse solutions platform that lets you run, optimize and grow your business; how, when and wherever you want.

It conveniently brings you all the set-up and operational equipment needed for a cost effective, quick and care-free start. It is your source for replacements, upgrades or temporary solutions as well – making life easier and giving you back valuable time.



FORKLIFTS

An easy and cost-effective solution for preconfigured forklifts, reach and pallet trucks, from our world-class partners.



RACKING

The right racking system to suit your needs – a fast and easy service that makes arranging racking simple.



SOLARSMART

Harness green energy and benefit from onsite power while reducing your carbon footprint.



LED LIGHTING

Efficient and reliable upgrade to 'smart' lighting with movement and daylight controls at an incredibly low price.

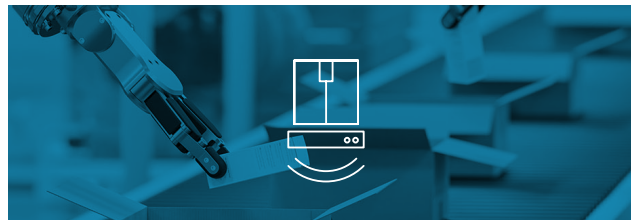

WAREHOUSE ROBOTS

Transform your fulfilment and order picking with efficient, multi-bot systems to suit all needs.



SAFETY

Durable protective gear to help look after people, materials, fittings and equipment in any warehouse environment.

PROLOGIS BENELUX

Jan van Rijswijcklaan 162, verd. 11
2020 Antwerpen
Belgium

www.prologis.be

YOUR CONTACT**Gina Helmold**

VP, Head of Capital Deployment
& Leasing Benelux

M +31 20 655 1916
ghelmold@prologis.com

No warranties or representations, expressed or implied, are made as to the accuracy or completeness of the information contained herein. All sizes are approximate. Prologis makes no commitment to update the information contained herein, and may make changes to these materials at any time without notice.

www.prologis.be

