

# 187,100 SF

## Industrial Space For Lease



## Prologis Great Southwest

510 W. Trinity Boulevard, Suite 300  
Grand Prairie, TX 75050 USA

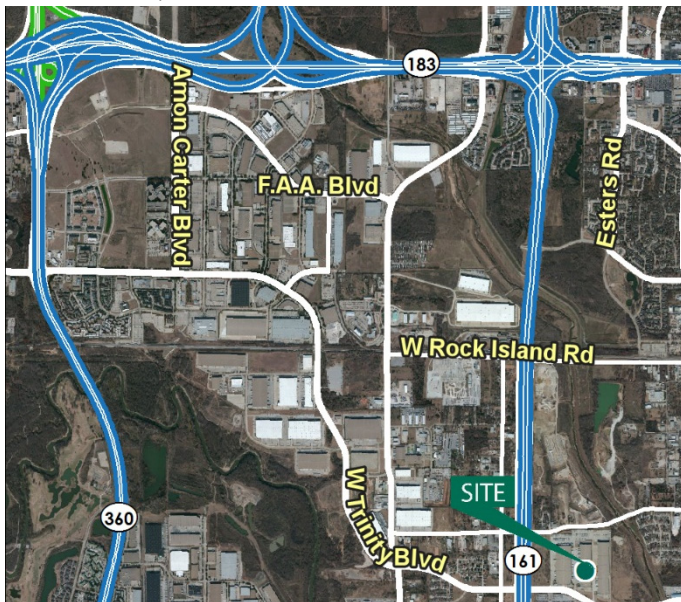

### LOCATION

- In the heart of the North Great Southwest Industrial submarket with easy access to SH 360, I-30 and TX-161

### FACILITY

- 187,100 sf available
- 6,467 sf office total
  - South: 5,567 sf
  - North: 900 sf
- 30' clear height
- 27 overhead dock doors with levelers
- 1 overhead door with ramp
- 235' shared truck court
- ESFR sprinkler system

### ADVANTAGES AND AMENITIES

- End cap space
- Front load configuration

# 187,100 SF

## Industrial Space For Lease

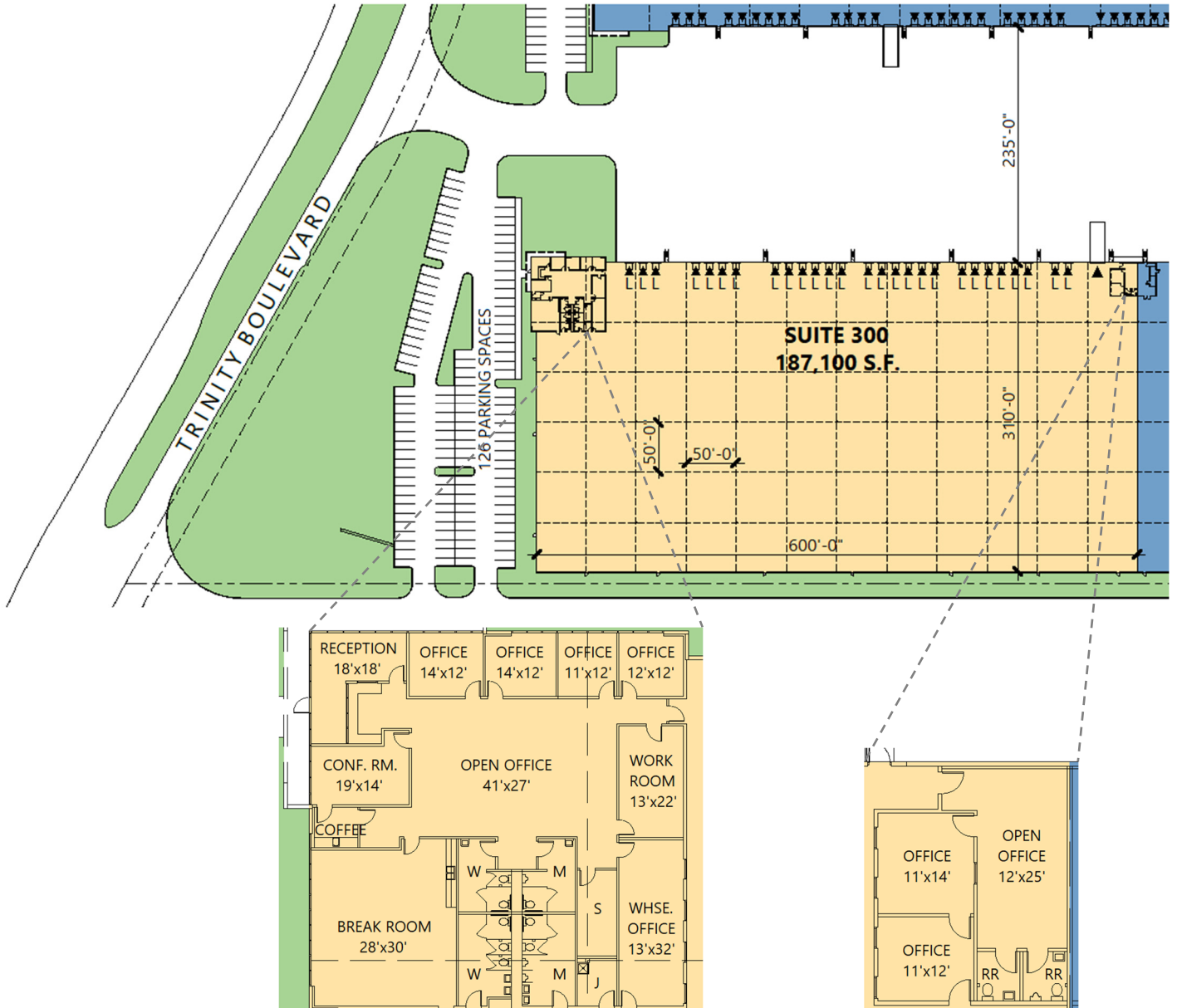

### Prologis

Ryan McNaughton

rmcnaughton@prologis.com

ph +1 972 884 9218

cell +1 214 673 9489

2021 McKinney Avenue

Suite 1050

Dallas, TX 75201 USA

