

17,600 SF

**10913 NW 30th Street
Doral, FL 33172**

Prologis Beacon Industrial Park 3

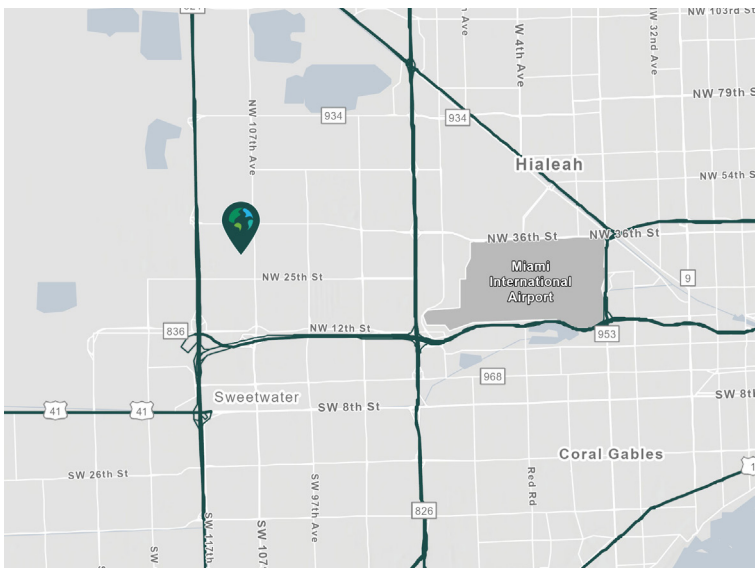

- Easy access to Miami International Airport and PortMiami
- Direct access to SR 836 (Dolphin Expressway), with easy access to SR 826 (Palmetto Expressway) and Florida's Turnpike.

Property Features

Available Space	17,600 SF
Office SF	5,353 SF
Clear Height	24'
Column Spacing	40' x 32'
Dock Doors	6
Drive-in Doors	1
Car Parking	1.22/1,000
Truck Court	150' shared truck court
Loading	Rear loading
Available	August 2026



Unlock the full potential of your warehouse with one strategic, single-source partner.

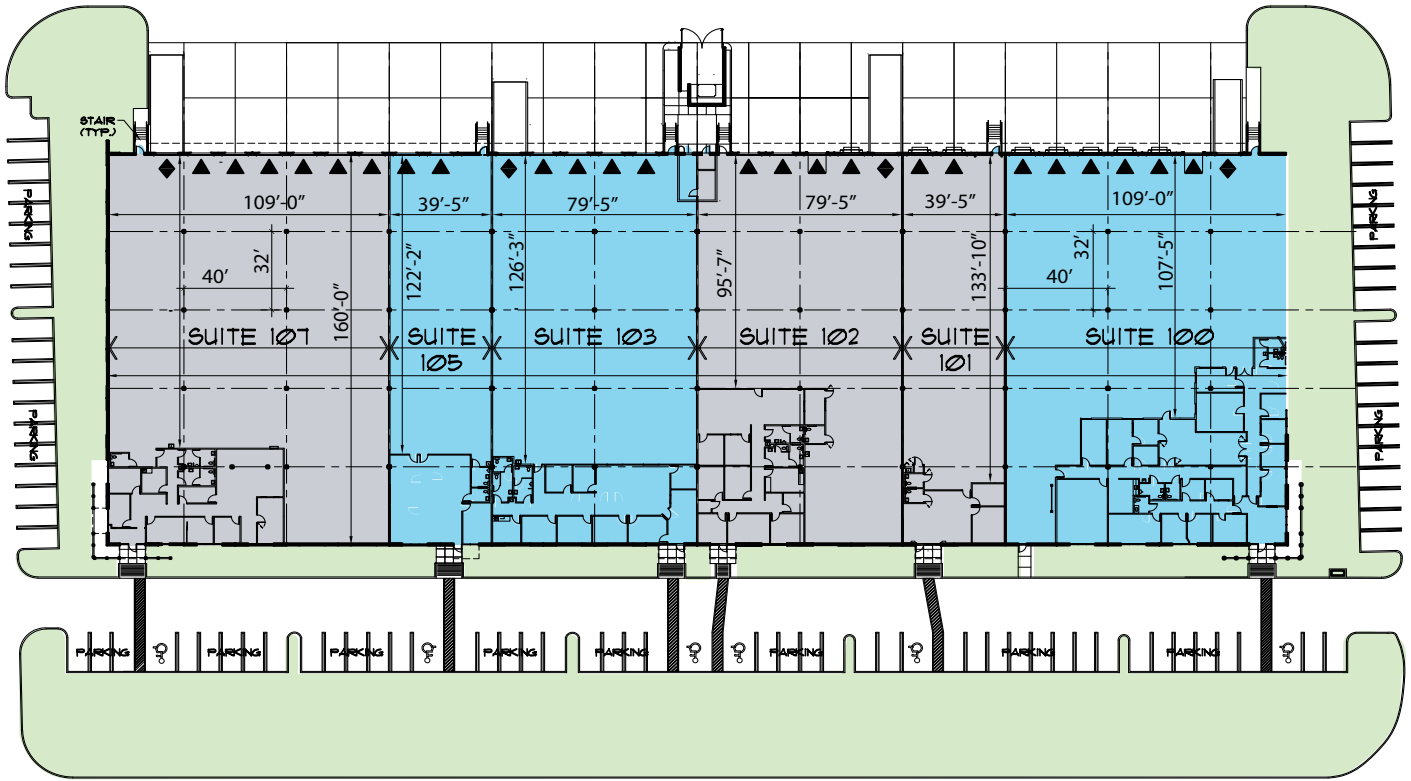

- AVAILABLE
- LEASED
- BACKGROUND LAND
- DOCK DOOR
- DRIVE-IN DOOR



CBRE

CBRE
David Albert
 david.albert@cbre.com
 ph +1 305 519 4401

CBRE
Mateo Coman
 mateo.coman@cbre.com
 ph +1 810 626 8613

Prologis
Diana T. Escobar
 descobar@prologis.com
 ph +1 786 960 2121
 prologis.com