

17,600 SF

Industrial Space For Lease



Prologis Beacon Industrial Park 3



10913 NW 30th Street
Doral, FL 33172 USA

LOCATION

- Easy access to Miami International Airport and Port Miami
- Direct access to 836 (Dolphin Expressway), with easy access to 826 (Palmetto Expressway), and Florida's Turnpike
- Corner unit

FACILITY

- ±17,600 SF available; inclusive of ±2,531 SF of office
- 24' Clear height
- 7 Dock high doors; inclusive of 1 ramp
- Column spacing 40' X 32' / Building depth 160'-0"
- Rear loading
- Shared truck court
- Truck court depth 150'-0"
- Parking ratio 1/1,000
- Available May 2024

ADVANTAGES AND AMENITIES

- Beacon Industrial Park is a premier business park located within the Airport West / Doral submarket.
- Nearby amenities include numerous restaurants, hotels, banks and shopping centers.
- Prologis Clear Lease® – Know your lease expenses and capital cost with greater certainty before your sign.

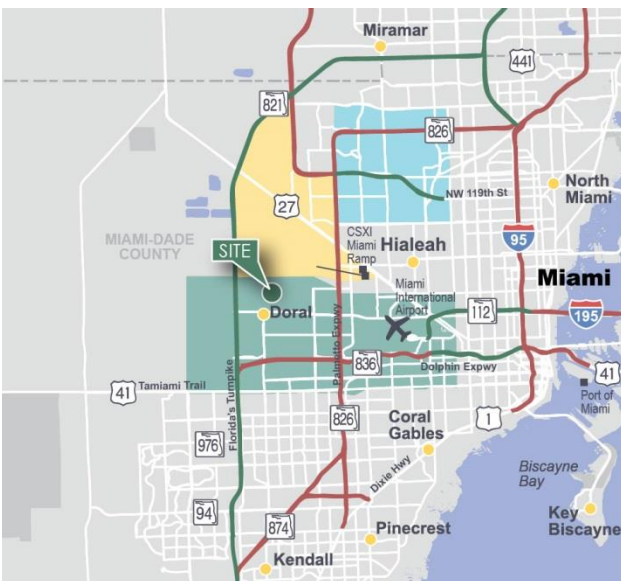

Scan the QR code for more info!

Your single-source service for efficient move-in and operations: [prologisessentials.com](https://www.prologisessentials.com)

17,600 SF

Industrial Space For Lease



Prologis Beacon Industrial Park 3

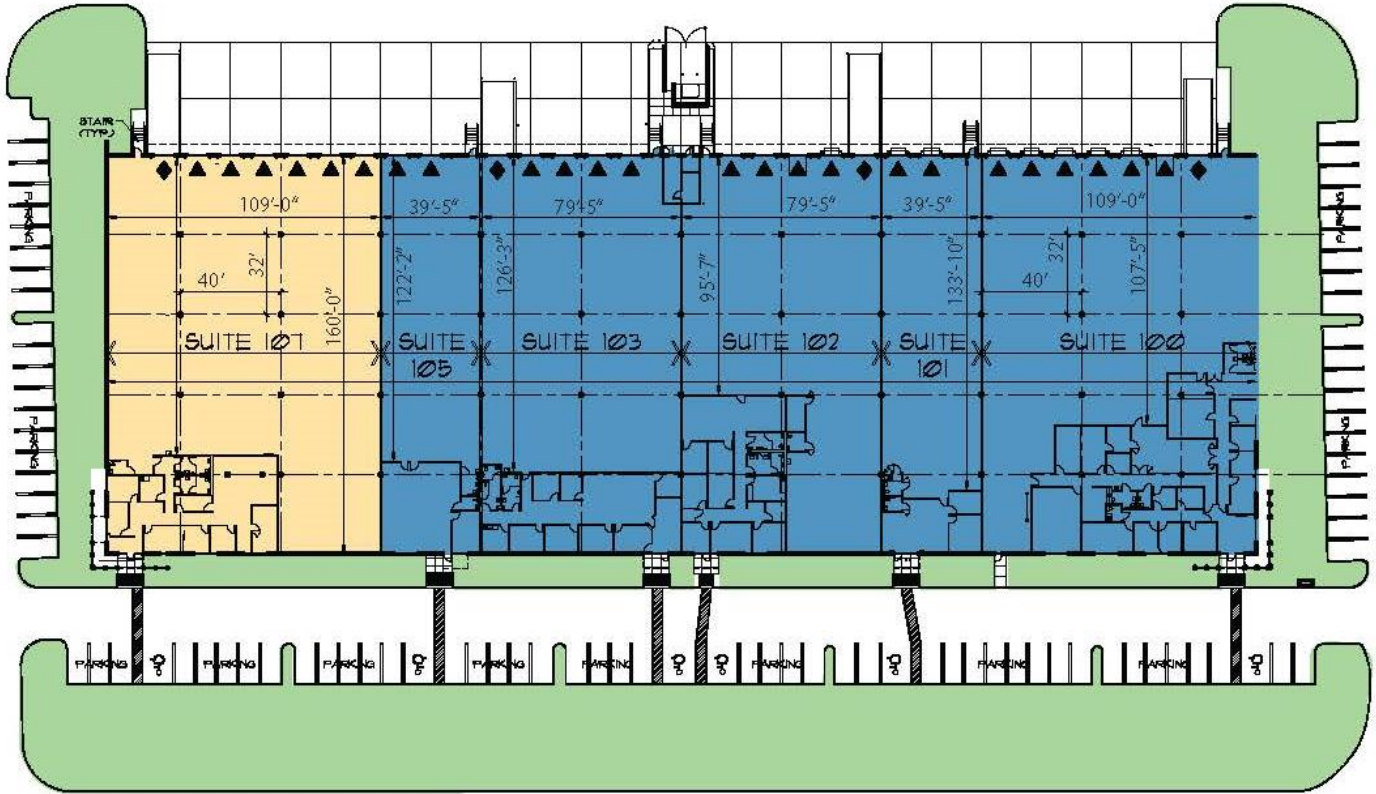

- AVAILABLE
- LEASED
- BACKGROUND LAND
- ▲ DOCK DOOR
- ▲ DRIVE-IN DOOR



State Street Realty

George Pino, SIOR
gpino@statestreetre.com
ph +1 305 447 3390
cell +1 786 402 7387
8319 NW 12 Street
Doral, FL 33126 USA

State Street Realty

Brian Cabiellas, SIOR
bcabiellas@statestreetre.com
ph +1 305 447 3390
cell +1 305 606 7109
8319 NW 12 Street
Doral, FL 33126 USA

Prologis

Barbara Mantecon
bmantecon@prologis.com
ph +1 954 316 1777
8355 NW 12 Street
Doral, FL 33126 USA