

# 25,000 SF

Industrial Space For Lease



## Prologis Vernon Distribution Center



4515 Loma Vista Avenue  
Vernon, CA 90058 USA

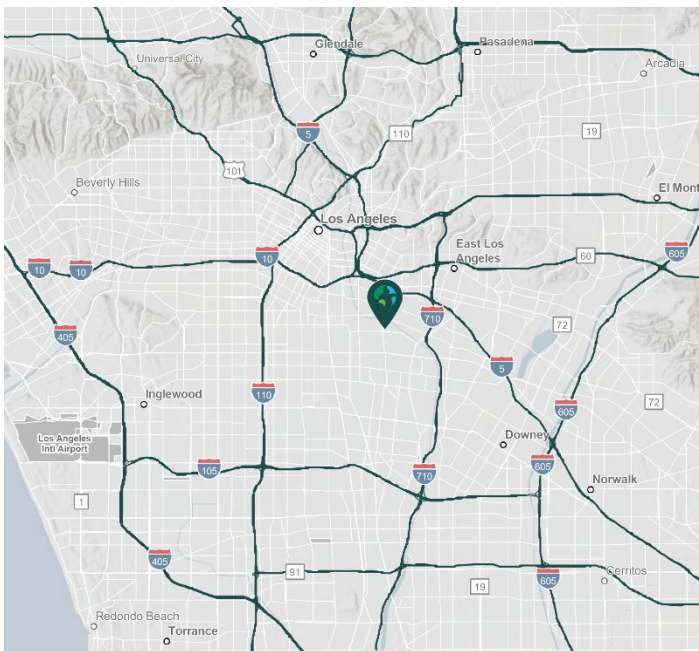

### LOCATION

- Centrally Located in Vernon
- Corner Location

### FACILITY

- 25,000 SF Free Standing Building
- 25,000 SF Available
- Large Fenced and Secured Yard
- 1,800 SF Office
- 7 Dock High Positions
- 16' Clearance
- .36/2000 Sprinkler System
- 400 Amps, 277/480 Volts
- 25 Car Parking Stalls (more possible)
- Excess Trailer Storage Possible

### ADVANTAGES AND AMENITIES

- Facility Completely Refurbished
- Excellent Access to Major Freeways (5, 10, & 710) and Downtown Los Angeles
- Approximately 22 Miles to Ports of Los Angeles & Long Beach
- Access to the Prologis Essentials platform, which includes:

[Operations Essentials](#)

[Energy Essentials](#)

[Workforce Essentials](#)

[Mobility Essentials](#)

[Digital Essentials](#)

Your single-source service for efficient move-in and operations: [prologisessentials.com](https://www.prologisessentials.com)

www.prologis.com  
CalDRE License #01944561

# 25,000 SF

Industrial Space For Lease



## Prologis Vernon Distribution Center

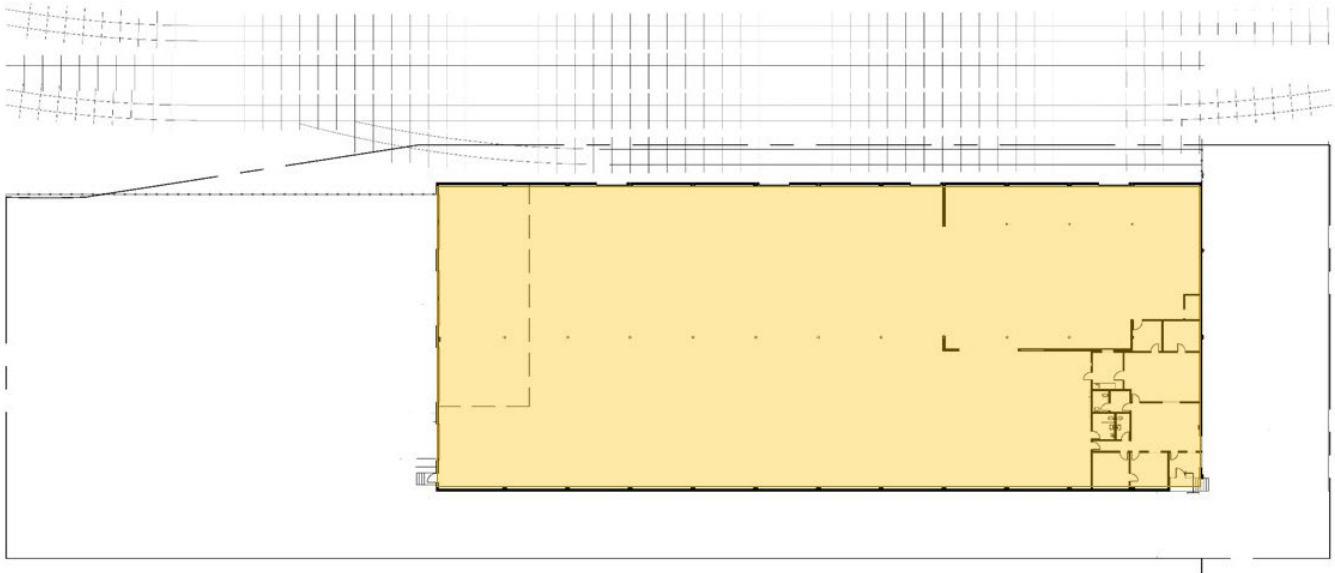

NOT TO SCALE

**LEGEND:**



## NEWMARK

**Newmark**

John McMillan  
john.mcmillan@nrmk.com  
CalDRE License #01103292  
ph +1 310 491 2048  
2301 Rosecrans Avenue  
Suite 4100  
El Segundo, CA 90245 USA

**Newmark**

Jeff Sanita  
jeff.sanita@nrmk.com  
CalDRE License #01242202  
ph +1 310 491 2003  
2301 Rosecrans Avenue  
Suite 4100  
El Segundo, CA 90245 USA

**Newmark**

Andrew Conroy  
andrew.conroy@nrmk.com  
CalDRE License #02143325  
ph +1 310 491 2085  
2301 Rosecrans Avenue  
Suite 4100  
El Segundo, CA 90245 USA

**Prologis**

Analise Guttman  
aguttman@prologis.com  
CalDRE License #01966053  
ph +1 562 345 9239  
2141 Rosecrans Avenue  
Suite 1151  
El Segundo, CA 90245 USA