

# 104,414 SF & 36,566 SF

Industrial Space For Lease



## Prologis Park SeaTac 4



21402 24th Ave S, Suite A & E  
Des Moines, WA USA

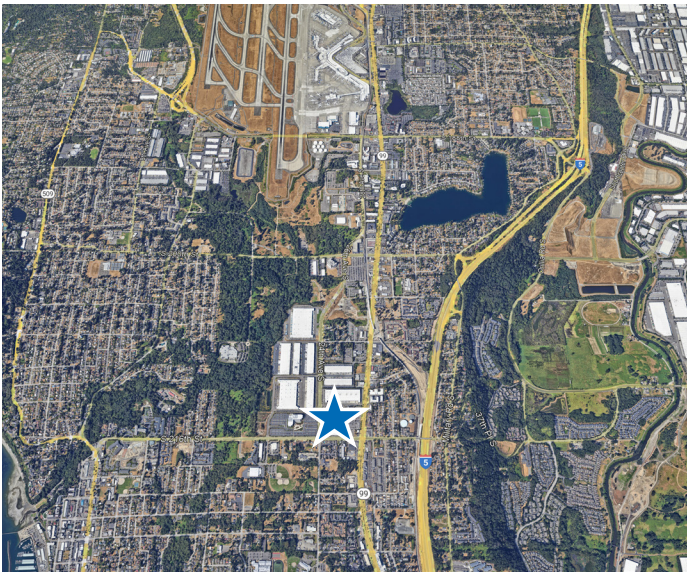

### LOCATION

- Access to I-5

### FACILITY

- Building SF:
  - Suite E - 36,566 SF (1,229 SF Office)
  - Suite A - 104,414 SF (2,814 SF Office)
  - Suite A & E - 140,980 SF (4,043 SF Office)
- Loading:
  - Suite E - 6 Dock High Doors
  - Suite A - 14 Dock High Doors & 1 Grade Level Door
  - Suite A & E - 20 Dock High Doors & 1 Grade Level Door
- Clear Height: 36'
- Lighting: LED Lights
- Available: Suite E - 1/1/2024 | Suite A - 12/1/2023
- Power: Suite E - 225 amps 3-phase | Suite A - 400 amps 3-phase

### ADVANTAGES AND AMENITIES

- Access to the Prologis Essentials platform, which includes:

[Operations Essentials](#)

[Energy Essentials](#)

[Workforce Essentials](#)

[Mobility Essentials](#)

[Digital Essentials](#)

**Your single-source service for efficient move-in and operations: [prologisessentials.com](https://prologisessentials.com)**

# 104,414 SF & 36,566 SF

Industrial Space For Lease



## Prologis Park SeaTac 4

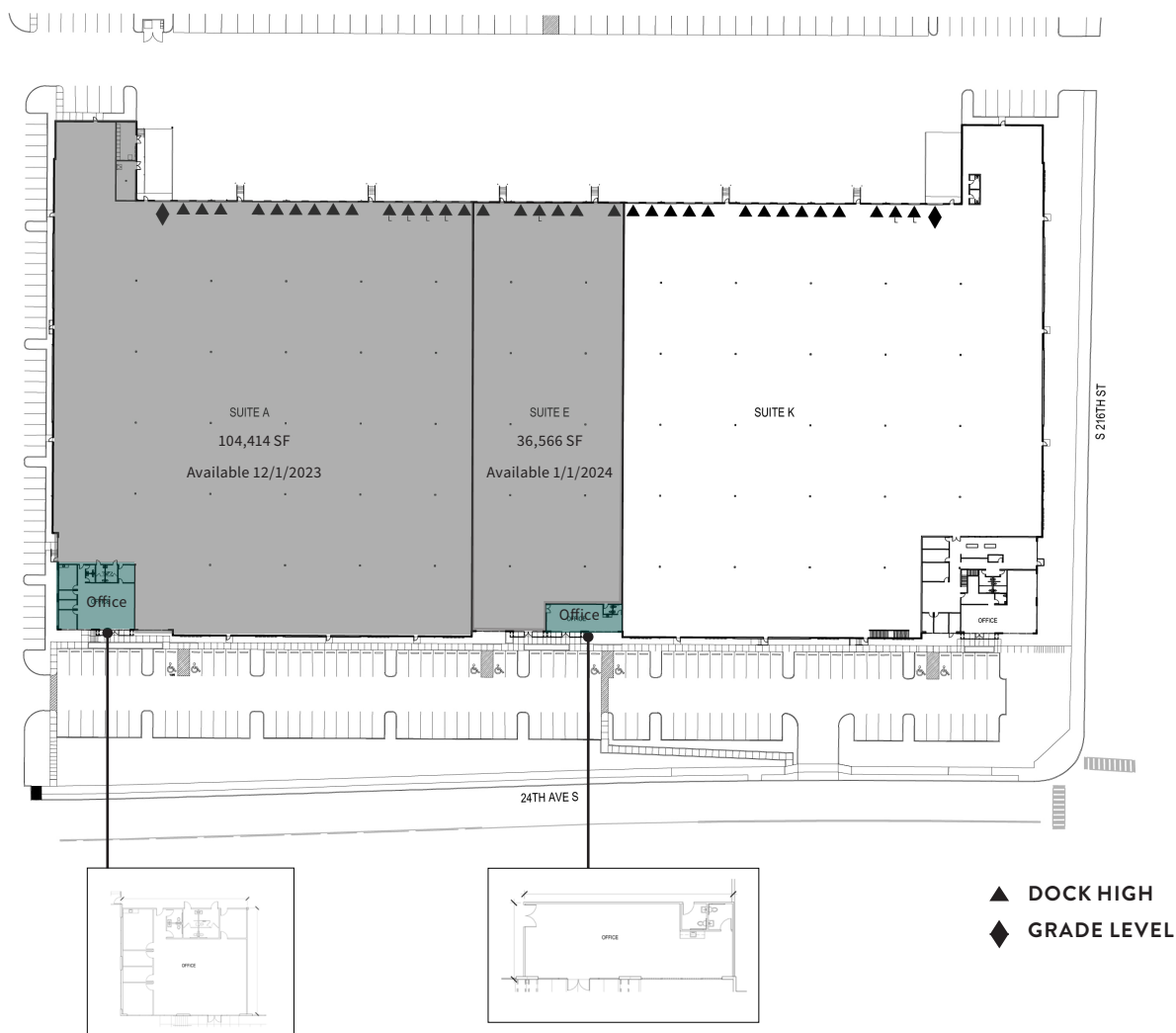

## NEWMARK

**Newmark**  
Taylor Hoff, SIOR  
taylor.hoff@nrmk.com  
ph 425 362 1388  
10900 NE 4th St  
Suite 1430  
Bellevue, WA 98004

**Newmark**  
Thad Mallory, SIOR  
thad.mallory@nrmk.com  
ph 425 362 1410  
10900 NE 4th St  
Suite 1430  
Bellevue, WA 98004

**Newmark**  
Cam Warren  
cam.warren@nrmk.com  
ph 425 362 1395  
10900 NE 4th St  
Suite 1430  
Bellevue, WA 98004

**Prologis**  
Lucca Merlino  
lmerlino@prologis.com  
ph 206 414 7621  
33930 Weyerhaeuser Way S  
Suite 100  
Federal Way, WA 98001