

# 46,204 SF

## Industrial Space For Lease



## Prologis Schiller Park

4136 United Parkway  
Schiller Park, IL 60176 USA



### LOCATION

- Close proximity to O'Hare International Airport and the City of Chicago
- Excellent access to I-294, I-290 and I-90
- 19 miles to downtown Chicago

### FACILITY

- 101,707 SF building
- 46,204 SF available
- 3,800 SF office
- 22' clear height
- 6 interior docks
- 2 drive in doors
- 33' x 36'4" column spacing
- Power - 1200 amps and 277/480 volts
- 100 car parking stalls (entire building)

### ADVANTAGES AND AMENITIES

- Institutionally owned and managed
- Easily accessible to strong labor pool and public transportation

# 46,204 SF

## Industrial Space For Lease

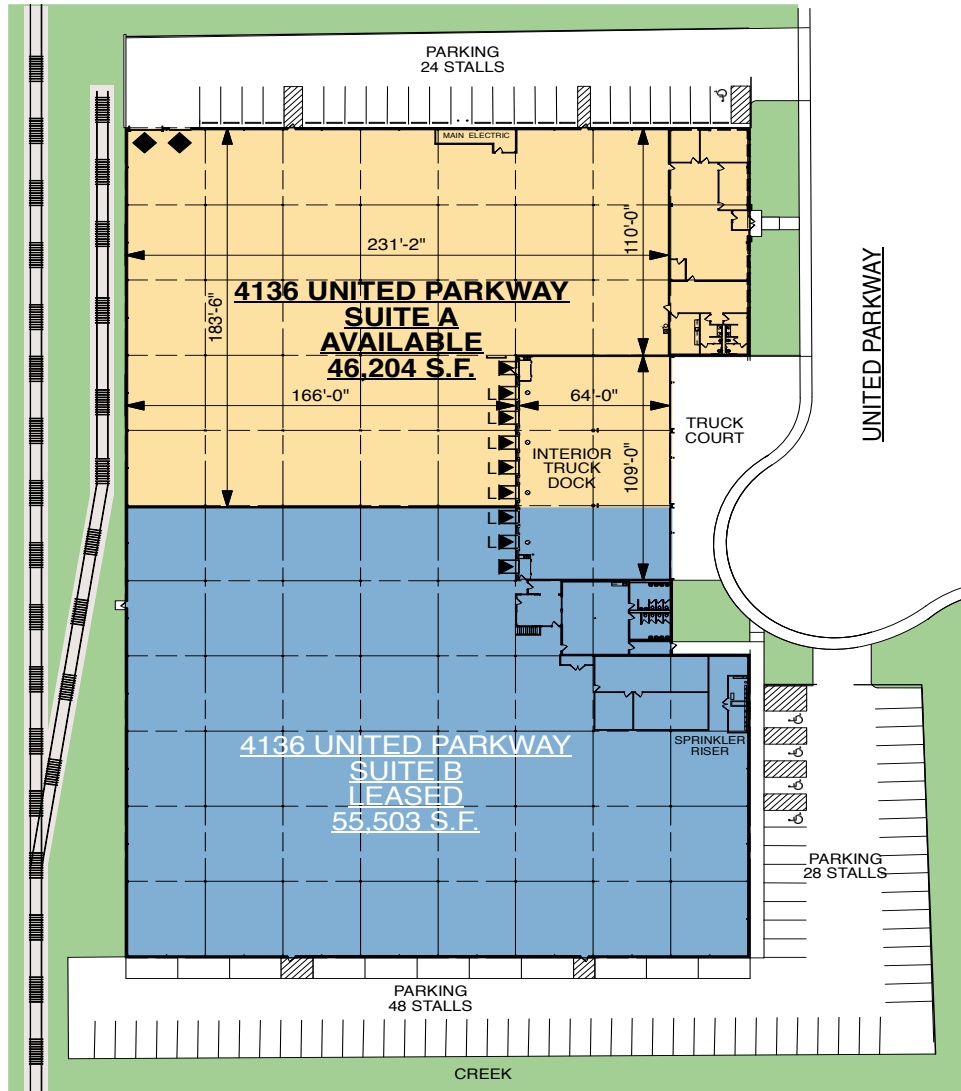

### Cushman & Wakefield

**Matt Cowie**

matt.cowie@cushwake.com  
ph +1 312 470 1872  
cell +1 312 735 6510  
225 W Wacker Drive  
Suite 3000  
Chicago, IL 60606 USA

### Cushman & Wakefield

**Colin Green**

colin.green@cushwake.com  
ph +1 312 470 2322  
cell +1 630 272 9968  
225 W Wacker Drive  
Suite 3000  
Chicago, IL 60606 USA

### Cushman & Wakefield

**Larry Goldwasser, SIOR**

larry.goldwasser@cushwake.com  
ph +1 312 470 2323  
cell +1 312 953 5744  
225 W Wacker Drive  
Suite 3000  
Chicago, IL 60606 USA

### Prologis

**Maggie Tullier**

mtullier@prologis.com  
ph +1 847 292 3943  
cell +1 847 420 4145  
6250 N River Road  
Suite 1100  
Rosemont, IL 60018 USA